

INSTALLATION INSTRUCTIONS

OVAL SHOWER CURTAIN RING LDA010

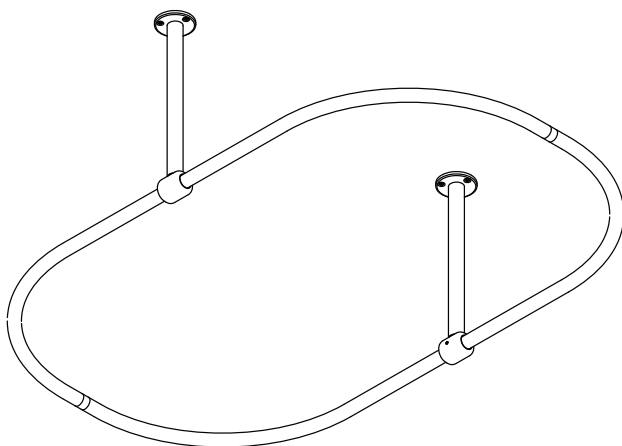

IMPORTANT!

Please read these instructions **prior** to installation

Distributed by:

Plumbline

T 04 568 9898 E sales@plumblin.co.nz
www.plumblin.co.nz

INSTALLATION INSTRUCTIONS

OVAL SHOWER CURTAIN RING | LDA010

1

Insert the railing connections into the curved pipes only for one side as shown in figure. Be sure the holes into the long side connections are oriented to the inner side of the railing

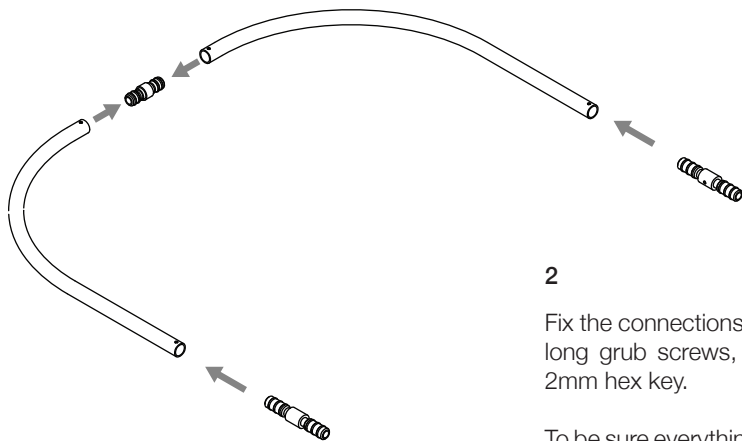

2

Fix the connections using the provided 4mm long grub screws, and fasten them with a 2mm hex key.

To be sure everything is aligned, lay down the assembly on a flat surface before fastening the screws.

Always put a protection layer on the surface in order to avoid scratching the product's surface.

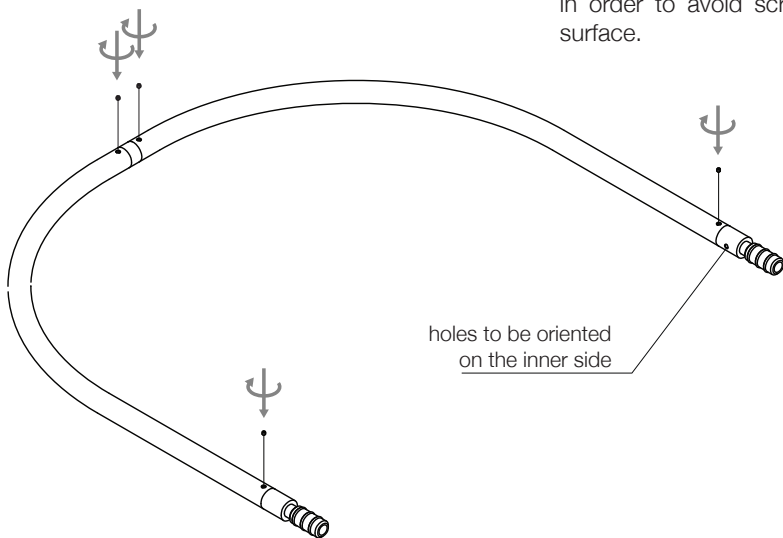

3

Slide the "T" connection so you can see the previously fastened grub screw from the upper hole.

Repeat this operation also for the opposite side.

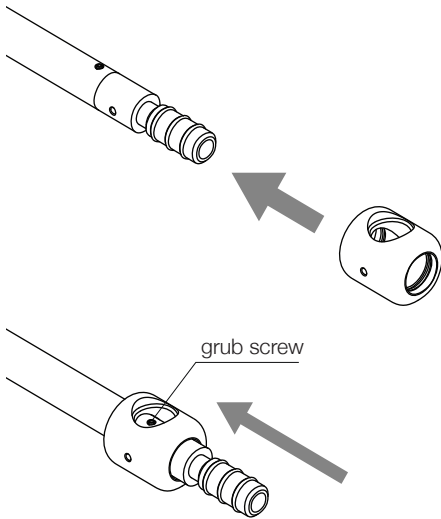

4

Insert the remaining connections into the other two curved tubes, and fix them using the provided 4mm long grub screws. Fasten them with a 2mm hex key.

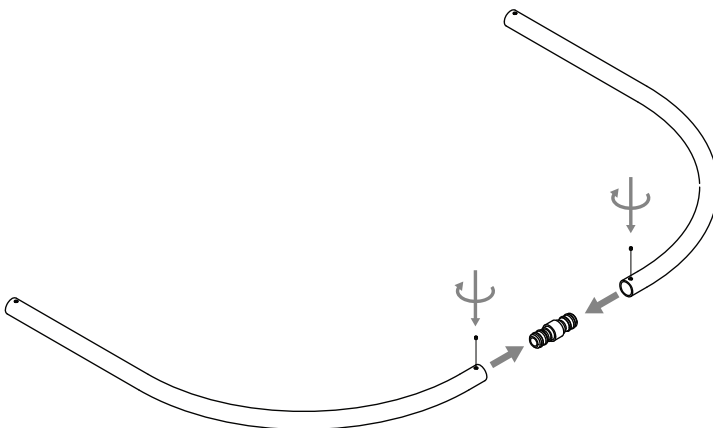

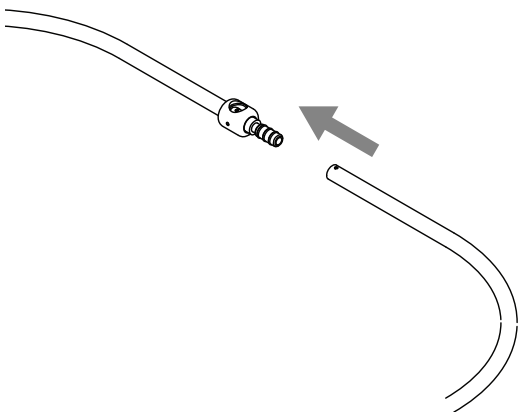

5

Slide the assembly on the other half of the railing on the connections on both sides.

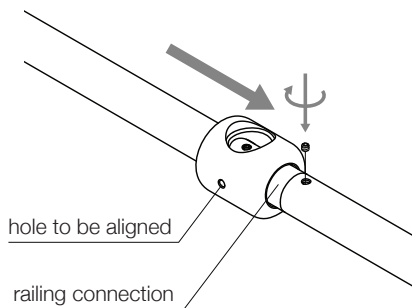

6

Fix the pipe to the connections using the provided 4mm long grub screws, and fasten them with a 2mm hex key.

Then slide back the "T" connection in order to align the hole to the one on the railing connection.

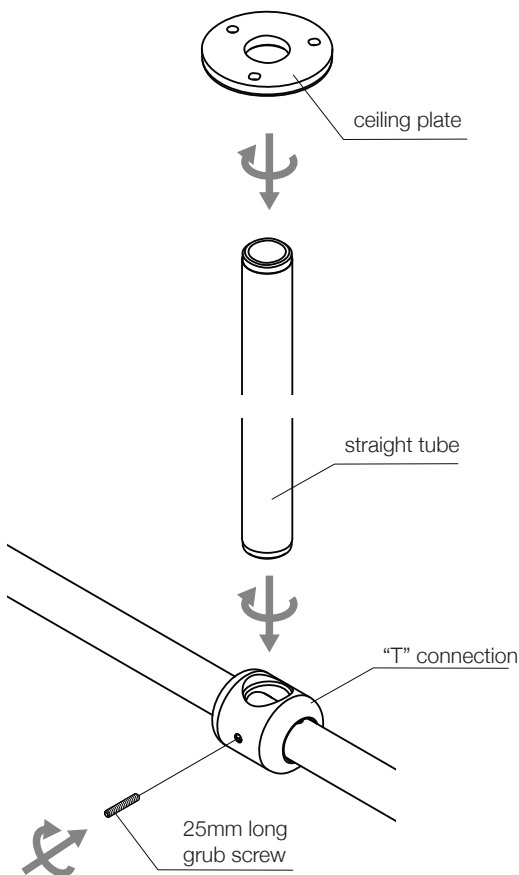

7

Fix the "T" connection to the railing using the provided 25mm long grub screw with a 2mm hex key, be sure the screw is inserted all the way in to the railing connection.

Screw the straight tube into the "T" connection and fix it by hand, then screw the ceiling plate on the straight tube and fix it by hand as well.

Do the same on the opposite side.

8

Put the assembled rail against the ceiling and, using the holes in the plates as a template, mark the holes to be drilled.

To determine the holes diameter, check the provided plastic plugs

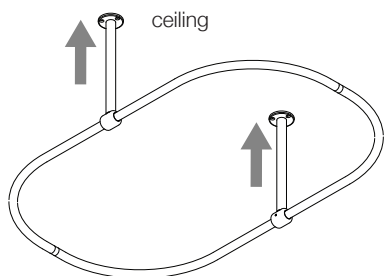

ATTENTION

Two operators are required to avoid damages.

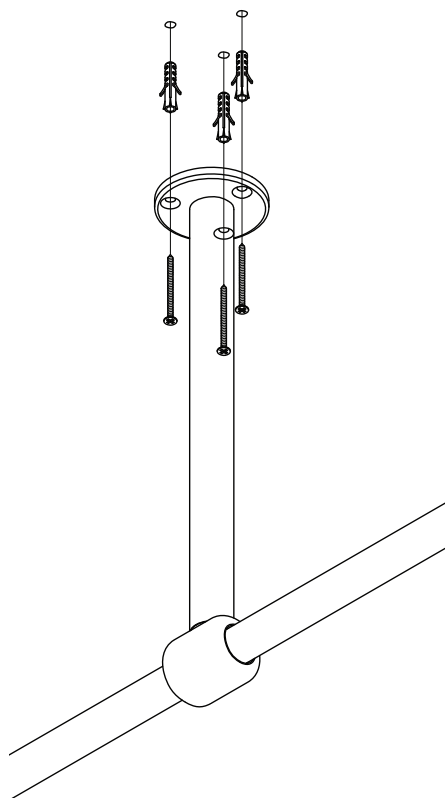

9

Insert the provided plastic plugs into the previously drilled holes and fix the railing using the provided screws (3 for each side)

Repeat this operation for the opposite side.

