

INSTALLATION INSTRUCTIONS

PLY25 VANITIES, MIRROR CABINETS & WALL TOWERS

progetto
DESIGN COLLECTION

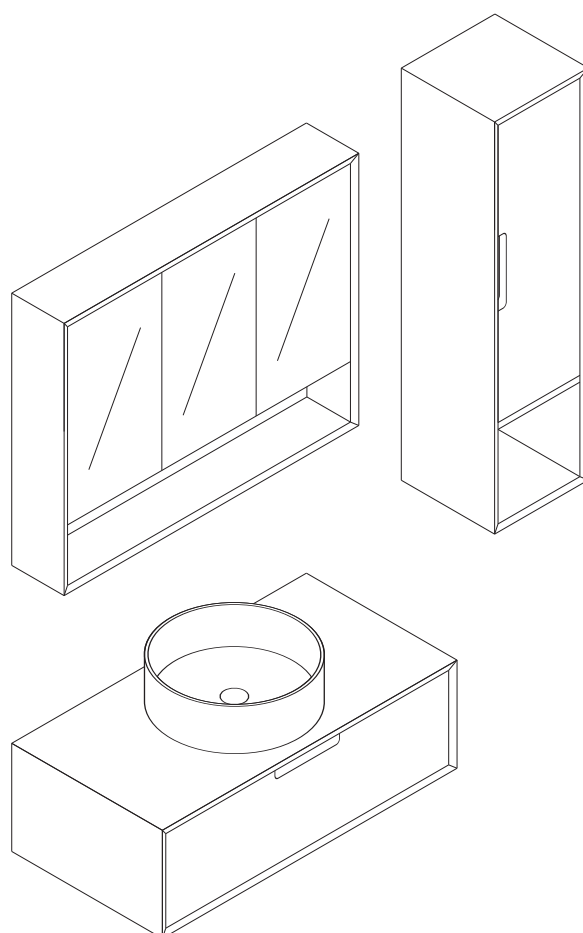

IMPORTANT!

Please read these instructions **prior** to installation

Distributed by:

Plumbline

T 04 568 9898 E sales@plumblin.co.nz
www.plumblin.co.nz

Progetto Bathroom Furniture products are manufactured from the finest materials and when treated with care will last many years.

Vanity Tops/Basins

Vanity tops must not be subjected to water temperatures above the recommended safety level of 55° Celsius. Clean your vanity top with a damp cloth and a non-abrasive liquid cleaner. Stubborn stains and scratches can be removed with a light application of Brasso or a similar cutting compound. Avoid abrasive cleaners, solvents, heat and sharp objects. The use of cleaners incorporating ingredients which have been identified as harmful effects on acrylic will void the warranty.

Vanity Cabinets

Materials used are water resistant but not waterproof. To ensure the long life of the cabinet, water must not be allowed to remain on the cabinet surfaces. All water spillages, leaks or flooding in or around the cabinet must be sponged off and dried immediately as water damage is not a justifiable claim.

Keep heat away from the cabinet and avoid metal or sharp objects which could scratch and damage the surface.

For gentle cleaning of bathroom furniture we recommend using a soft damp cloth. Stubborn stains can be removed with a mild detergent. Subsequently, wipe with a damp cloth and polish dry. **Abrasive cleaners or solvents/spirits should never be used.**

⚠ Important! It is recommended that a qualified, licensed tradesperson install your unit.

This unit carries a full warranty against faulty workmanship and material. Prior to installation it is important to inspect the unit to ensure no defects or no damage has occurred in transit as the warranty does not cover the cost of removal and installation once installed. The warranty will be null and void if damage occurred after installation.

Vanity Tops/Basins

During the manufacture of tops/basins shrinkage can occur and this can result in the product being slightly uneven. It is recommended that the top/basin be fixed onto the cabinet with silicone applied to the bottom edges of the top/basin. If the top/basin is installed up against the wall then a bead of silicone should be applied between the rear upstand or back edge and the wall. If the top/basin is installed up against the wall do not tile down onto tops/basin, top/basin should be installed onto finished wall covering.

Cabinets

Ensure the wall is straight as a bowed wall will twist the cabinet and distort the door/drawer alignment. Decide the appropriate height for the top of the unit including the basin, normally between 840 and 900mm. Deduct the thickness of the vanity top/basin and this becomes the fixing height to the top of the vanity cabinet. Drill holes for the pipes in rear of unit and base with appropriate size hole saw. Position unit, check cabinet is sitting level and square and fasten to wall. Fastenings should be into solid timber and be within 50mm of each side. Do not tile down onto vanity top or into side of vanity unit, vanity should be installed onto finished wall covering.

A bead of sealant must be used to seal all edges where water penetration may occur between the cabinet and the wall. The warranty will be null and void if damage occurs due to water penetration after installation.

Tools Required For Installation

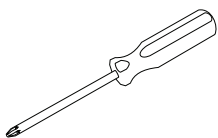

Screwdriver

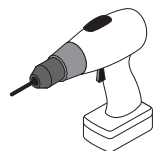

Drill & Drill Bits

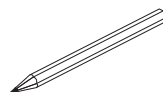

Pencil

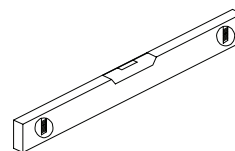

Level

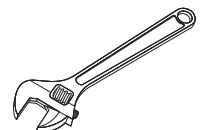

Adjustable Wrench

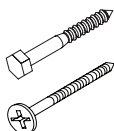

Coach Screws /
Wood Screws

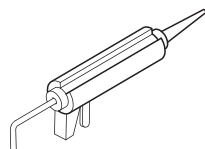

Caulking Gun/Silicone

⚠ Important! Before installing ensure there is sufficient timber framing in the wall to securely fasten your vanity to.

Before starting remove the drawer from the cabinet (refer to the Drawer Adjustment & Removal Instructions section of this document)

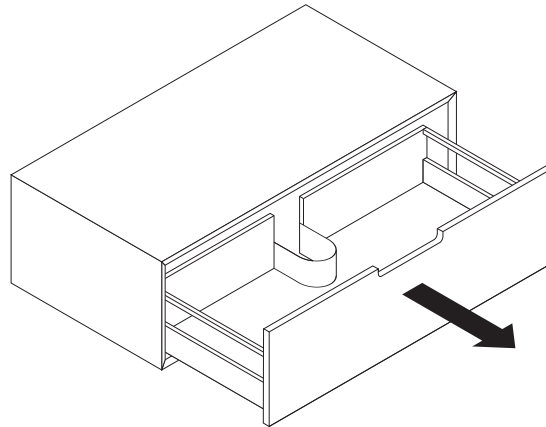
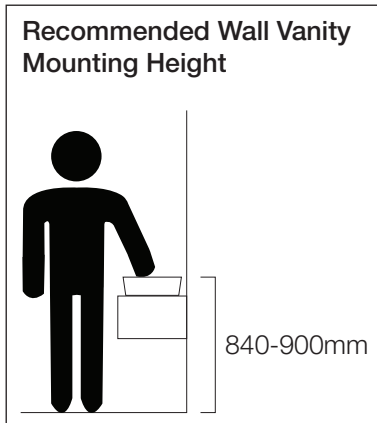

1. Pre-drill holes in the back of the vanity cabinet as follows:
 - Double fixing holes approx. 50mm from each side
 - Fixing in the centre for vanities 750mm to 1200mm

2. Mark your preferred vanity height on the wall (remembering to allow for the vessel basin/vanity top) and fix vanity to the wall using coach screws. Special attention must be made to ensure the vanity cabinet is level.

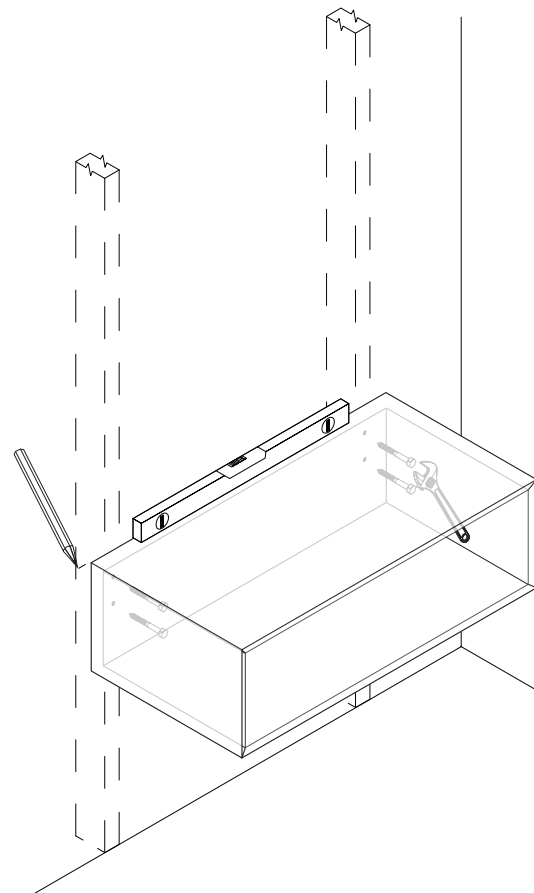
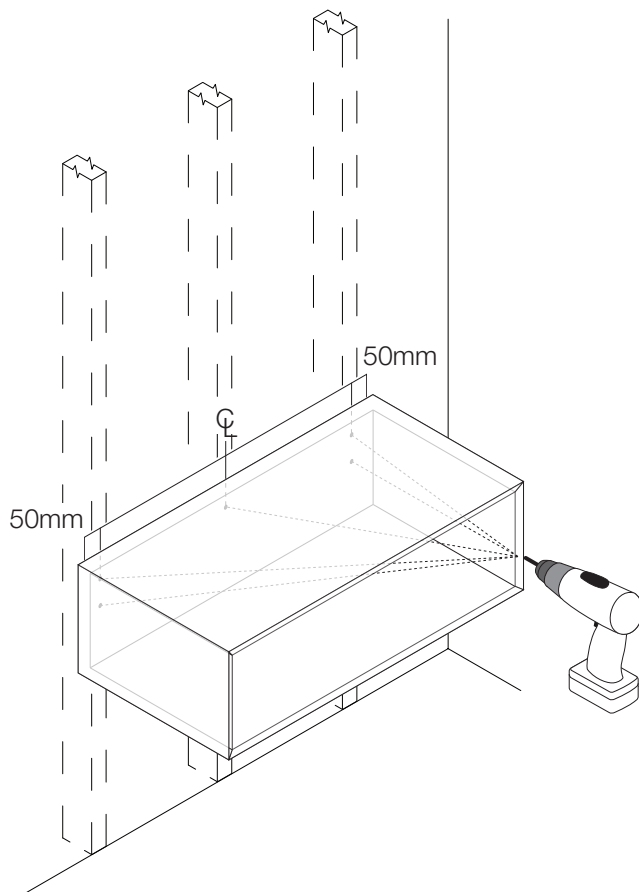

3. Make the necessary holes/cutouts in the vanity top for the basin & waste. Install the basin and re-fit the drawer.

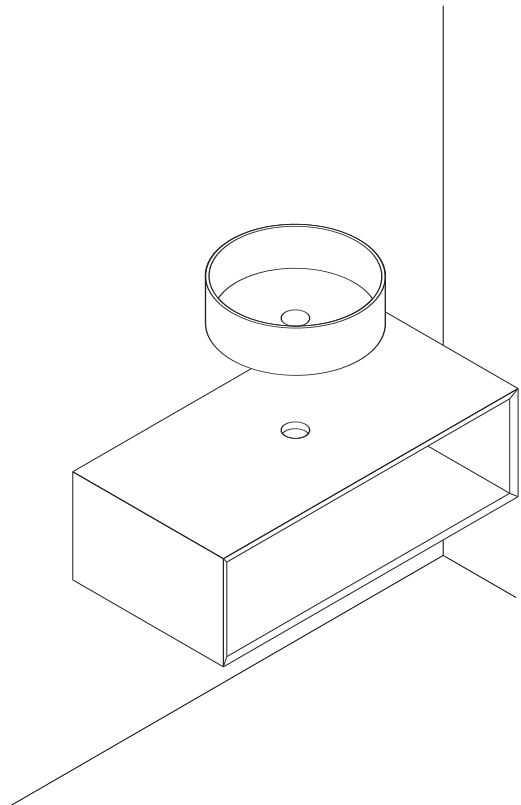

Sealing

⚠ Important! Before use a bead of sealant must be used to seal all edges where water penetration may occur - between cabinet and wall and between cabinet and basin. The warranty will be null and void if damage occurs due to water penetration after installation.

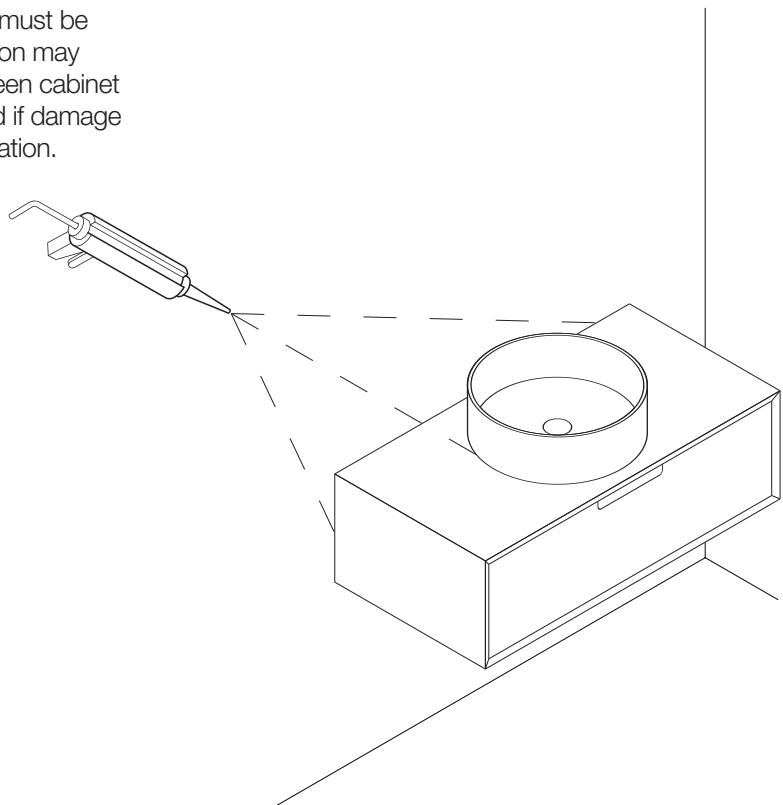

Mirror & Mirror Cabinets

⚠ Important! Before installing ensure there is sufficient timber framing in the wall to securely fasten your cabinet to.

Ply25 Mirrors & Mirror Cabinets hang off a 'french cleat' that is screwed to the wall, see illustration below.

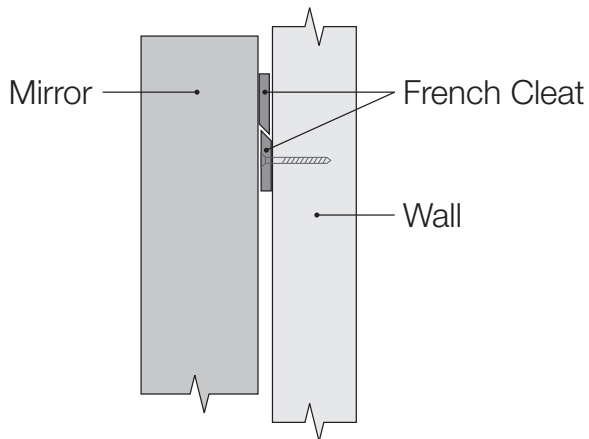

1. Determine the measurement from the top of the mirror/mirror cabinet to the bottom of the wall cleat (measurement X).

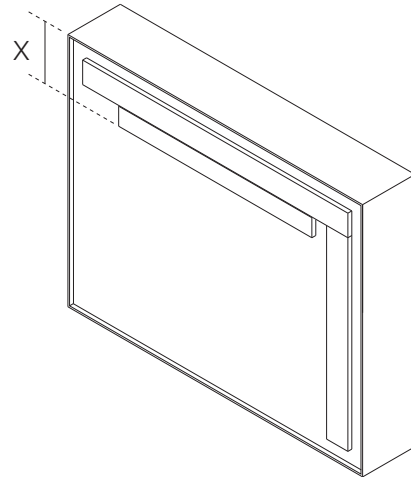

2. Determine your preferred mirror/mirror cabinet height on the wall and mark the position of the wall cleat (measurement X) below the preferred mirror height. Fix the cleat to the wall using 75mm screws. Special attention must be made to ensure the cleat is perfectly level.

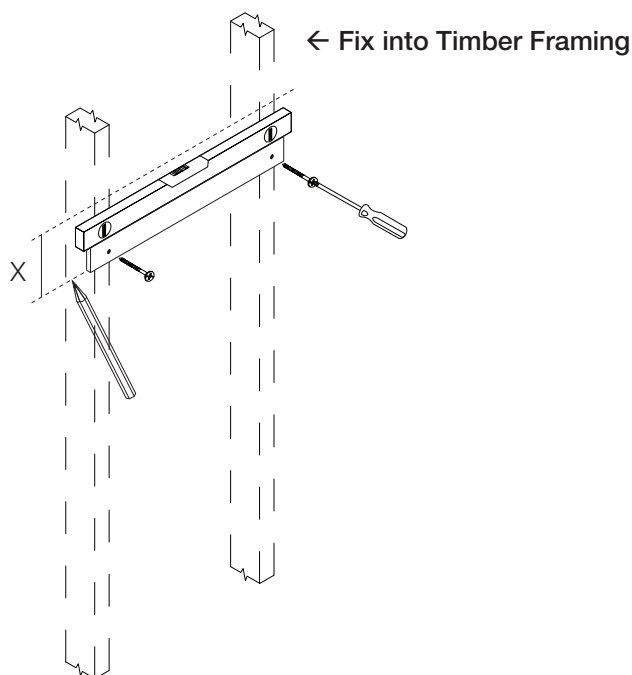

3. Lower the mirror/mirror cabinet onto the cleat. Before the two cleats touch ensure that it is aligned laterally in the correct position.

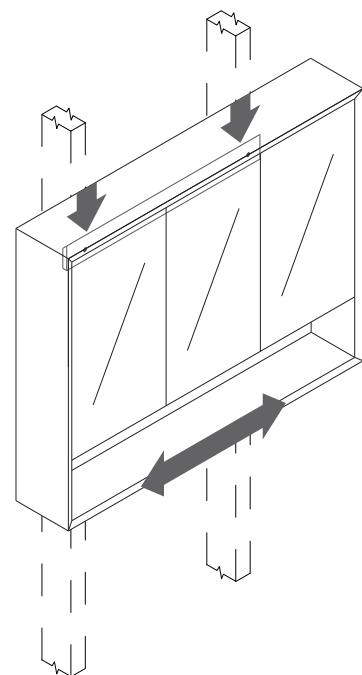

Installing Demister Pads

⚠ Important! Any electrical connections and possible subsequent electric interventions must only be done by a qualified electrician who will operate in accordance with current regulations in terms of electricity.

1. Remove the back panel of the mirror by removing the screws as shown.

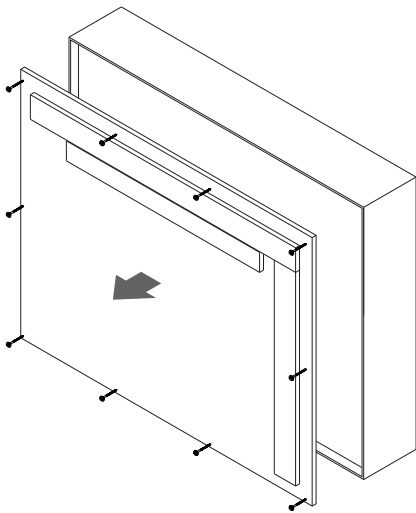

2. Install the demister pad by removing the self adhesive backing from the element, and apply the adhesive side to the centre of the mirror. Using a clean cloth smooth out the element to ensure that it lies flat.

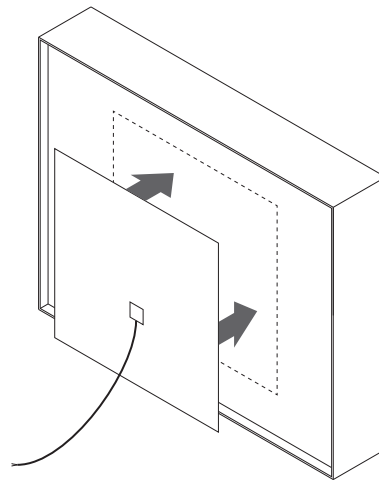

3. Take the back panel and make a hole in the appropriate place for the element junction & power lead. Then screw the back panel into place.

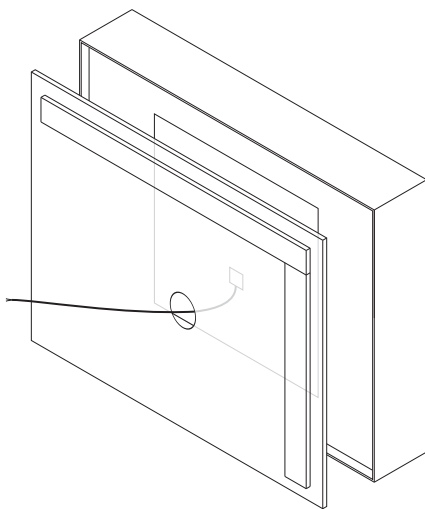

4. Ensure you have a suitable electrical feed* behind the mirror, then connect the electrical feed* to the demister pad lead and place the mirror onto the wall mounted cleat.

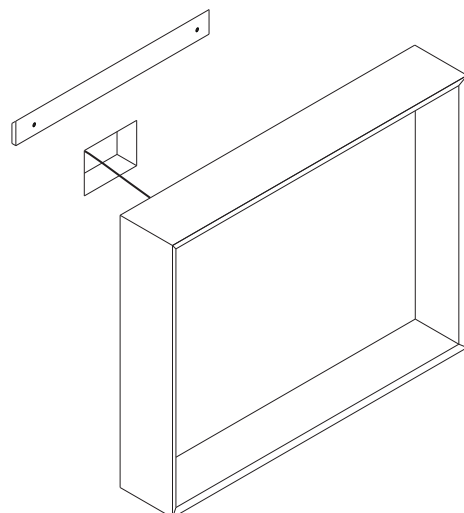

⚠ Important! Before installing ensure there is sufficient timber framing in the wall to securely fasten your wall tower to.

Before starting remove the door from the cabinet (refer to the Door Adjustment & Removal Instructions section of this document)

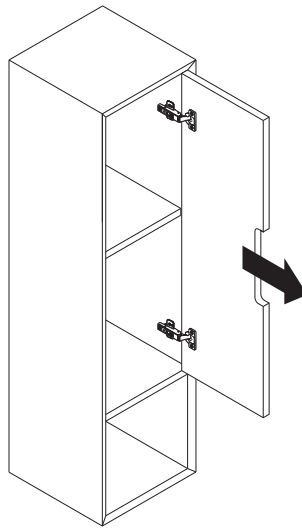

1. Firstly remove the door for ease of installation. Pre-drill 5mm holes as follows in the back of the wall tower. Holes will need to be positioned where there is timber framing.

2. Mark your preferred wall tower height height on the wall and fix the wall tower to the wall using 75mm screws. Special attention must be made to ensure the wall tower is level and straight. Re-fit the door.

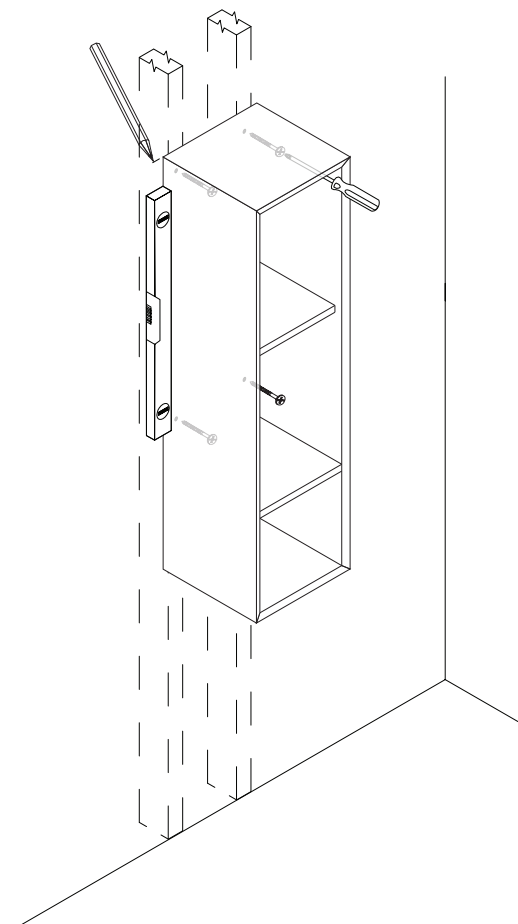
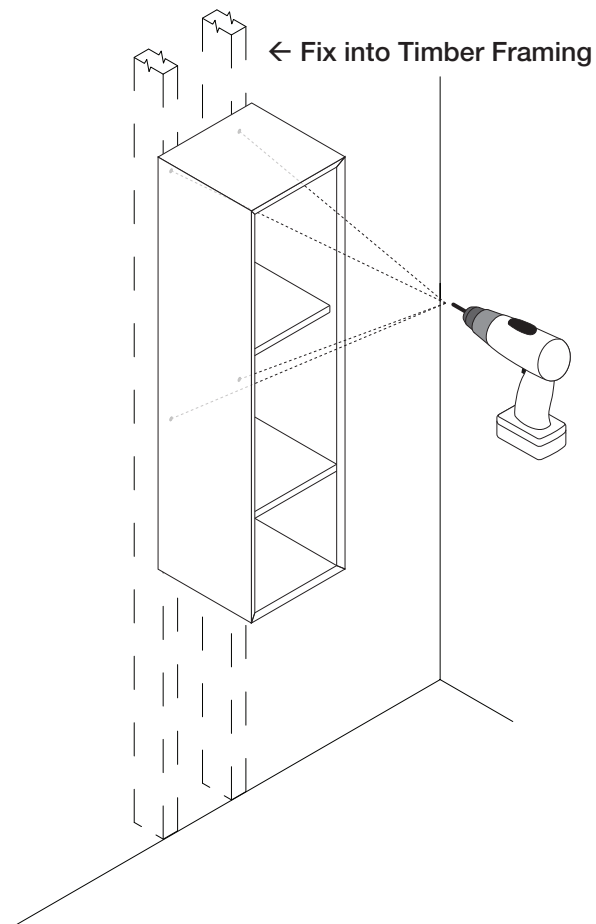

Drawer Adjustment & Removal Instructions

Cabinet drawers will need to be removed prior to the installation of the cabinet. Incorrect removal of the drawer will result in damage to the soft close mechanism.

Drawer Removal

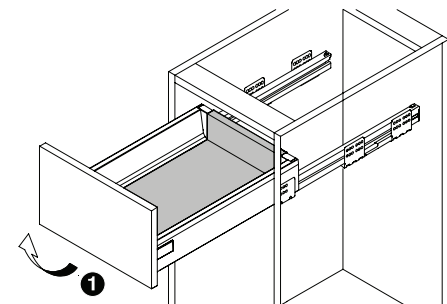

Drawer Installation

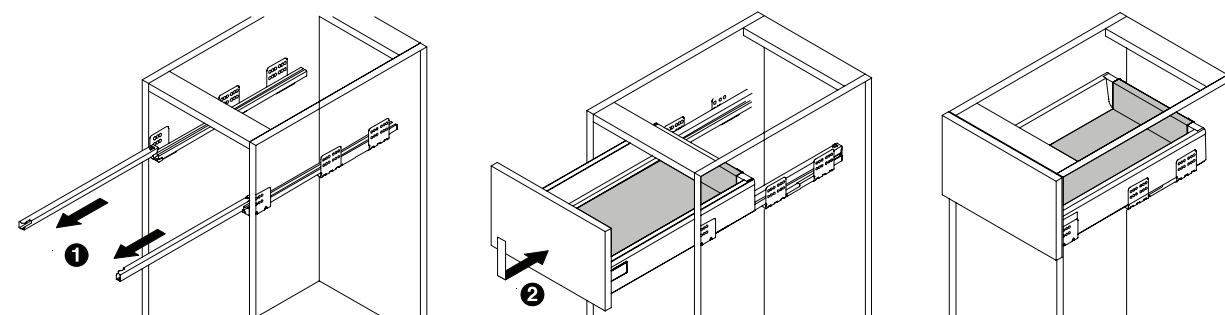

Drawer Adjustment - Horizontal

To right

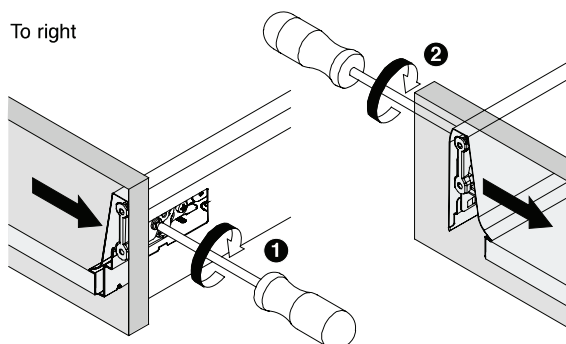

Adjustable by 1.25mm to the right

To left

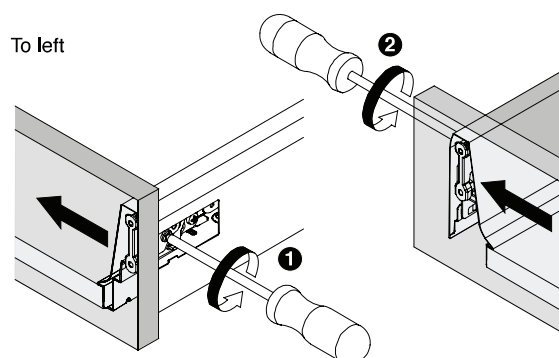

Adjustable by 1.25mm to the left

Drawer Adjustment - Vertical

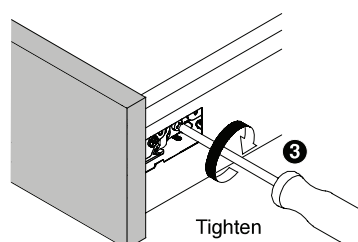
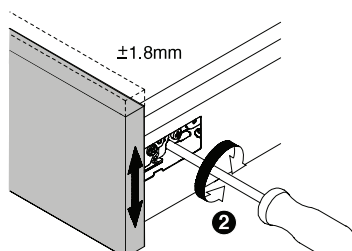
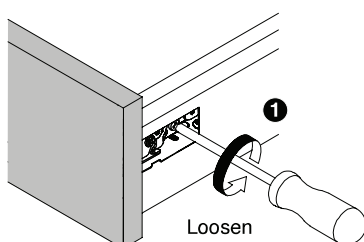

Drawer Adjustment & Removal Instructions

Drawer Adjustment - Tilt

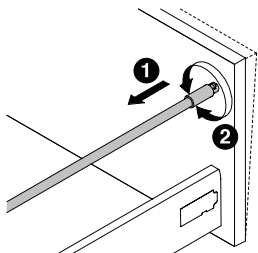

Drawer Front Removal

Screw-on

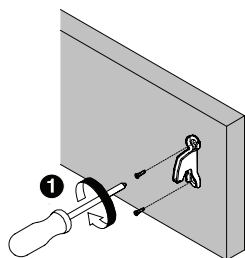

Assembly

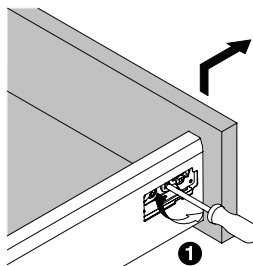
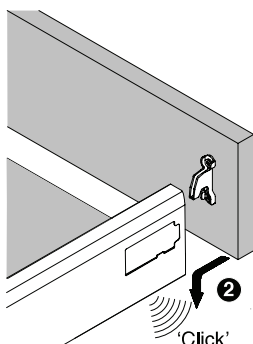

Removal

Door Adjustment & Removal Instructions

Cabinet doors will need to be removed prior to the installation of the cabinet.

Door Removal

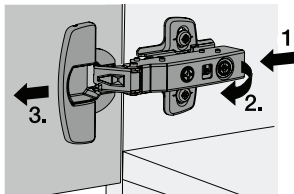

Door Installation

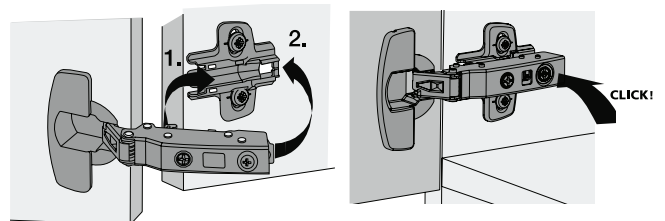

Door Adjustment - Skew

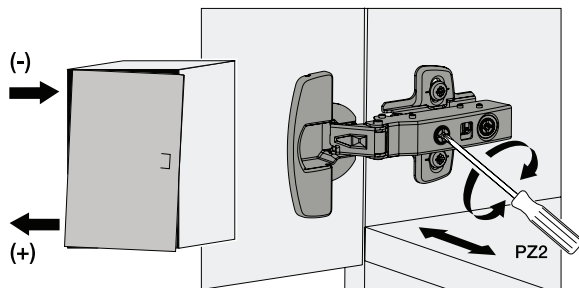

Door Adjustment - Depth

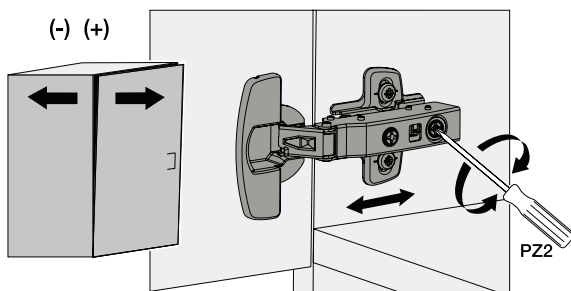

Door Adjustment - Height

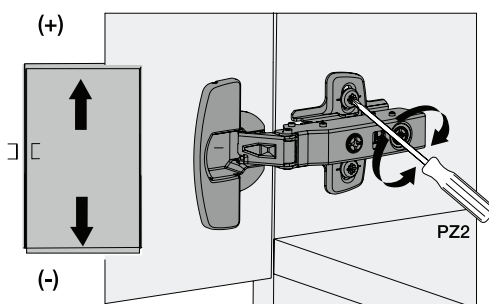

Warranty Information



Progetto Bathroom Furniture products carry a seven (7) year warranty from date of purchase. Proof of purchase needs to be supplied by the purchaser when making a claim.

Plumblin (the NZ distributor for Progetto) warrants that in the manufacture of its products only high quality workmanship and materials have been used. If within the warranty period there should be a fault with either materials or workmanship Plumblin will either (at its sole discretion) repair or replace the faulty product, but will not be responsible for removal and installation costs.

This warranty does not cover damage by improper installation, abuse, accident, excessive wear and tear, improper care and maintenance, natural causes (sunlight and water), water temperatures above 55°C, humidity and over environmental conditions.

IMPORTANT NOTE: Under no circumstances tile vanity cabinets and/or tops 'into' the wall.

Progetto vanity cabinets & tops must be fitted to finished wall coverings. The Warranty does not cover any vanity and/or top that has been tiled 'into' a wall i.e., fitting or fixing a vanity to a wall and tiling into the side and around it, and/or tiling down and/or around the vanity top.

For full details about our warranty visit plumblin.co.nz/warranty-information