

# INSTALLATION INSTRUCTIONS

progetto

MINIMO BASIN MIXER | M002N

MINIMO BASIN MIXER HIGHER BODY | M004N

MINIMO SHOWER MIXER | M033N

MINIMO DIVERTER MIXER | M034N

MINIMO KITCHEN MIXER | M040N

MINIMO BASIN SPOUT | M024N

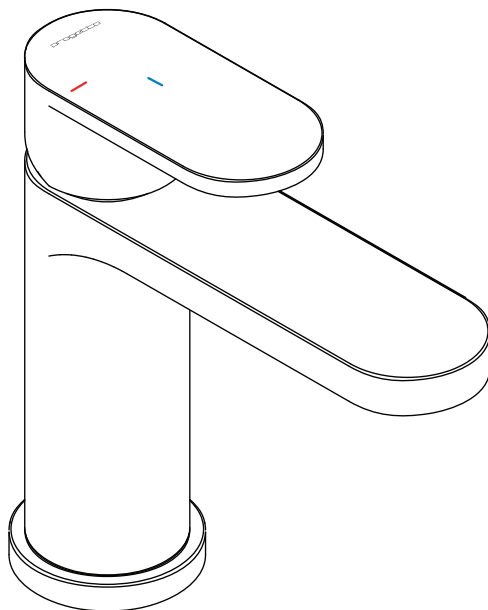

## IMPORTANT!

Please read these instructions **prior** to installation

Distributed by:

**Plumblin**e

T 04 568 9898 E [sales@plumblin.co.nz](mailto:sales@plumblin.co.nz)  
[www.plumblin.co.nz](http://www.plumblin.co.nz)

## RECOMMENDATIONS FOR INSTALLATION

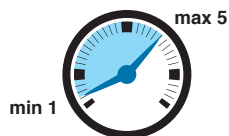

### Water Pressure

1 - 3 bar

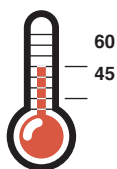
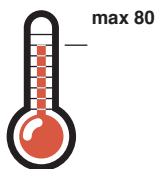

### Water Temperature

45° - 65°C

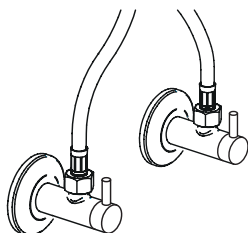

### Stop Taps

Angle valves are recommended



### Pre-Flush

Always flush out the pipework before connecting any tapware.



### ATTENTION

Failure to do so will void the warranty.

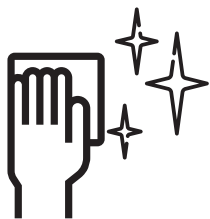

## Cleaning

Clean with warm soapy water and a smooth cloth. Avoid abrasive sponges or detergents as these will damage the finish.

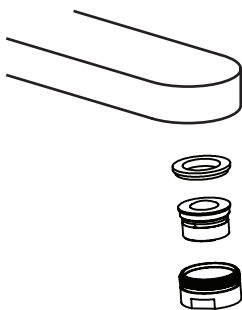

## Aerator Maintenance

Unscrew the aerator with 22mm spanner

immerse for half a day in water-vinegar solution (80-20%)

Wash, then reassemble

# INSTALLATION INSTRUCTIONS

## MINIMO BASIN MIXER | M002N

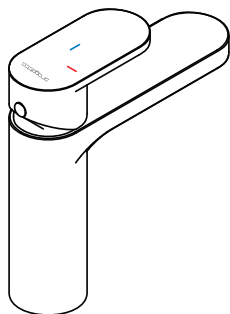

1

Screw the threaded rod into the holes at the bottom of the mixer body.

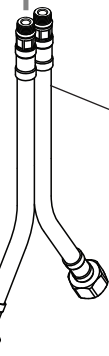
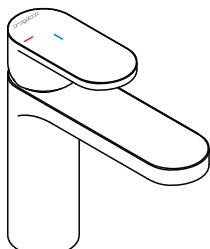

2

Screw the flexible hoses into the water inlet at the bottom of the mixer body

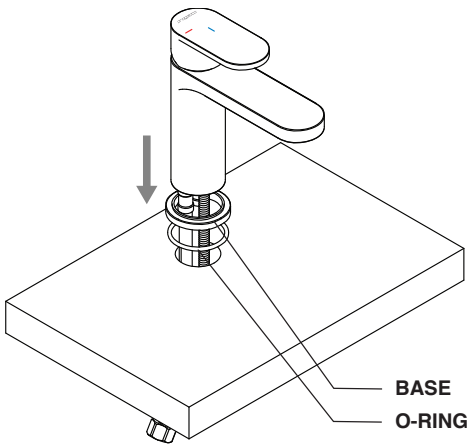

3

Slide the base and the o-ring over the mixer assembly then insert the whole block into the basin hole.

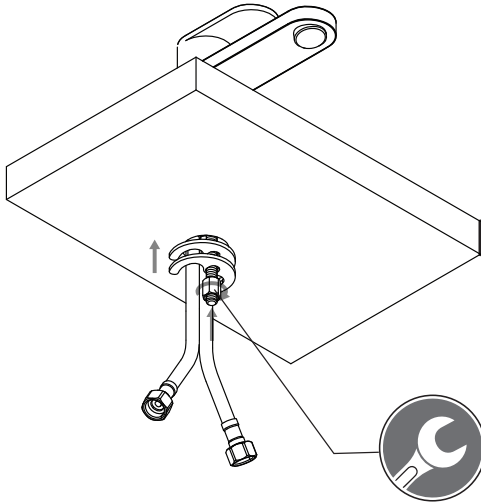

4

While holding the mixer in place, slide in the rubber gasket and the metal washer of the fixing kit. Secondly screw the nut on the threaded rod and fix it using a wrench.



**ATTENTION**

Two operators are required to avoid damages.

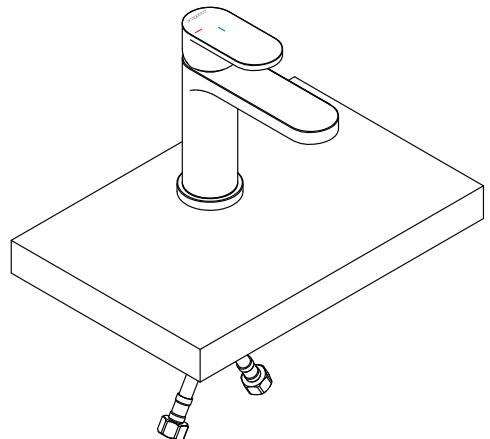

# INSTALLATION INSTRUCTIONS

## MINIMO BASIN MIXER HIGHER BODY | M004N

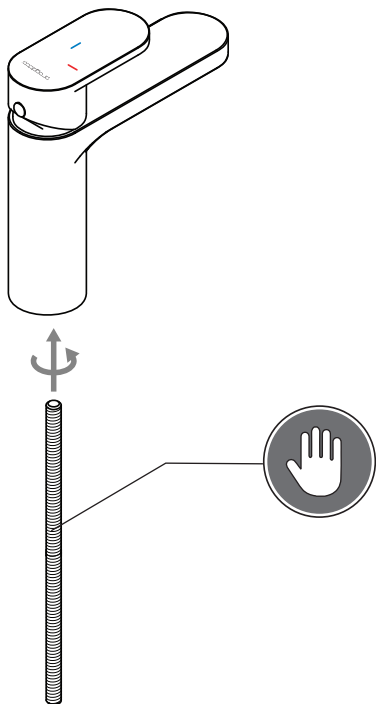

1

Screw the threaded rod into the holes at the bottom of the mixer body.

2

Screw the pipes and the flexible hoses into the water inlet at the bottom of the mixer body

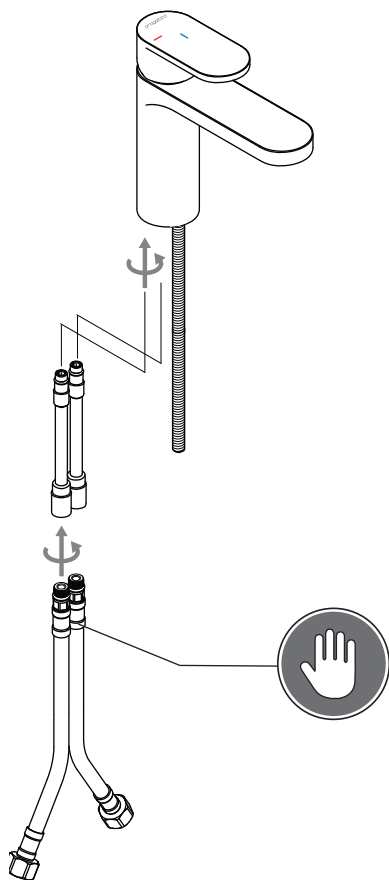

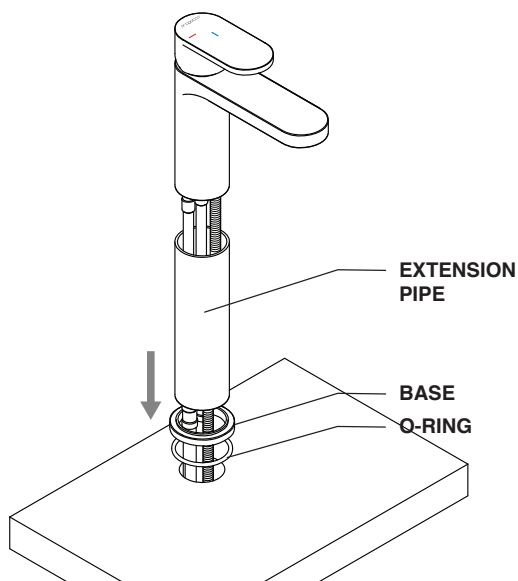

3

Slide the extension pipe, the base and the o-ring over the mixer assembly then insert the whole block into the basin hole.

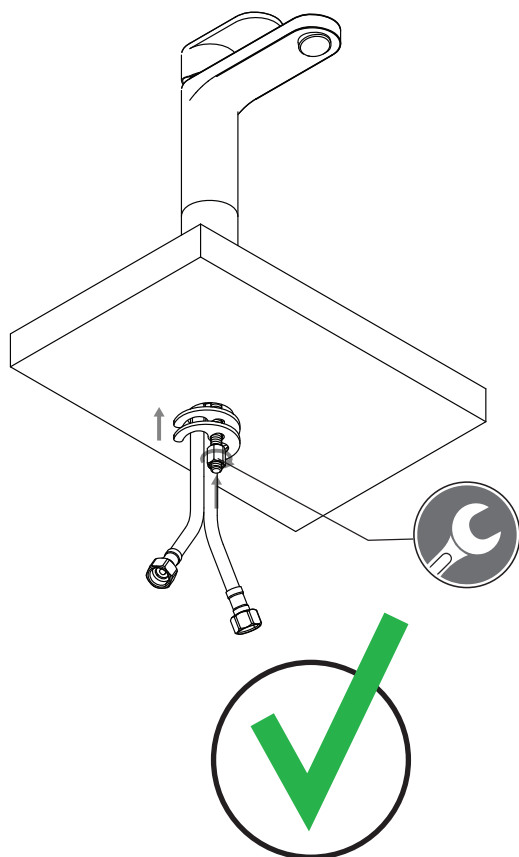

4

While holding the mixer in place, slide in the rubber gasket and the metal washer of the fixing kit. Secondly screw the nut on the threaded rod and fix it using a wrench.



## ATTENTION

Two operators are required to avoid damages.

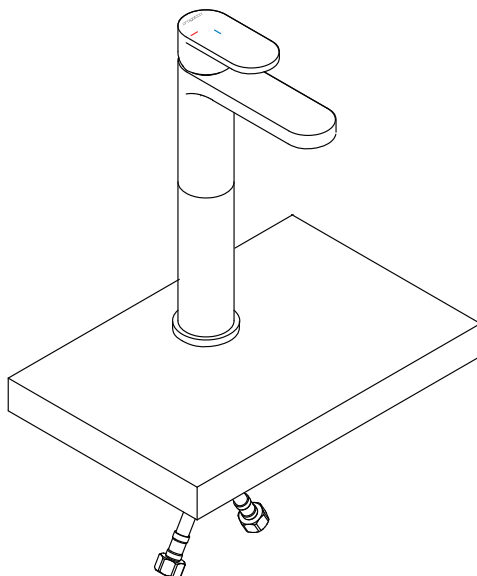

# INSTALLATION INSTRUCTIONS

## MINIMO SHOWER MIXER | M033N

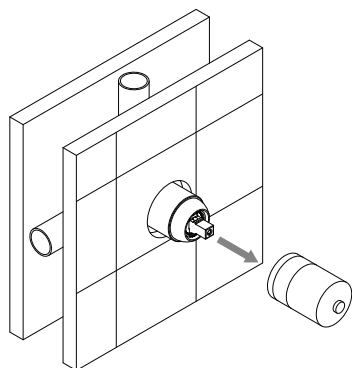
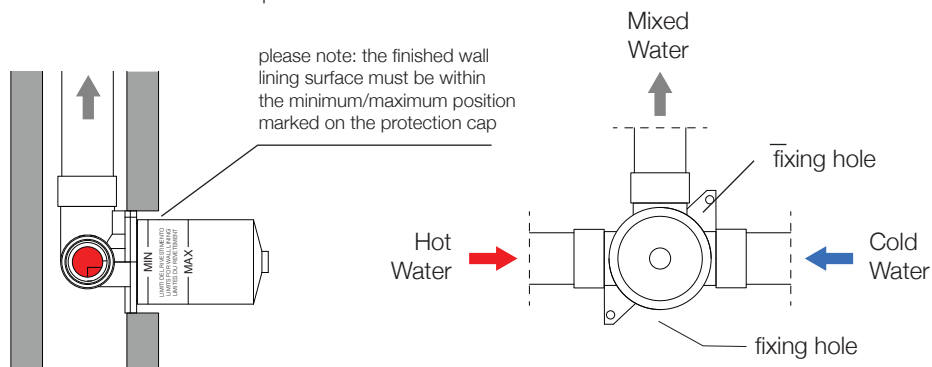

1

Pull out the protection cap.

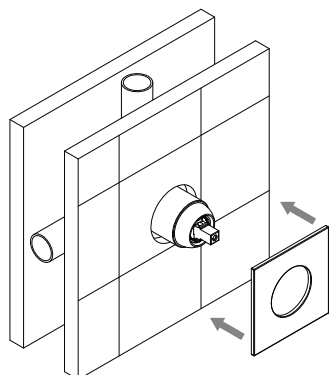

2

Slide the plate over the body and to prevent any rotation, fix it to the wall using some glue.





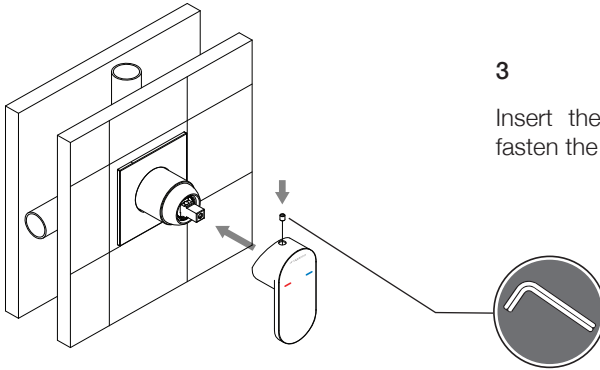

3

Insert the handle on the cartridge, then fasten the screw using the 2.5mm hex key.

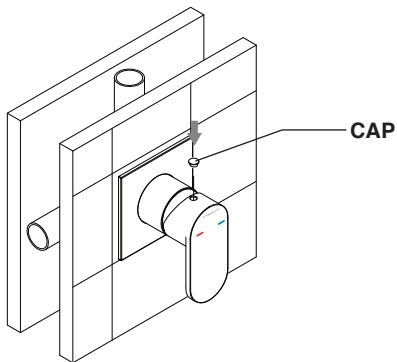

4

Insert the chrome cap into the handle hole.

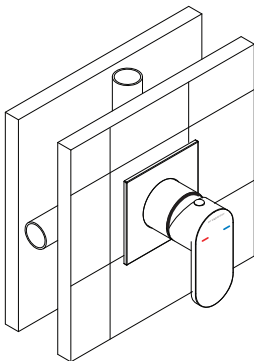

# INSTALLATION INSTRUCTIONS

## MINIMO DIVERTER MIXER | M034N

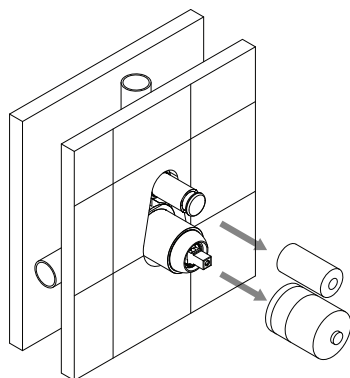
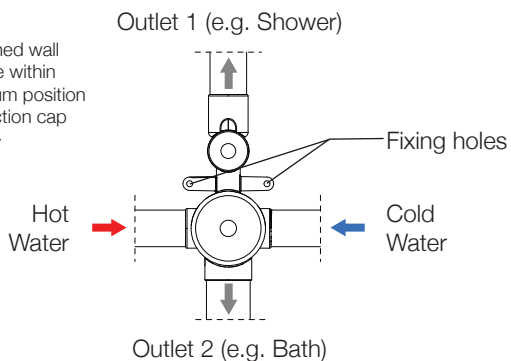
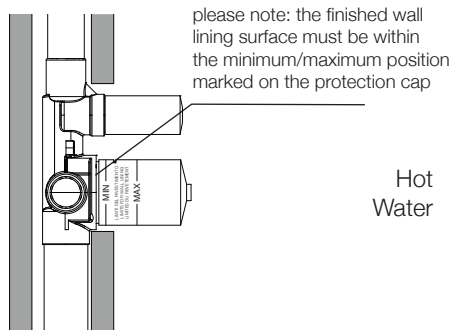

1

Pull out the protection cap.

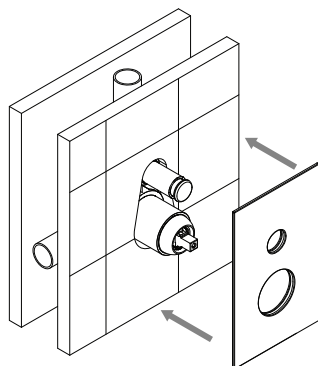

2

Slide the plate over the body and to prevent any rotation, fix it to the wall using some glue.



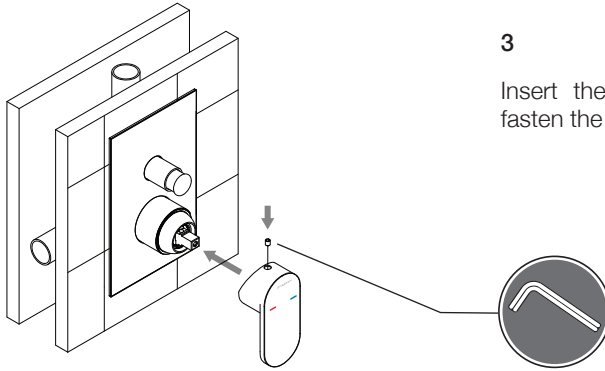

3

Insert the handle on the cartridge, then fasten the grub screw using the 2.5 hex key.

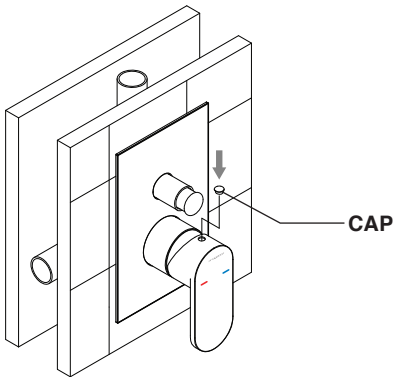

4

Insert the chrome cap into the handle hole.

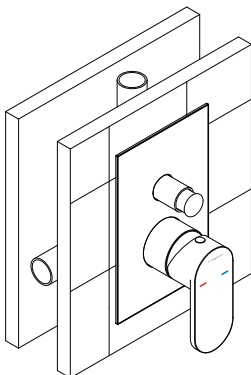

# INSTALLATION INSTRUCTIONS

## MINIMO KITCHEN MIXER | M040N

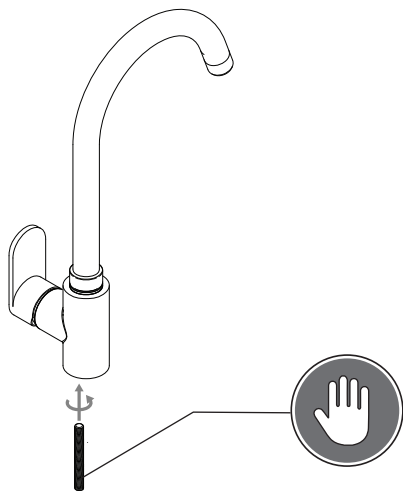

1

Screw the threaded rod into the holes at the bottom of the mixer body.

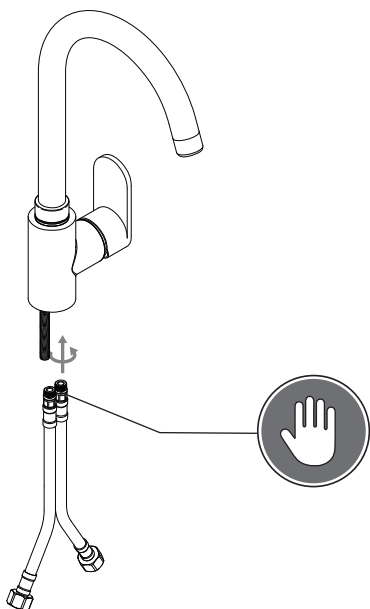

2

Screw the flexible hoses into the water inlet at the bottom of the mixer body.

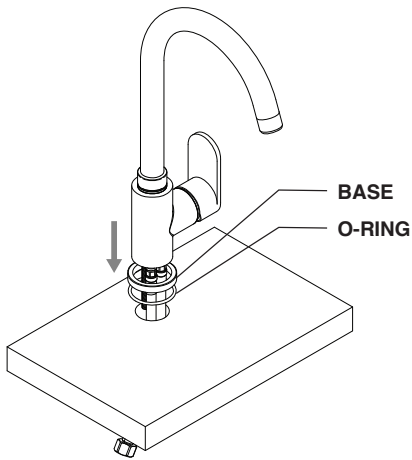

3

Slide the base and the o-ring over the mixer assembly, then insert the whole block into the basin hole.

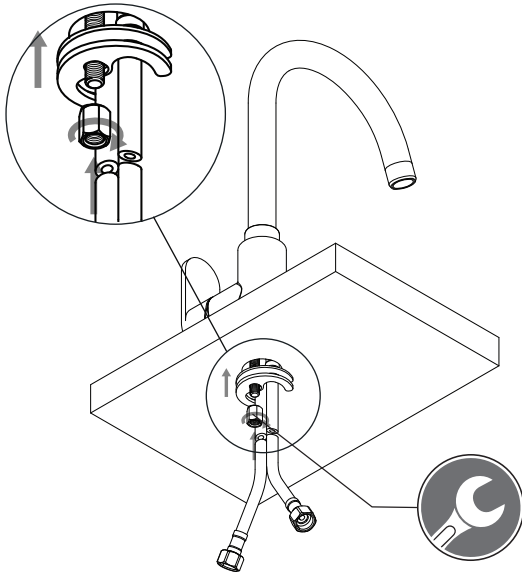

4

While holding the mixer in place, slide in the rubber gasket and the metal washer of the fixing kit. secondly screw the nut on the threaded rod and fix it using a wrench.



**CAUTION**

Two operators are required to avoid damages.

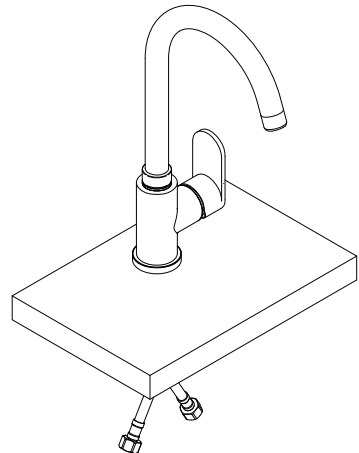

# INSTALLATION INSTRUCTIONS

## MINIMO BASIN SPOUT | M024N

**1**

Wrap the thread with PTFE tape or hemp

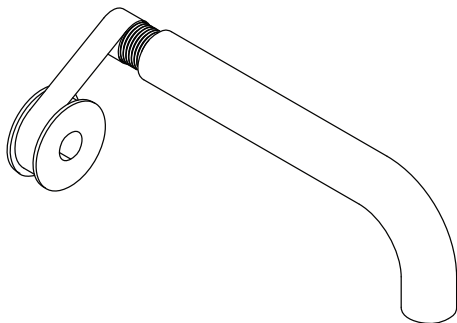

**2**

Screw the plate on the spout thread, then mount the assembly into the water outlet on the wall.

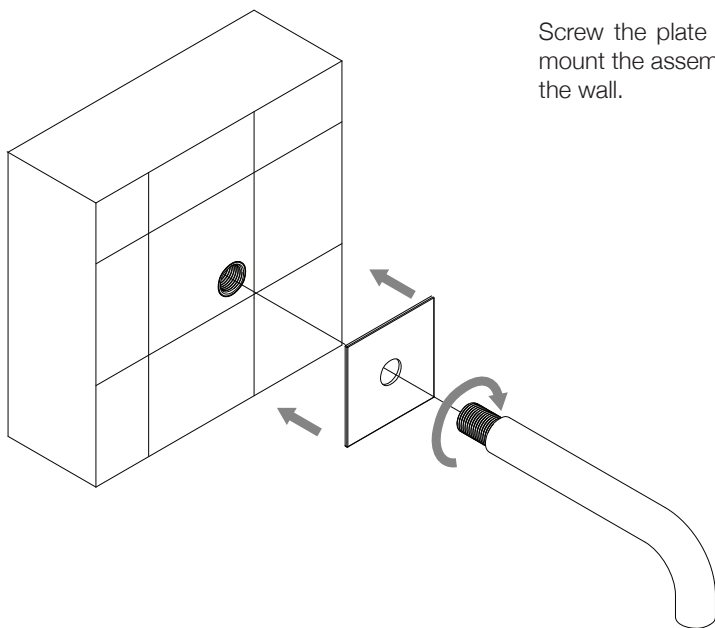

3

Fix the plate with some glue to prevent any rotation, then lock the spout in position by hand.

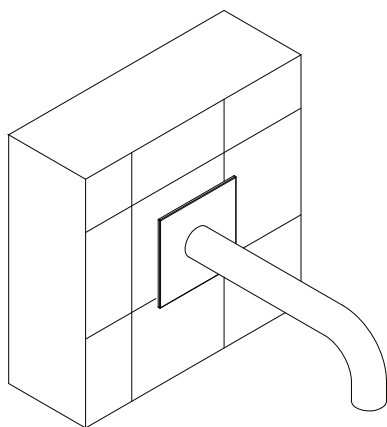
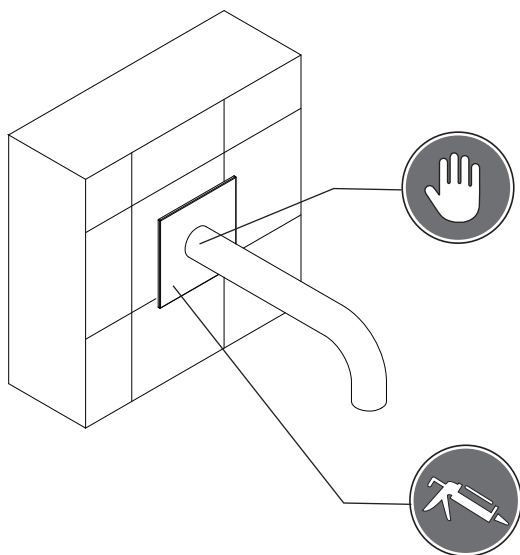

# EXPLODED DRAWINGS

## M002N

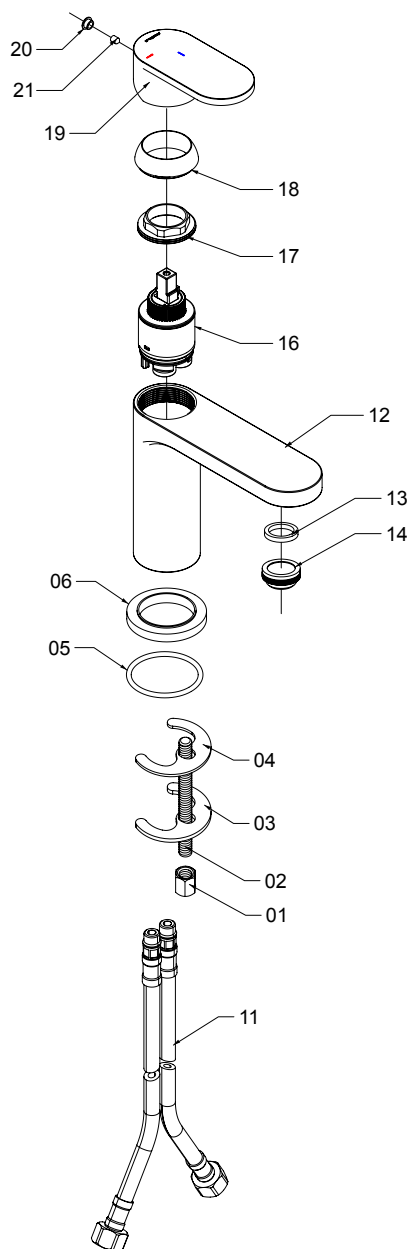

## M004N

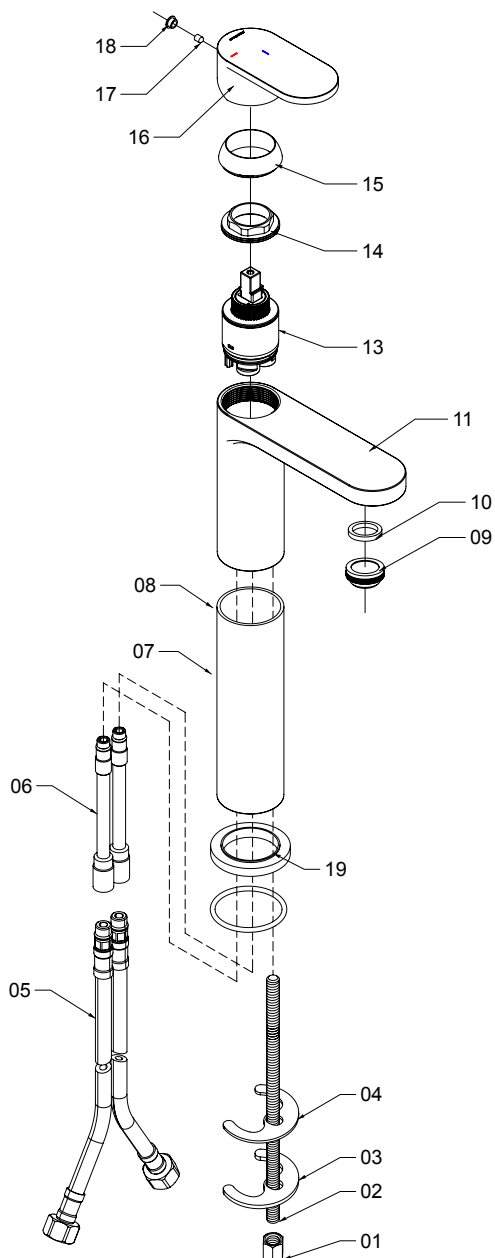



## M033N

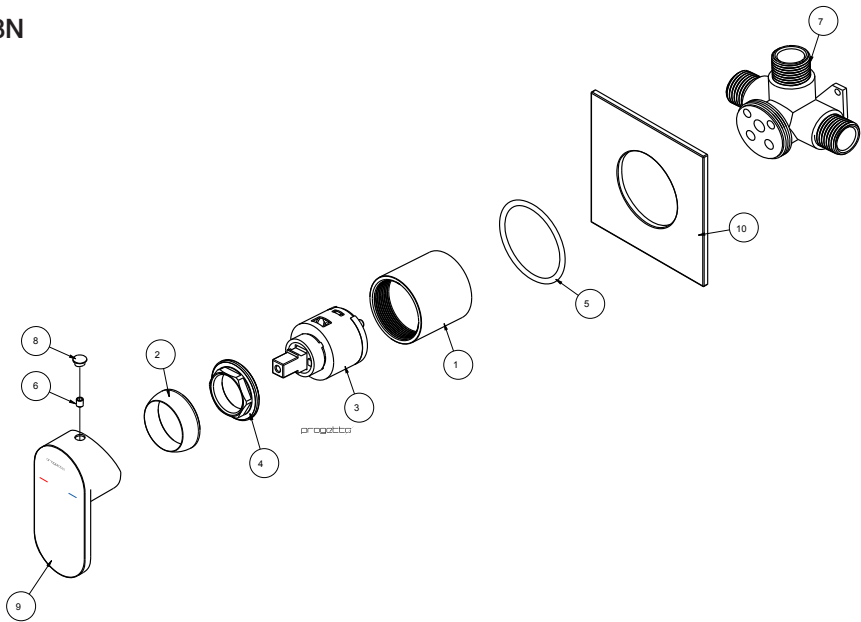

## M034N

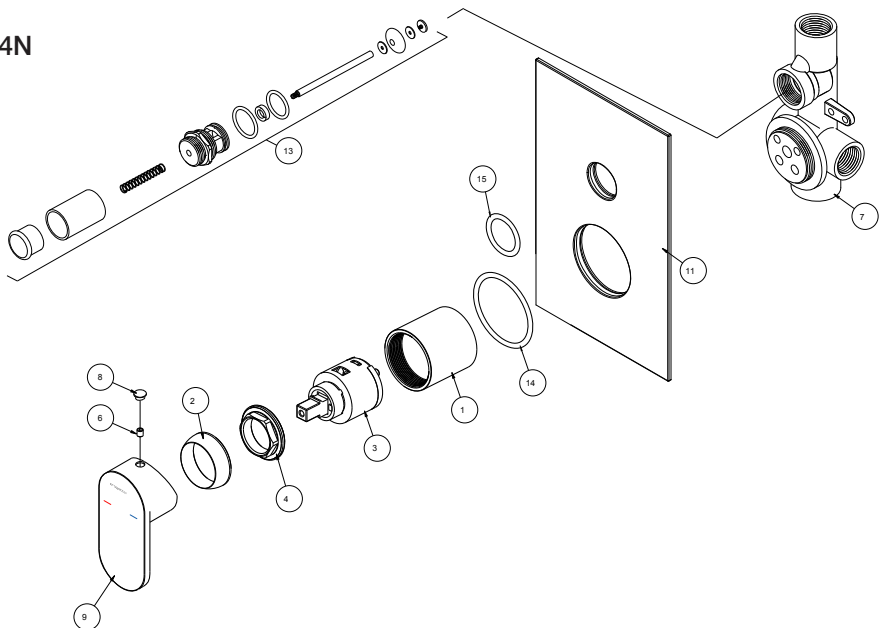

# EXPLODED DRAWINGS

## M024N

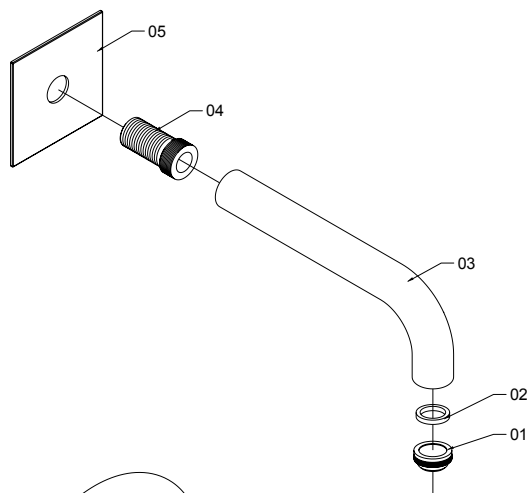

## M040N

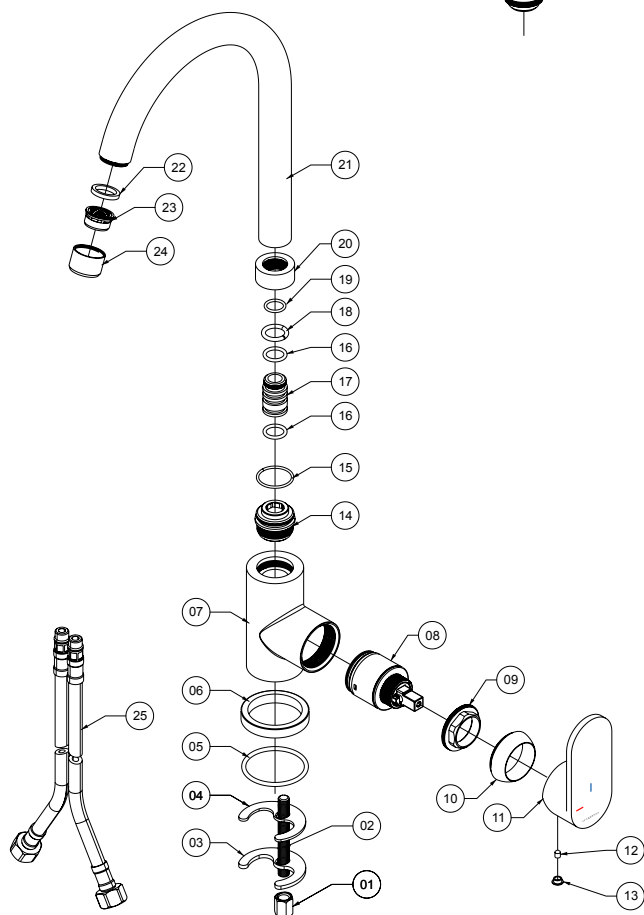

MINIMO BASIN MIXER | M002N

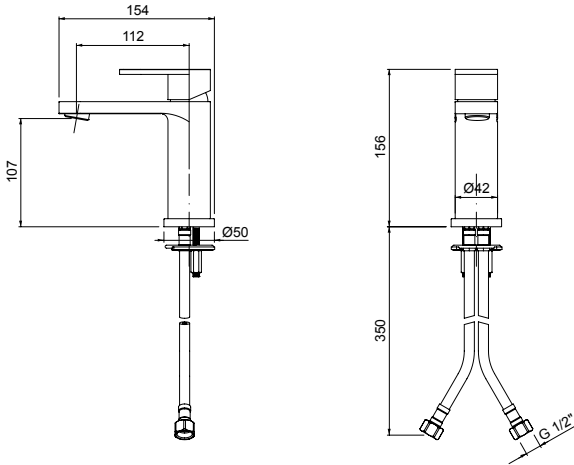

MINIMO BASIN MIXER HIGHER BODY | M004N

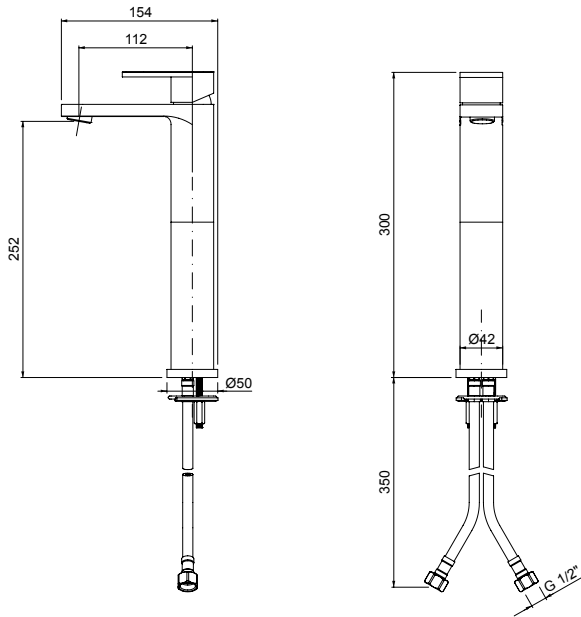

TECHNICAL DRAWINGS

MINIMO DIVERTER MIXER | M034N

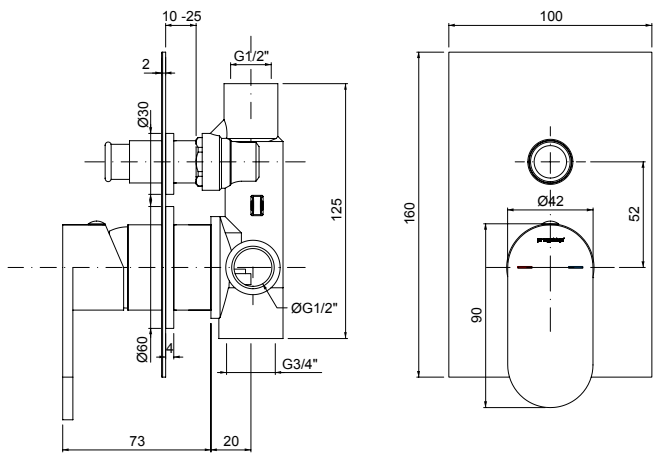

MINIMO SHOWER MIXER | M033N

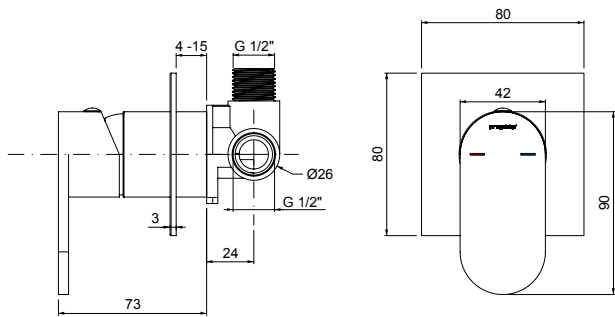

MINIMO KITCHEN MIXER | M040N

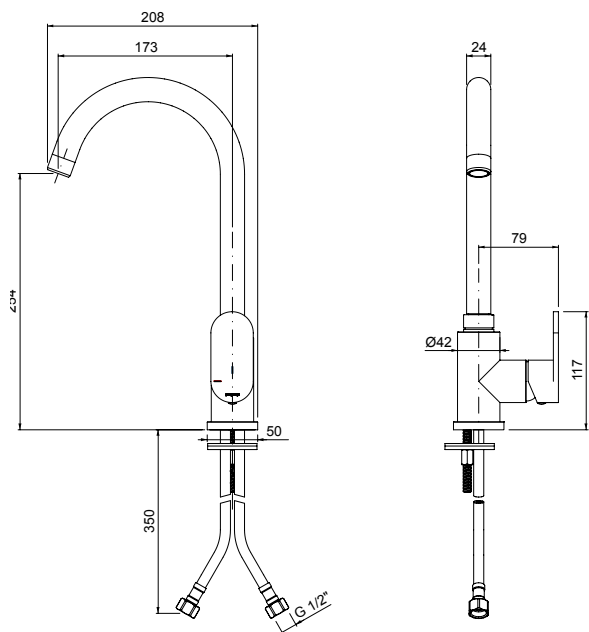

MINIMO BASIN SPOUT | M024N

