

INSTALLATION INSTRUCTIONS

progetto
DESIGN COLLECTION

LUXE FLOOR MOUNT BATH FILLER
WITH HANDSHOWER | LU077

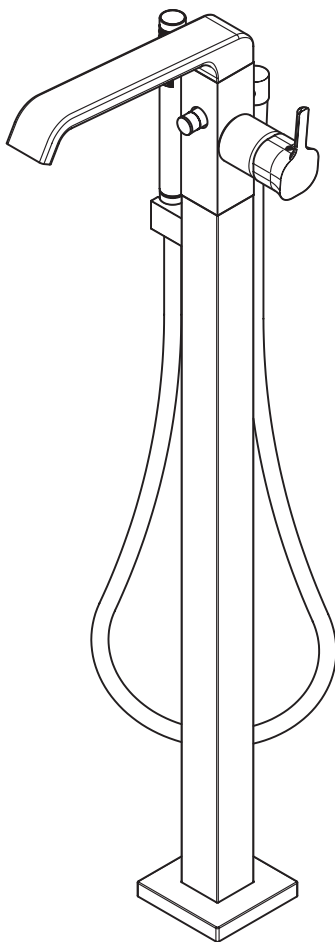

IMPORTANT!

Please read these instructions **prior** to installation

Distributed by:

Plumbline

T 04 568 9898 E sales@plumblin.co.nz
www.plumblin.co.nz

RECOMMENDATIONS FOR INSTALLATION

⚠ ATTENTION: Failure to follow these recommendations may void the warranty. It is recommended that a qualified, licensed tradesperson install this product.

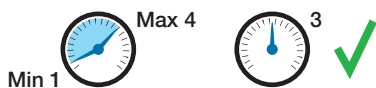

Water Pressure: 3 bar

Product performance cannot be guaranteed if pressure is less than 1 bar. Above 4 bar a pressure regulator must be installed. Failure to do so voids the product warranty.

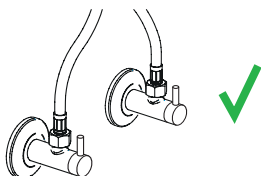

Stop Taps/Filters

Angle valves and/or filters are recommended to prevent impurities and debris entering the mixer.

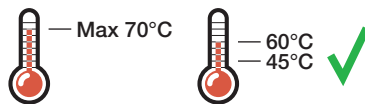

Water Temperature: 45°-65°C

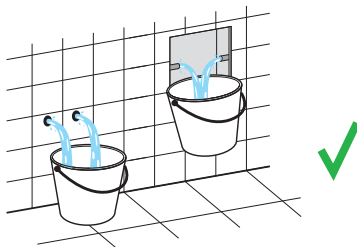

Pre-Flush

Always flush out the pipework before connecting any tapware. Failure to do so voids the product warranty.

Flexible Hoses

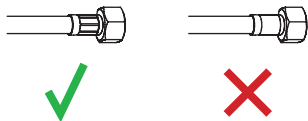

Before installation check that both end fittings of the flexible hoses are well tightened/crimped. If in doubt do not install the flexible hose.

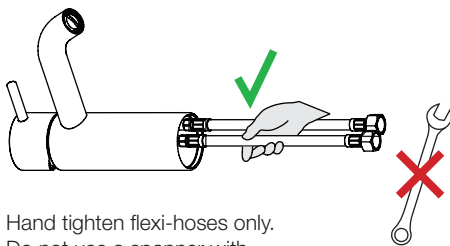

Hand tighten flexi-hoses only. Do not use a spanner with excessive force.

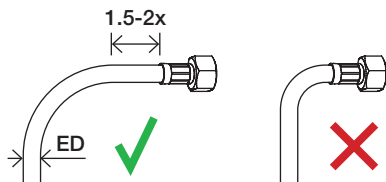

Before any bends ensure there is a straight section of the flexible hose from the hose crimp of at least 1.5-2 times the external (ED) diameter of the hose.

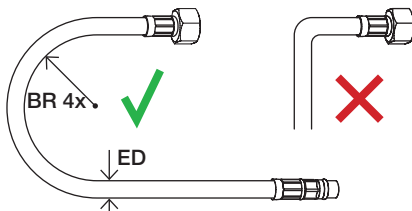

Flexible hose bending radius (BR) should be less than four times the external diameter (ED) of the hose. Do not install with any tension, twists, pinch points or sharp bends/kinks.

CLEANING & MAINTENANCE

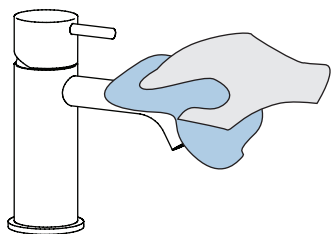

Cleaning

Clean with warm soapy water and a smooth cloth. Avoid abrasive sponges or detergents as these will damage the finish.

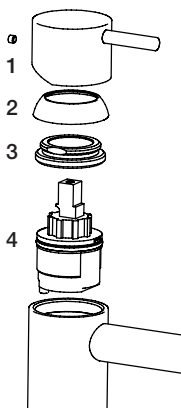

Cartridge Replacement

Before you start, turn off the water supply to the mixer.

1. Remove the handle
2. Unscrew the dome (hand tightened)
3. Unscrew the locking nut
4. Remove the cartridge

Re-assemble in reverse order

⚠ Max tightening torque on locking nut: 10-12 Nm

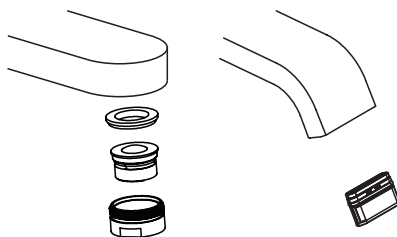

Aerator Maintenance

Remove the aerator, either with a spanner or an aerator cartridge key.

Immerse for half a day in water-vinegar solution (80-20%).

Wash, then reassemble.

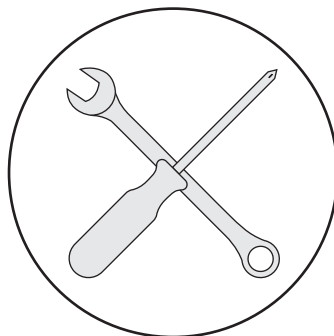

Warranty Information

For full details about our warranty visit
plumbline.co.nz/warranty-information

⚠ IMPORTANT!

When recessing the body in the floor the top of the removable cover must be level with the finished floor level. Also note that the maximum opening in the floor, after the finished floor covering has been applied, should be no more than 90mm in diameter.

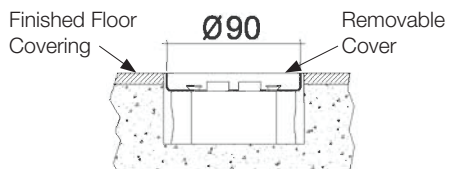

- 1 Place the internal body into the recessed area of the floor. Ensure it is level and fix it using two screws and plastic plugs. Connect the hot & cold water supply pipes.

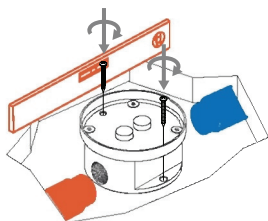

- 2 Remove the cover plate and the flexi-hose bungs.

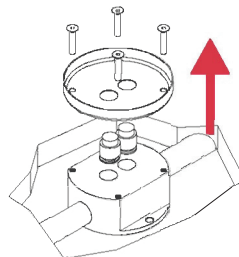

- 3 Insert the flexi-hoses and fasten the mixer unit to the internal body.

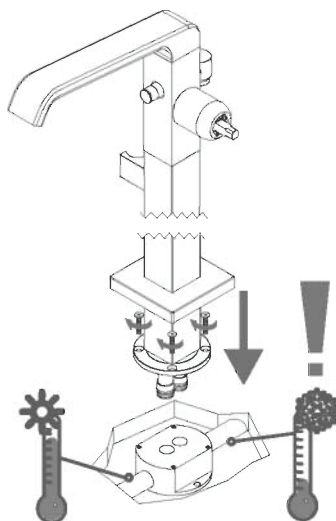

- 4 Attach the handle, shower hose and handpiece.

