

INSTALLATION INSTRUCTIONS

progetto
DESIGN COLLECTION

LUXE MINI SHOWER MIXER | LU031

LUXE SHOWER MIXER | LU032

LUXE DIVERTER MIXER | LU033

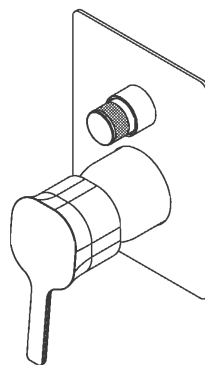
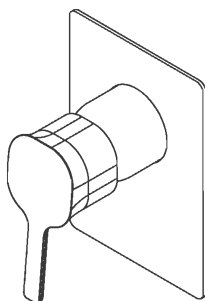
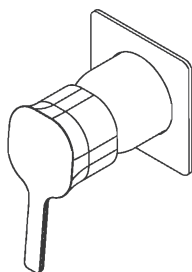

IMPORTANT!

Please read these instructions **prior** to installation

Distributed by:

Plumbline

T 04 568 9898 E sales@plumblin.co.nz
www.plumblin.co.nz

RECOMMENDATIONS FOR INSTALLATION



ATTENTION: Failure to follow these recommendations may void the warranty. It is recommended that a qualified, licensed tradesperson install this product.

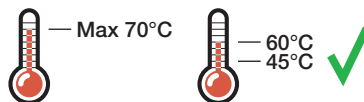
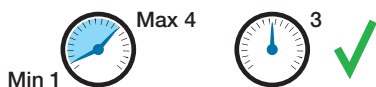

Water Pressure: 3 bar

Product performance cannot be guaranteed if pressure is less than 1 bar. Above 4 bar a pressure regulator must be installed. Failure to do so voids the product warranty.

Water Temperature: 45°-65°C

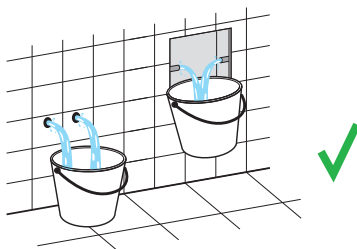
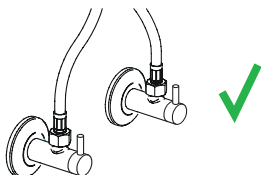

Stop Taps/Filters

Angle valves and/or filters are recommended to prevent impurities and debris entering the mixer.

Pre-Flush

Always flush out the pipework before connecting any tapware. Failure to do so voids the product warranty.

CLEANING & MAINTENANCE

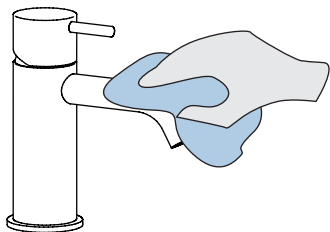

Cleaning

Clean with warm soapy water and a smooth cloth. Avoid abrasive sponges or detergents as these will damage the finish.

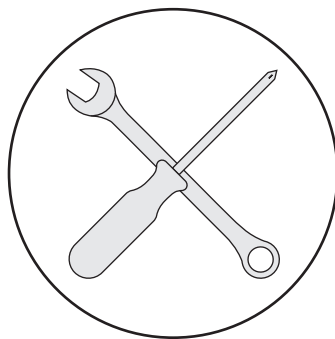
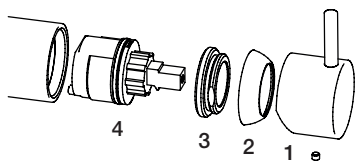

Cartridge Replacement

Before you start, turn off the water supply to the mixer.

1. Remove the handle
2. Unscrew the dome (hand tightened)
3. Unscrew the locking nut
4. Remove the cartridge

Re-assemble in reverse order

 Max tightening torque on locking nut: 10-12 Nm

Warranty Information

For full details about our warranty visit
plumbline.co.nz/warranty-information

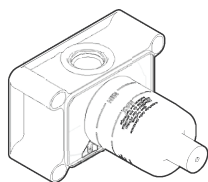

SHOWER MIXER INTERNAL PARTS

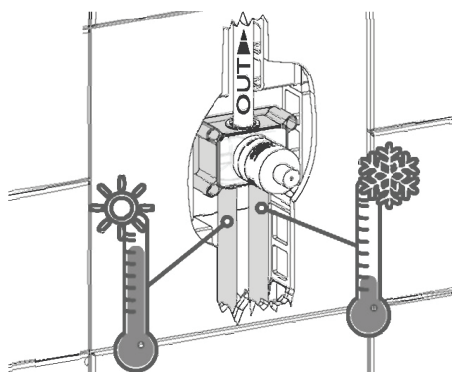
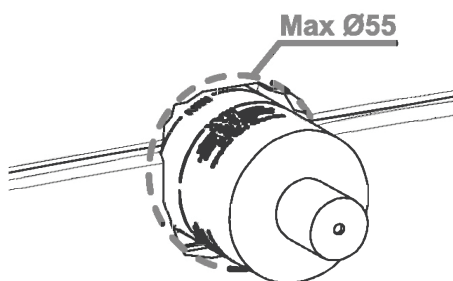

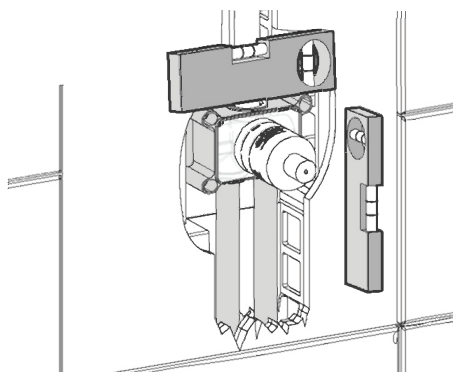

- 1  When preparing the wall for pipework and suitable fixing points for the mixer body, ensure that the finished wall surface is within the minimum/maximum parameters shown on the protective sleeve.

- 2 Connect the hot & cold water inlet pipes and the outlet pipe.



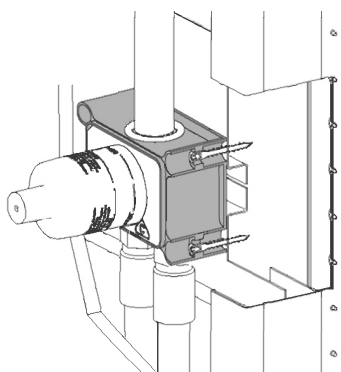

- 3 Ensure the mixer body is level.

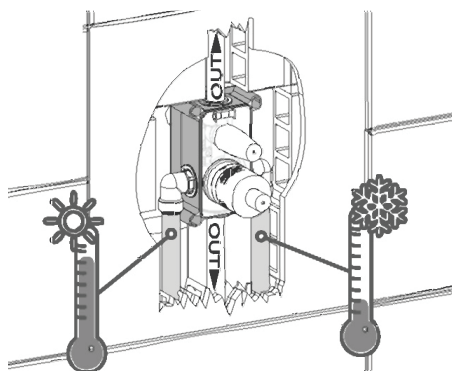
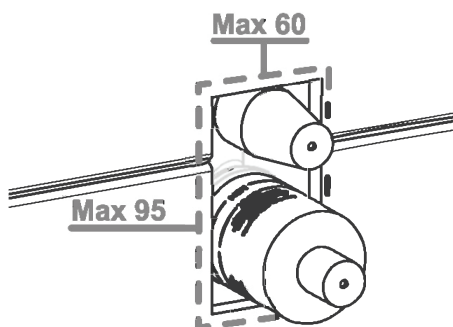
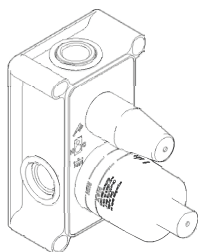

- 4 Fasten the mixer body to the wall.
 Pressure test the unit before wall lining to ensure there are no leaks.

DIVERTER MIXER INTERNAL PARTS



- 1  When preparing the wall for pipework and suitable fixing points for the mixer body, ensure that the finished wall surface is within the minimum/maximum parameters shown on the protective sleeves.

- 2 Connect the hot & cold water inlet pipes and the two outlet pipes.

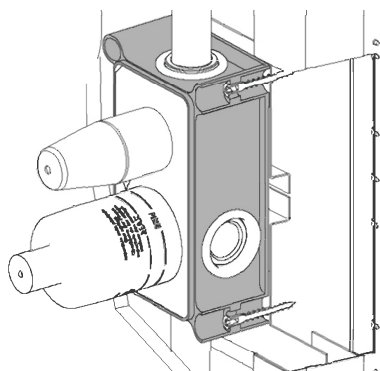
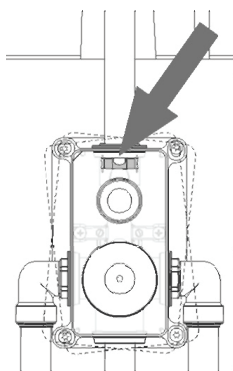

- 3 Ensure the mixer body is level using the spirit level on the mixer body.

- 4 Fasten the mixer body to the wall.
 Pressure test the unit before wall lining to ensure there are no leaks.

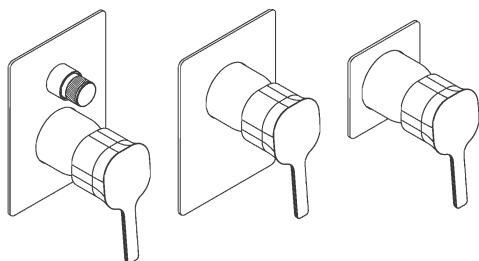

SHOWER/DIVERTER MIXER EXTERNAL PARTS

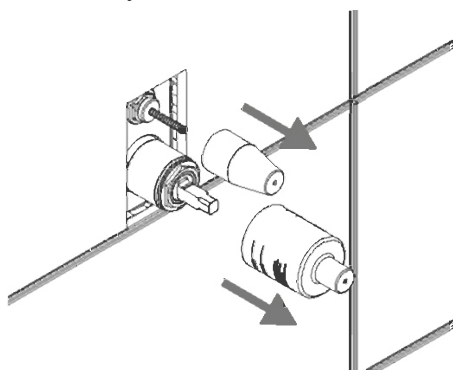

1 Remove the protective sleeves.

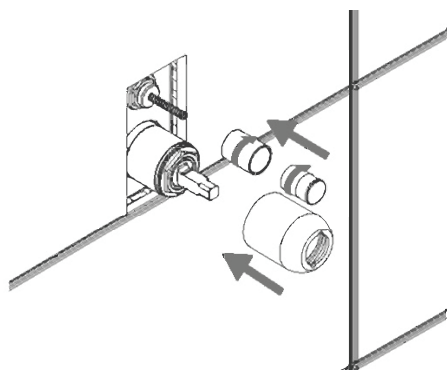

2 Install the external trim parts.

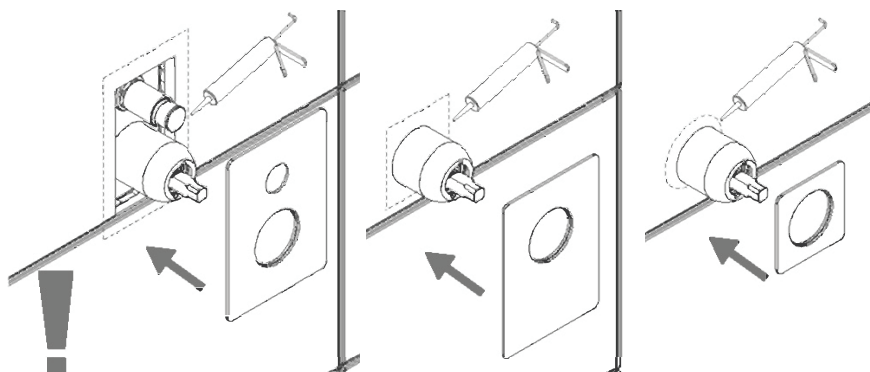

3 Slide on the faceplate. It is recommended to apply a small bead of silicone behind the faceplate to prevent water entering the wall cavity.

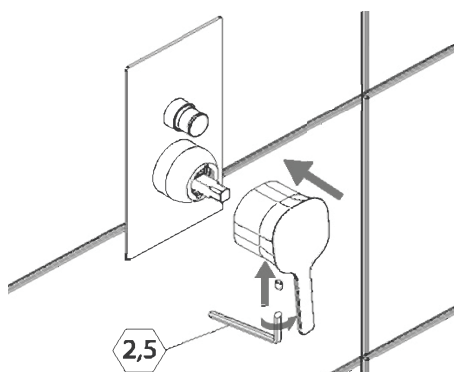

4 Install the handle

