

# INSTALLATION INSTRUCTIONS

## REGAL/ARENA WALL MOUNT/CEILING MOUNT RAINHEAD

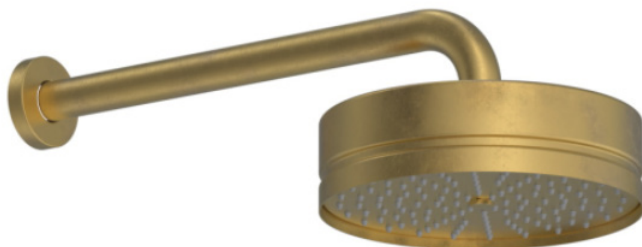

---

Distributed by:

**Plumblīne**

T 04 568 9898 E [sales@plumblīne.co.nz](mailto:sales@plumblīne.co.nz)  
[www.plumblīne.co.nz](http://www.plumblīne.co.nz)

# INSTALLATION INSTRUCTIONS

## REGAL/ARENA WALL MOUNT/CEILING MOUNT RAINHEAD

**IMPORTANT NOTE: PRIOR TO LINING THE WALL, ENSURE THE WINGBACK IS FIRMLY FASTENED IN PLACE.**

1 - Firstly, sit the flange in place, then apply thread sealant to the thread.

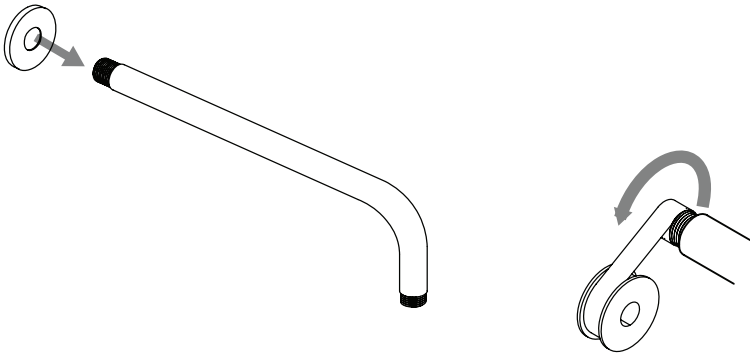

2 - Secondly, fasten the shower arm into the wingback and apply a bead of silicone to prevent moisture from entering the wall/ceiling cavity.

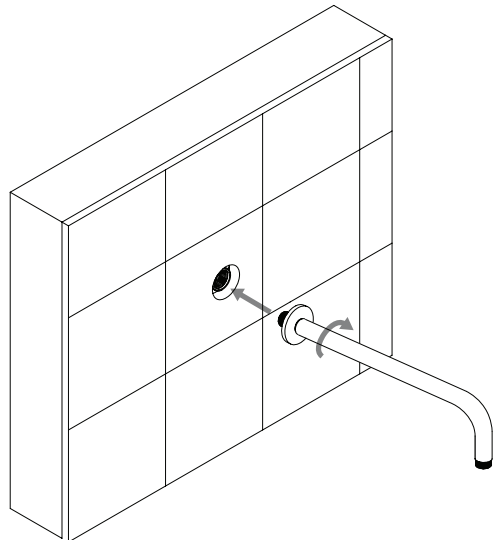

# INSTALLATION INSTRUCTIONS

## REGAL/ARENA WALL MOUNT/CEILING MOUNT RAINHEAD

3 - Insert the washer between the rainhead and shower arm and tighten the rainhead in place. Note - this only needs to be hand tightened.

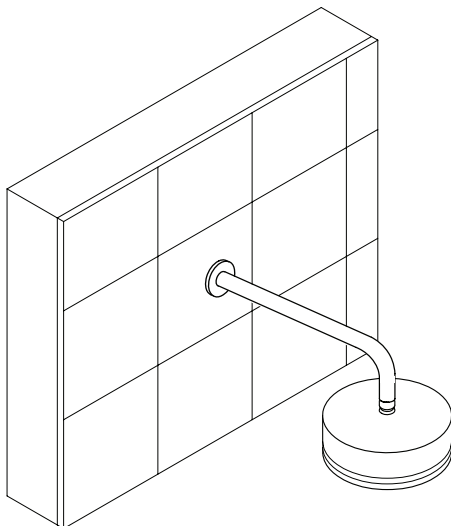
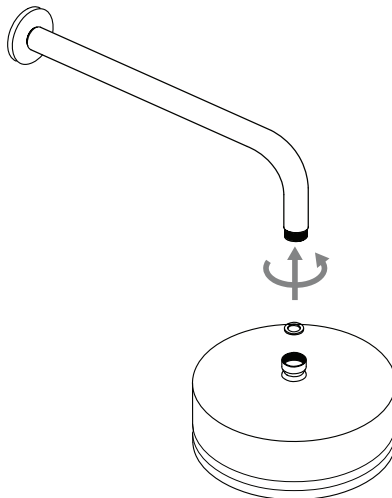

4 - Test the rainhead for performance.

22/04/2024

Distributed by:

**Plumbl ine**

T 04 568 9898 E [sales@plumbl ine.co.nz](mailto:sales@plumbl ine.co.nz)  
[www.plumbl ine.co.nz](http://www.plumbl ine.co.nz)