

INSTALLATION INSTRUCTIONS

OLI 316 BASIN/BATH WASTE | OL710/OL610

progetto
DESIGN COLLECTION

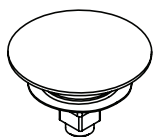

1

Firstly, remove the waste cap and mechanism.

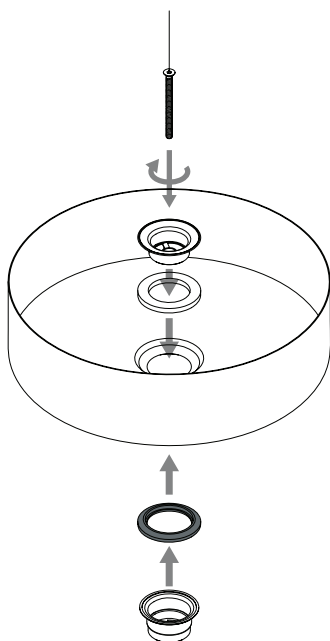

2

Using the centre draw bolt, fasten the waste into place ensuring that all washers supplied are used.

INSTALLATION INSTRUCTIONS

progetto
DESIGN COLLECTION

OLI 316 BASIN/BATH WASTE | OL710/OL610

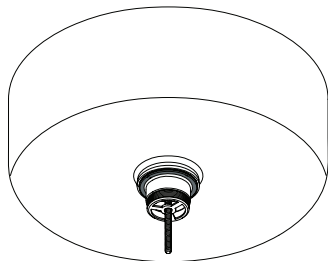

- 3
Screw the waste cap and mechanism down into place.

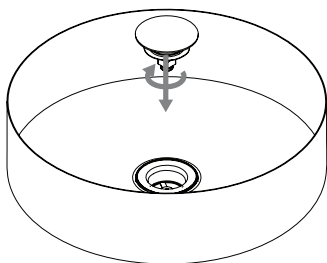

- 4
Finally, test for performance and ensure that there are no leaks.

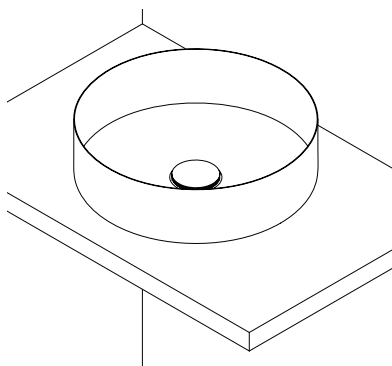

Distributed by:

Plumblin

T 04 568 9898 E sales@plumblin.co.nz
www.plumblin.co.nz