

INSTALLATION INSTRUCTIONS

ARENA & REGAL WALL MOUNT MIXER | 3778.56M | 3478K

OFFICINA
NICOLAZZI
DAL 1960



Distributed by:

Plumblīne

T 04 568 9898 E sales@plumblīne.co.nz
www.plumblīne.co.nz

INSTALLATION INSTRUCTIONS

ARENA & REGAL WALL MOUNT MIXER | 3778.56M | 3478K

OFFICINA
NICOLAZZI
DAL 1960

1

Apply thread sealant to three lugged nipples. Using these lugged nipples, connect these up the hot/cold water inlets and the mixed water outlet.

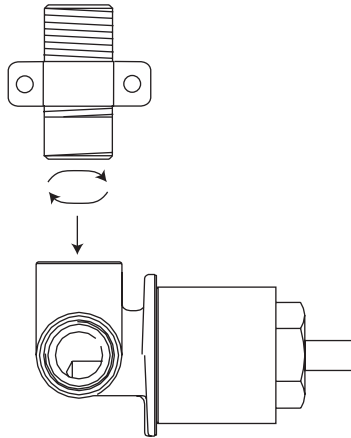

2

Fasten the unit back against the framing. Ensure that the mixer is sitting level and that the projected wall lining will sit between the max min measurement as shown on the website spec.

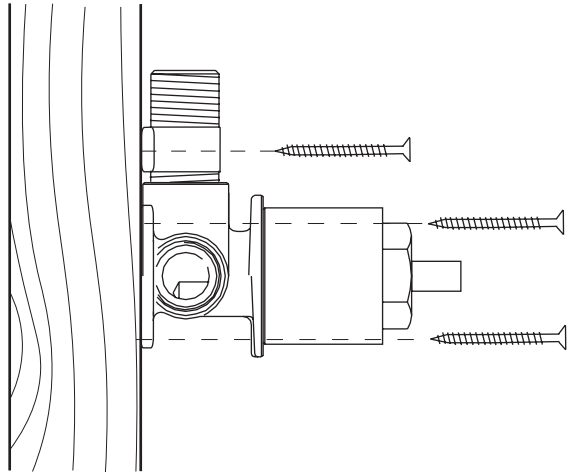

INSTALLATION INSTRUCTIONS

ARENA & REGAL WALL MOUNT MIXER | 3778.56M | 3478K

OFFICINA
NICOLAZZI
DAL 1960

3 - Fasten a wingback in the the desired position of the spout, then connect a water pipe from the outlet of the mixer to this wingback.

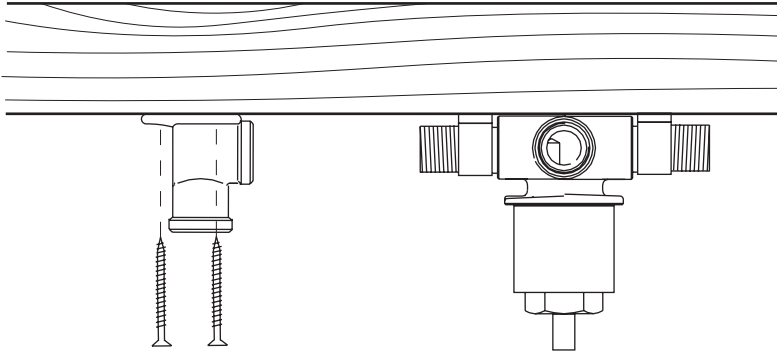

4

Once the wall has been lined fit the mixer body off with the externals. Apply sufficient thread sealant to the spout fitting then install spout.

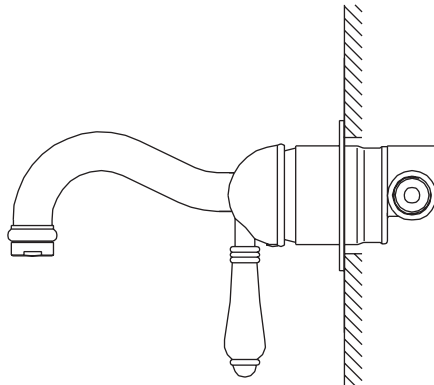

5

Finally, test the wall mount mixer for performance.

V 17/04/2024

Distributed by:

Plumbline

T 04 568 9898 E sales@plumblin.co.nz
www.plumblin.co.nz