

INSTALLATION INSTRUCTIONS

REGAL CLASSIC / ARENA KITCHEN MIXER WITH PULL OUT SPRAY | 3420/3431



Distributed by:

Plumblīne

T 04 568 9898 E sales@plumblīne.co.nz
www.plumblīne.co.nz

INSTALLATION INSTRUCTIONS

REGAL CLASSIC / ARENA KITCHEN MIXER WITH PULL OUT SPRAY | 3420/3431

1

Place the kitchen mixer down through the base ring and bench hole, ensuring the O-ring is sitting under the base ring. Then fasten in place with the washer and locking nut.

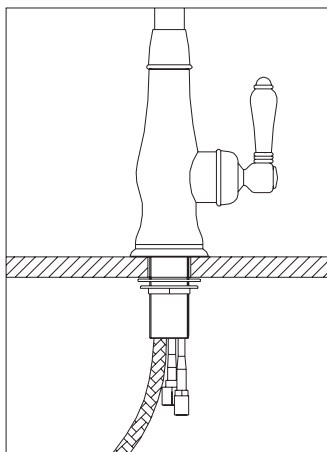

2

Connect the hot and cold flexible hoses from the inlets to the copper tails on the under side of the mixer.

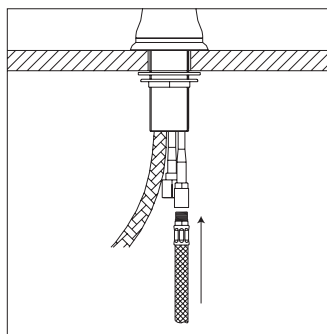

3

Connect the pull out spray hose to the brass connector, then connect this up to the copper tail with the swivel connection. Ensure that washers are used on both of these connections.

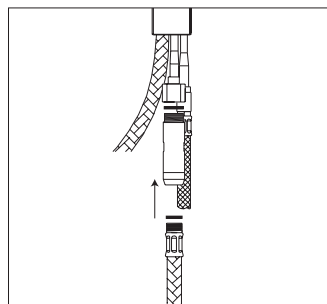

INSTALLATION INSTRUCTIONS

REGAL CLASSIC / ARENA KITCHEN MIXER WITH PULL OUT SPRAY | 3420/3431

4

Fasten the weight onto the pull-out hose, ensuring that it is fastened to the side of the pull-out hose that is connected to the handpiece.

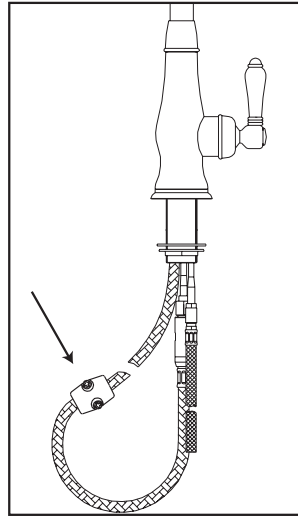

5

Finally, test for performance.

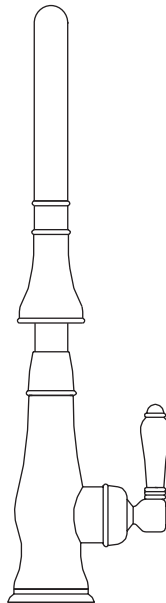

V 28/11/2023

Distributed by:

Plumblīne

T 04 568 9898 E sales@plumblīne.co.nz
www.plumblīne.co.nz