

# CLEANING

	✓			✗			WARNING
<b>CR</b> CHROME							Inoxidizable plated finish
<b>GN</b> BRUSHED NICKEL							Inoxidizable plated finish Avoid citrus based cleaners
<b>BB</b> BRUSHED BRASS							Natural metal finish: patina will form over time Avoid citrus based cleaners
<b>AB</b> AGED BRASS							Aged metal finish: patina will form over time Avoid citrus based cleaners
<b>WH</b> MATT WHITE							Varnished finish: subject to surface scratches if not properly handled Avoid citrus based cleaners
<b>BL</b> MATT BLACK							Varnished finish: subject to surface scratches if not properly handled Avoid citrus based cleaners
<b>AI</b> AGED IRON							Plated finish: subject to surface scratches if not properly handled Avoid citrus based cleaners
<b>MGP</b> MATT GUNMETAL PVD							Inoxidizable PVD finish Avoid citrus based cleaners
<b>MCP</b> MATT CHAMPAGNE PVD							Inoxidizable PVD finish Avoid citrus based cleaners
<b>BBP</b> BRUSHED BRASS PVD							Inoxidizable PVD finish Avoid citrus based cleaners
<b>BZP</b> BRUSHED BRONZE PVD							Inoxidizable PVD finish Avoid citrus based cleaners
<b>TB</b> TUSCAN BRONZE							Varnished finish: subject to surface scratches if not properly handled Avoid citrus based cleaners

CBA01-90-NZ 02-04-24

**Buddy**  
Bathroom accessories

**progetto**  
DESIGN COLLECTION

**Plumblin**

T 04 568 9898  
E sales@plumblin.co.nz  
www.plumblin.co.nz

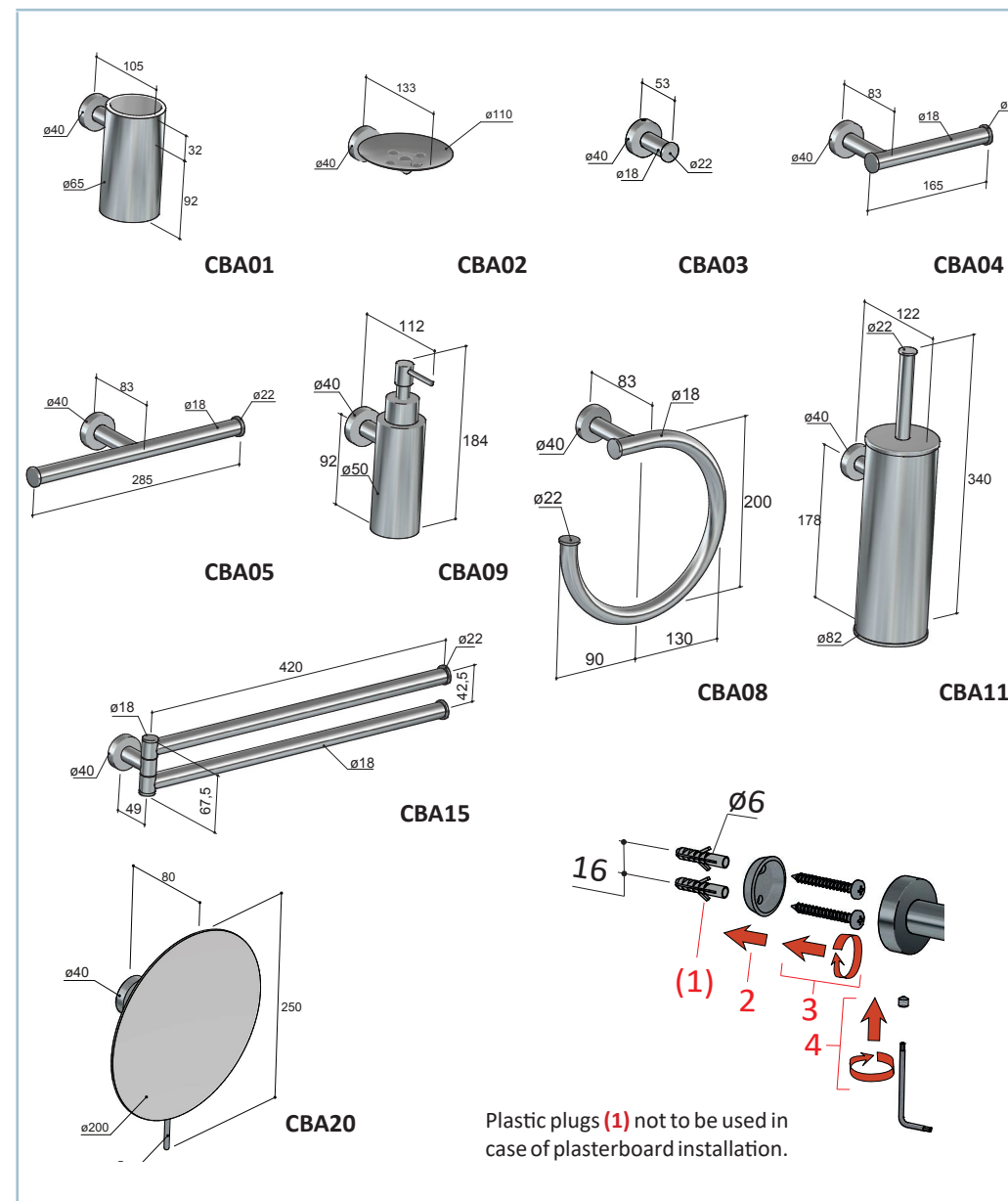

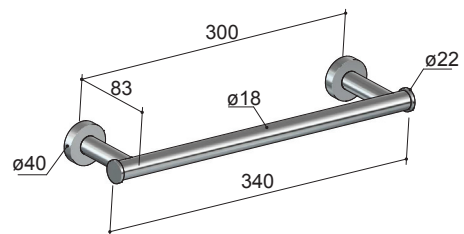

**CBA06**

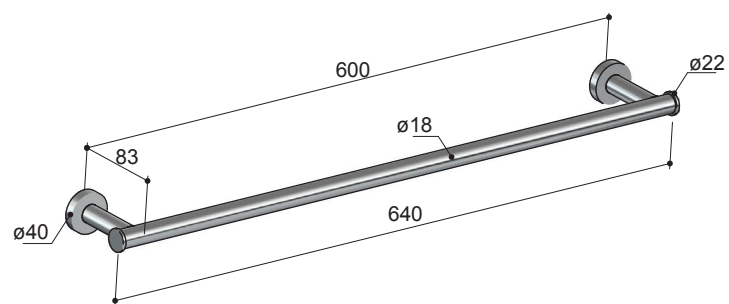

**CBA07**

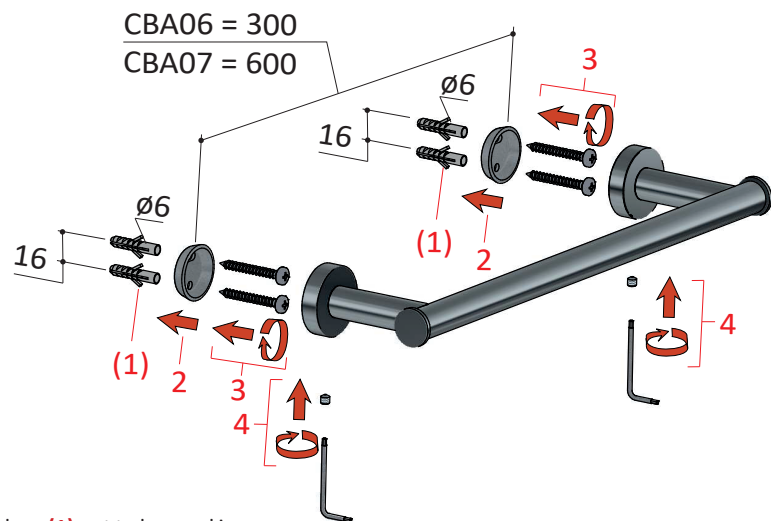

Plastic plugs (1) not to be used in case of plasterboard installation.

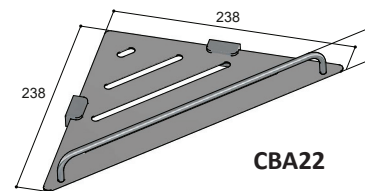

**CBA22**

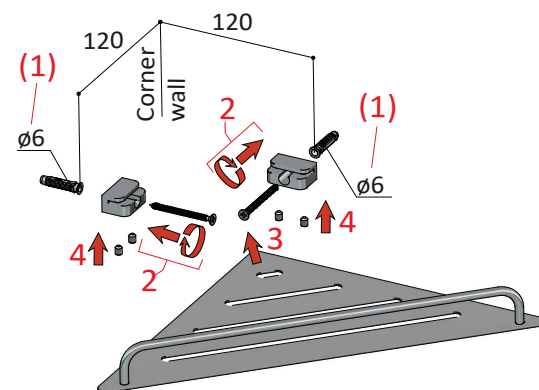

Plastic plugs (1) not to be used in case of plasterboard installation.

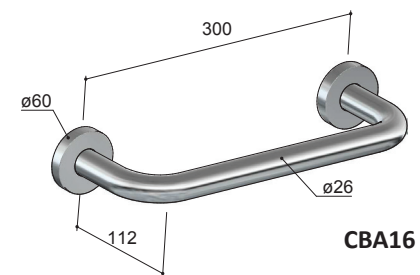

**CBA16**

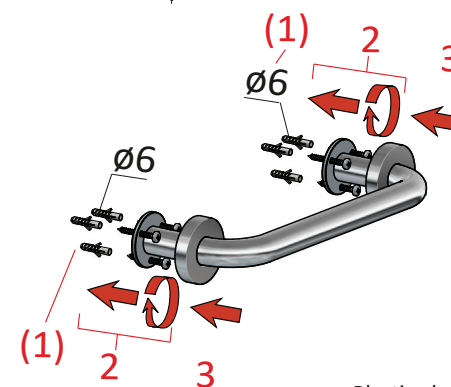

Plastic plugs (1) not to be used in case of plasterboard installation.