

PARTS LIST

S10 SLIM INWALL CISTERN Code: SPS100

- 1 - Code: 002992 (Outlet valve)
 - 2 - Code: 883028 (Outlet valve seal only)
 - 3 - Code: 021266 (Flush pipe and seal)
 - 4 - Code: 021209 (Flush pipe seal only)
 - 5 - Code: 012001 (Inlet valve diaphragm)
 - 6 - Code: 091096 (Inlet valve and support)
 - 7 - Code: SPS100PK (Pneumatic conversion kit)
 - 8 - Code: 026698 (Tile box)
 - 9 - Code: 037132 (Horizontal Flush Pipe and Key Seal)
 - 9.1 - Code: 602201 (Extended horizontal Flush Pipe - 280mm)
- For any other specific parts, please inquire

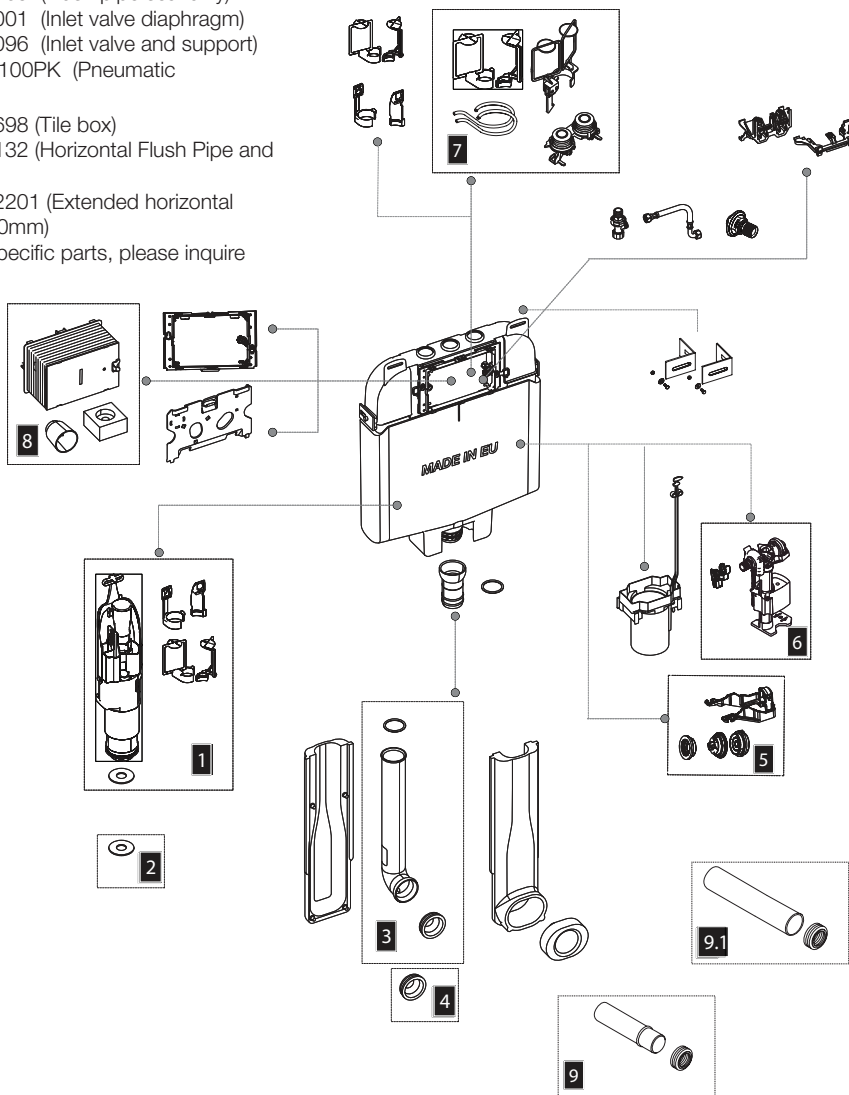

Distributed by:

Plumblin

T 04 568 9898 E sales@plumblin.co.nz
www.plumblin.co.nz