

INSTALLATION INSTRUCTIONS

ZEN URINAL REAR INLET

progetto
DESIGN COLLECTION

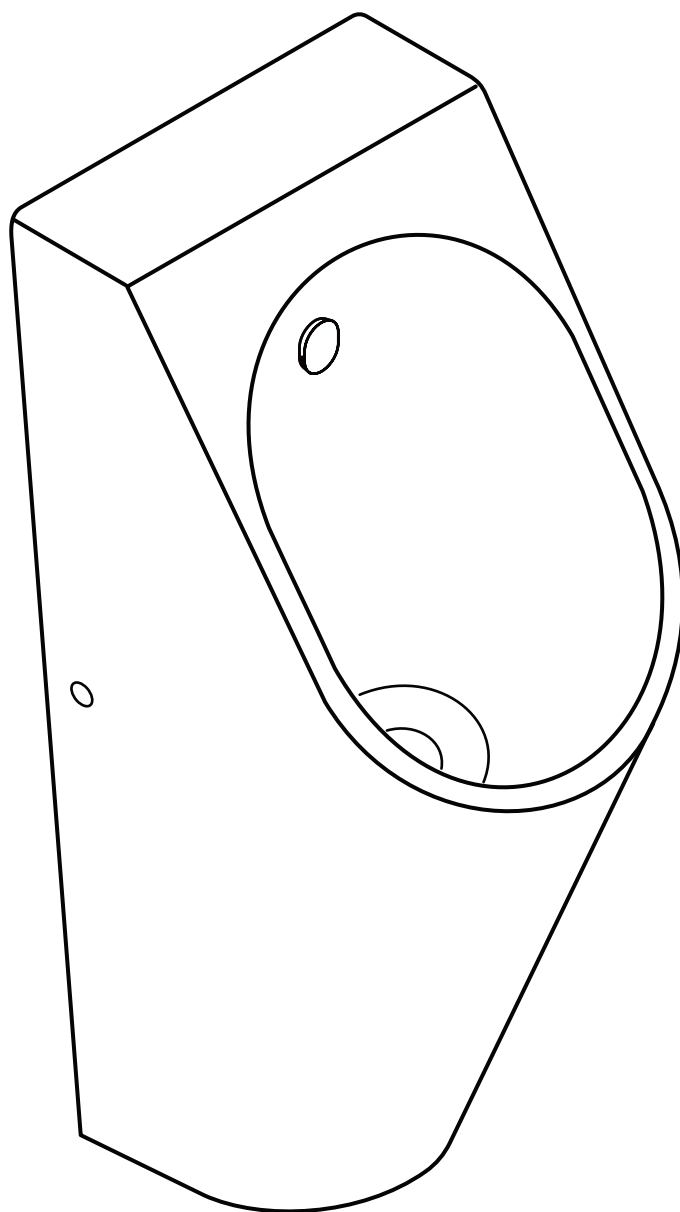

Distributed by:

Plumblīne

Exceptional Bathrooms.
Exceptional Choice.

T 04 568 9898 E sales@plumblīne.co.nz www.plumblīne.co.nz

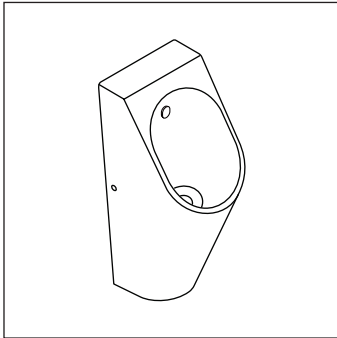

Back Inlet

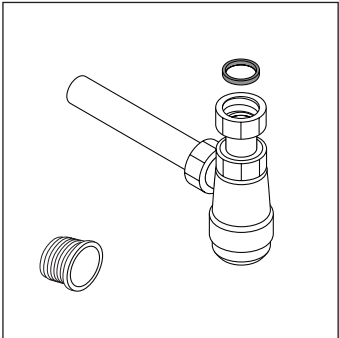
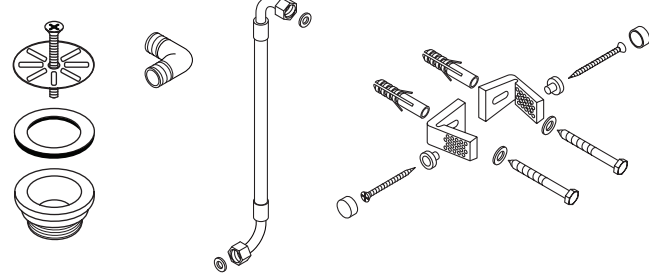

Prior to lining the wall, refer to the website spec drawing for inlet and outlet positions. also ensure that there is sufficient framing to fasten the fixing brackets to.

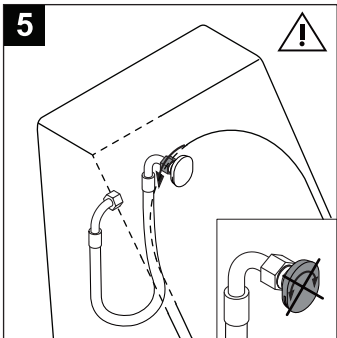
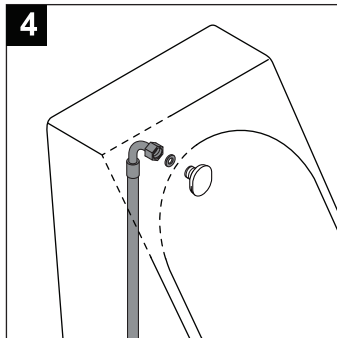
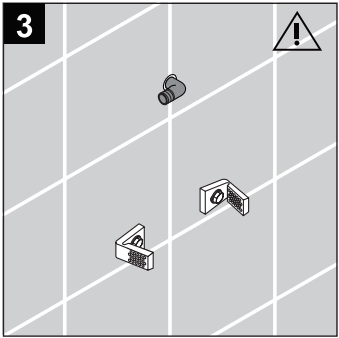
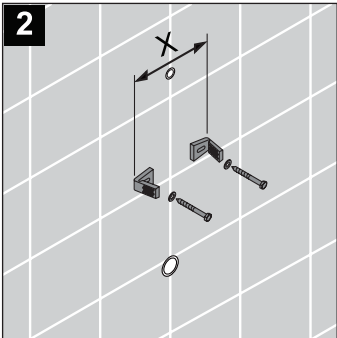
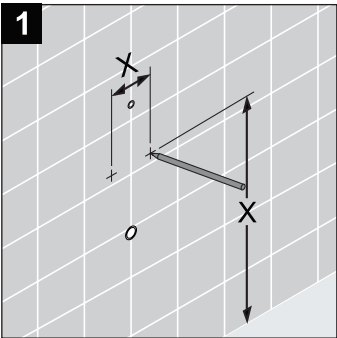

IMPORTANT: when installing the flexible hose to the sparge nozzle, ensure that the nozzle is pointed in the correct orientation and is tightened into the place with the backing nut.

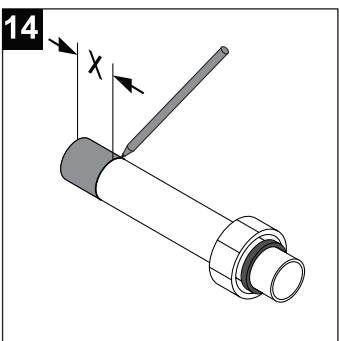
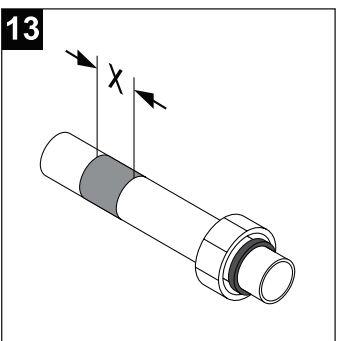
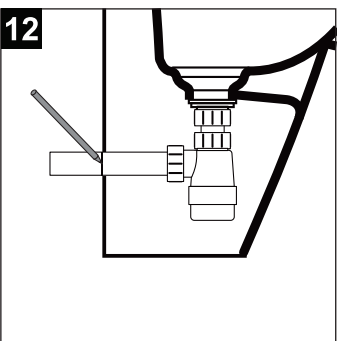
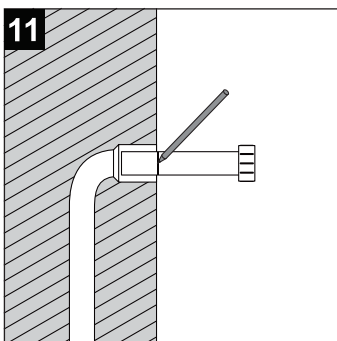
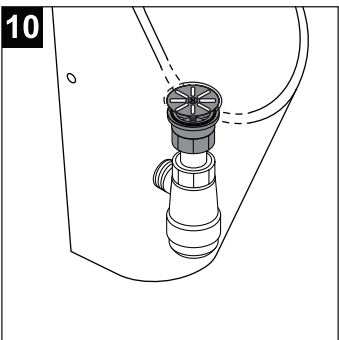
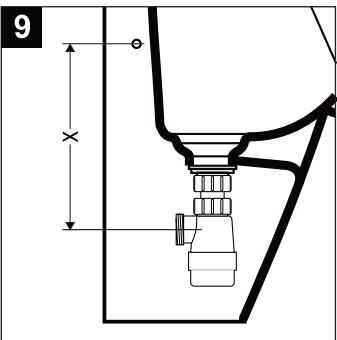
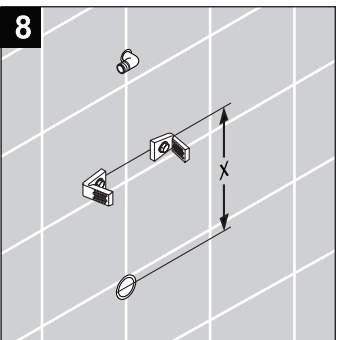
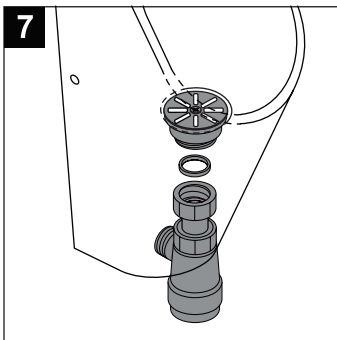
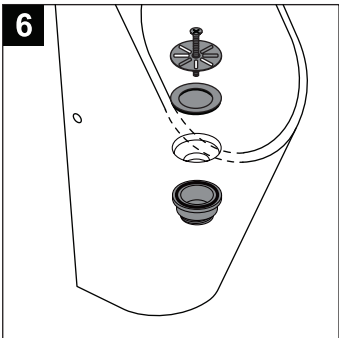

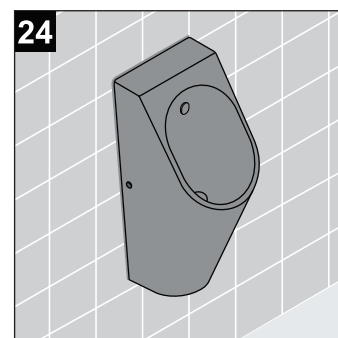
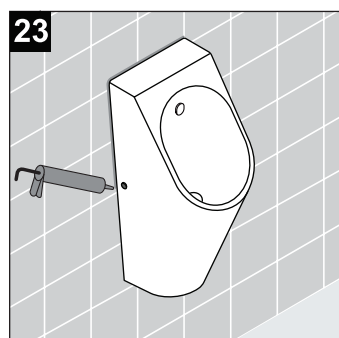
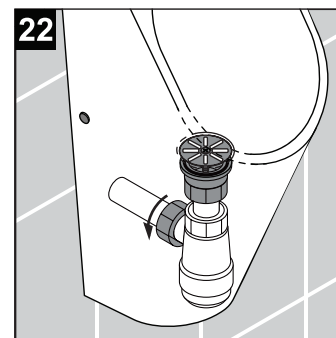
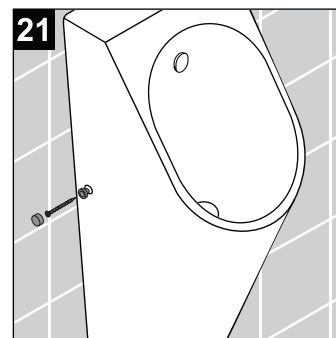
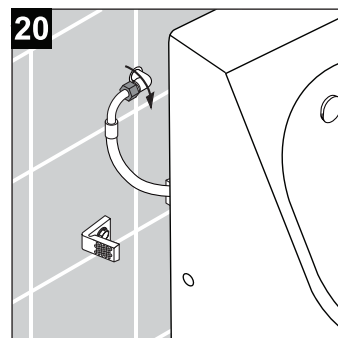
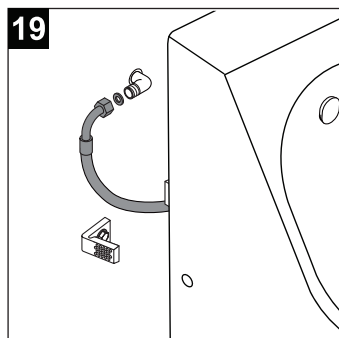
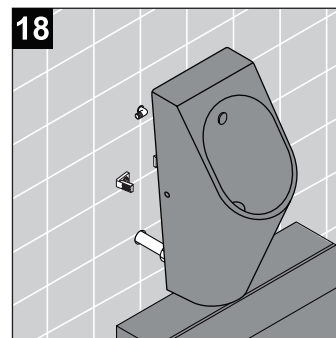
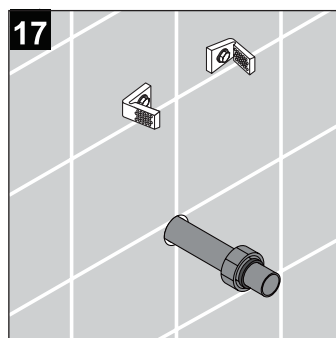
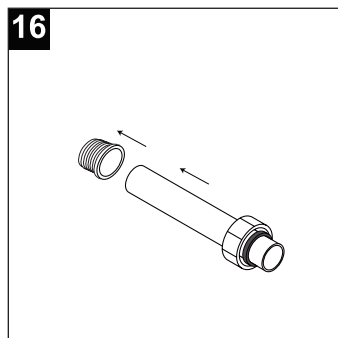
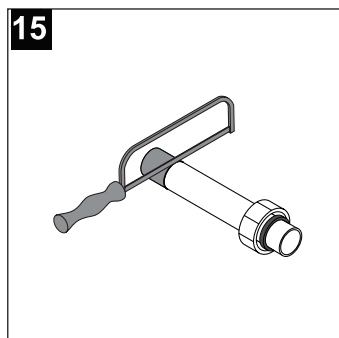

V 17/01/2024

Distributed by:

Plumbline

Exceptional Bathrooms.
Exceptional Choice.

T 04 568 9898 E sales@plumbline.co.nz www.plumbline.co.nz