

# INSTALLATION INSTRUCTIONS

## INSET BASINS

1 - Firstly, cut out the vanity top to suit the chosen inset basin.

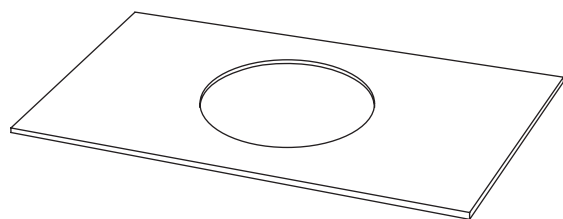

2 - Place the basin down into the cutout.

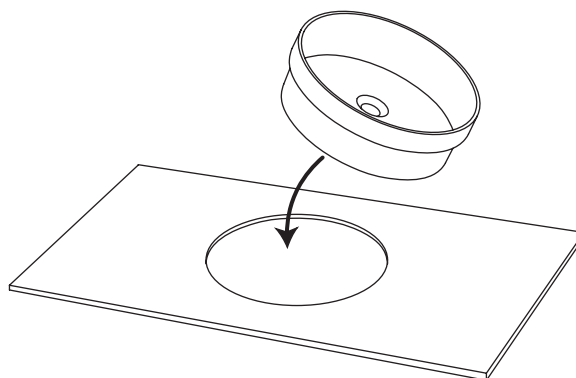

3 - Connect up the the waste and test for any leaks.

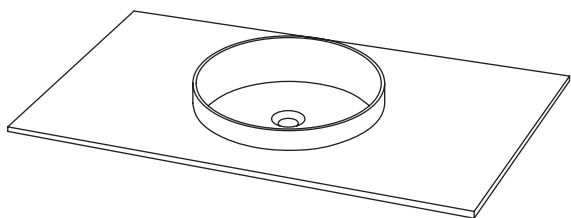

4 - Finally, apply a bead of silicone around the edge of the basin.

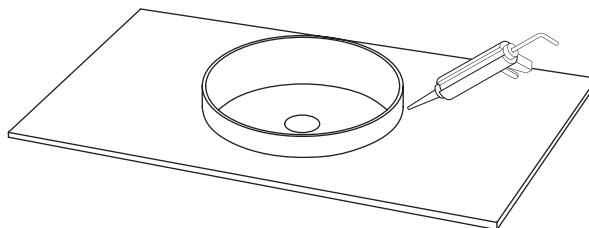

Distributed by:

**Plumblīne**

T 04 568 9898 E [sales@plumblīne.co.nz](mailto:sales@plumblīne.co.nz)  
[www.plumblīne.co.nz](http://www.plumblīne.co.nz)