

INSTALLATION INSTRUCTIONS

TEMPO TIMER VALVE | 232N

progetto
DESIGN COLLECTION

NOTES

- PRIOR TO INSTALLATION, ENSURE YOU HAVE ALL THE REQUIRED PARTS
- THE RECOMMENDED OPERATING PRESSURE IS BETWEEN 0.5 BAR AND 5 BAR
- THE WATER PIPE MUST BE FLUSHED OUT PRIOR TO CONNECTING TO THE VALVE

- 1 - Screw the bracket onto the valve securely.
- 2 - Measure and install sufficient framing and dry fit the valve and bracket, then mark out the mounting holes on the framing.
- 3 - remove the valve from the bracket and fix the bracket in the correct orientation.

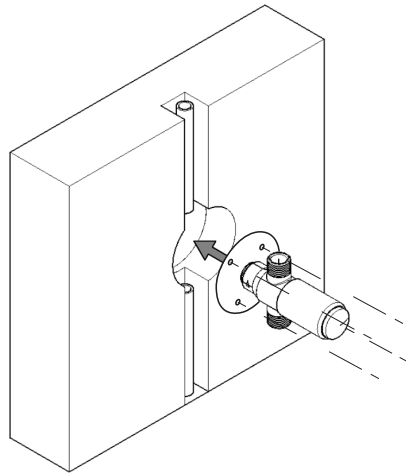
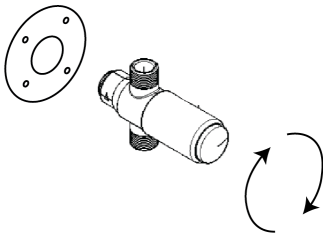

IMPORTANT!

Please read these instructions **prior** to installation

Distributed by:

Plumbline

T 04 568 9898 E sales@plumblin.co.nz
www.plumblin.co.nz

- 4 - Reassemble the valve to the bracket and ensure that the body of the urinal will protude the wall lining sufficiently.
DO NOT HYDDRAULIC TEST THE PLUMBING WITH THE VALVE INSTALLED!
- 5 - Connect inlet and outlet piping (flush first). Test the unit for performance prior to lining the wall.

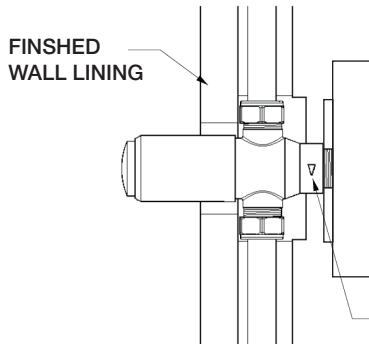
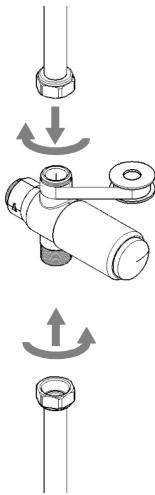

THE WATER FLOW
MUST BE IN THE
SAME DIRECTION
AS THIS ARROW

- 6 - Once the wall has been lined, apply some silicone behind the flange and slide it over the body back to the wall.

