

INSTALLATION INSTRUCTIONS

BOTTLE TRAPS

1 - Firstly, make sure when installing the basin, that the waste hole aligns with the waste outlet. Additionally, ensure that the horizontal and vertical dimensions fall within the specified max/min on the chosen bottle

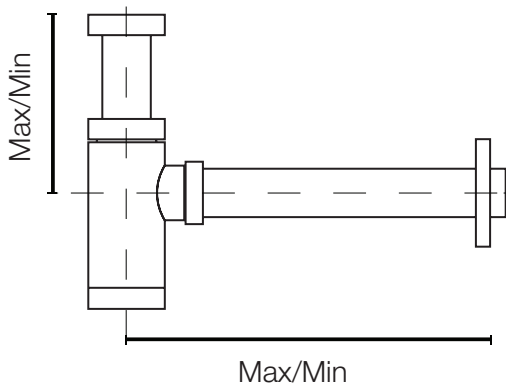

2 - Begin by pushing the horizontal waste pipe back into the wall, using a connector to adapt it to the in-wall piping. Next, slide the tapered washer into the bottle trap and securely tighten it with the locking nut, all the while ensuring that the trap aligns perfectly with the basin

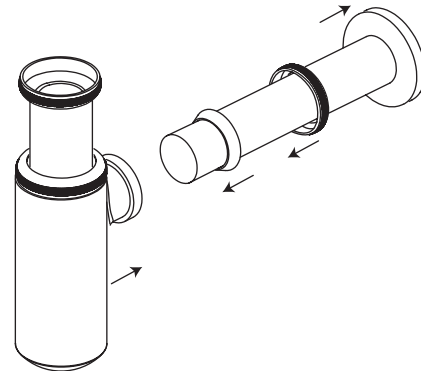

3 - Carefully insert the vertical waste pipe into the internal sleeve.

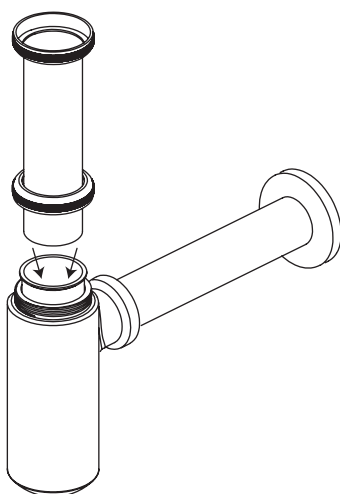

4 - Place the washer between the top locking nut and the basin waste. Then, tighten the locking nut onto the basin waste, followed by tightening the other locking nut onto the bottle trap. This step is crucial to ensure there are no leaks.

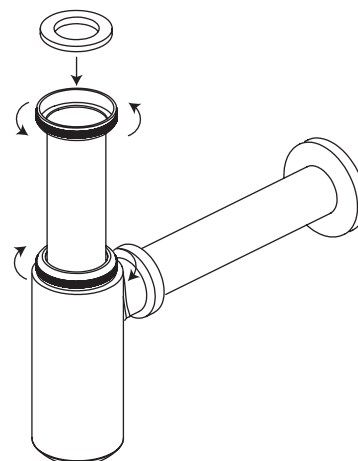

Distributed by:

Plumblin

T 04 568 9898 E sales@plumblin.co.nz
www.plumblin.co.nz