

INSTALLATION INSTRUCTIONS

progetto
DESIGN COLLECTION

NAVONA BASIN MIXER | NV501C
NAVONA VESSEL BASIN MIXER | NV504H
NAVONA SHOWER MIXER | NV520
NAVONA WALL MOUNT MIXER | NV502A
NAVONA 3 HOLE MIXER | NV566
NAVONA FLOOR MOUNT BATH FILLER | NV508A
NAVONA ROBE HOOK | NV010
NAVONA TOILET ROLL HOLDER | NV014
NAVONA TOWEL RAIL 300mm | NV003
NAVONA TOWEL RAIL 550mm | NV004
NAVONA TOILET BRUSH | NV008

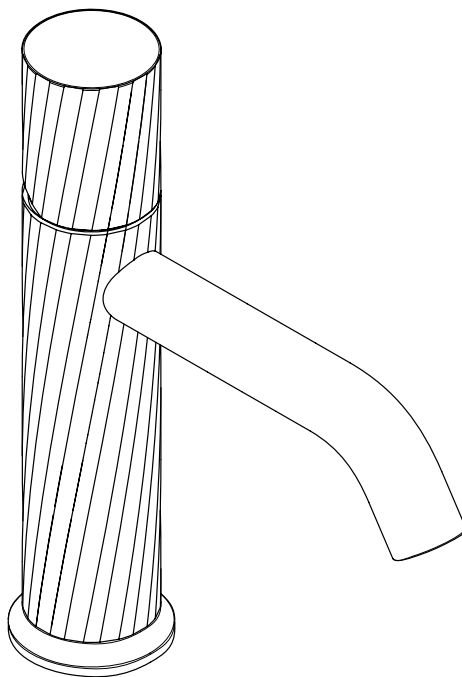

IMPORTANT!

Please read these instructions **prior** to installation

Distributed by:

Plumbline

T 04 568 9898 E sales@plumblin.co.nz
www.plumblin.co.nz

RECOMMENDATIONS FOR INSTALLATION

⚠ ATTENTION: Failure to follow these recommendations may void the warranty. It is recommended that a qualified, licensed tradesperson install this product.

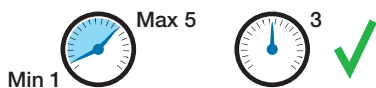

Water Pressure: 3 bar

Product performance cannot be guaranteed if pressure is less than 1 bar. Above 5 bar a pressure regulator must be installed. Failure to do so voids the product warranty.

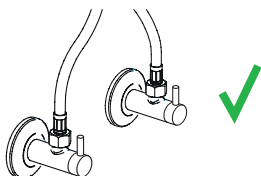

Stop Taps/Filters

Where possible, angle valves are recommended

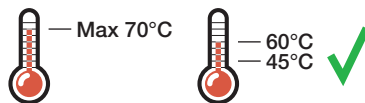

Water Temperature: 45°-65°C

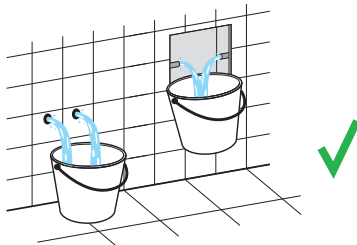

Pre-Flush

Always flush out the pipework before connecting any tapware. Failure to do so voids the product warranty.

Flexible Hoses Installation

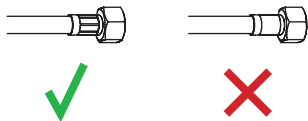

Before installation check that both end fittings of the flexible hoses are well tightened/crimped. If in doubt do not install the flexible hose.

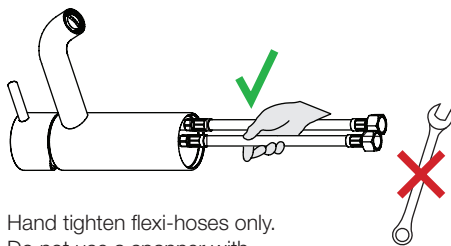

Hand tighten flexi-hoses only. Do not use a spanner with excessive force.

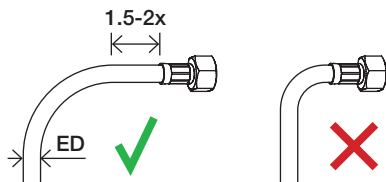

Before any bends ensure there is a straight section of the flexible hose from the hose crimp of at least 1.5-2 times the external (ED) diameter of the hose.

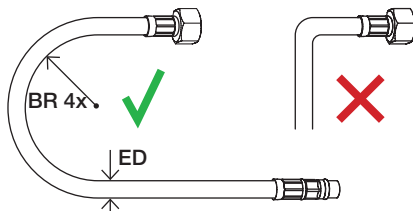

Flexible hose bending radius (BR) should be less than four times the external diameter (ED) of the hose. Do not install with any tension, twists, pinch points or sharp bends/kinks.

CLEANING & MAINTENANCE

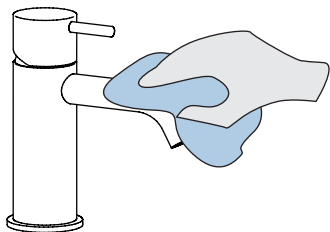

Cleaning

Clean with warm soapy water and a smooth cloth. Avoid abrasive sponges or detergents as these will damage the finish.

To preserve the finish it is recommended to apply a stainless steel oil/mineral oil to the PVD finishes on a monthly basis.

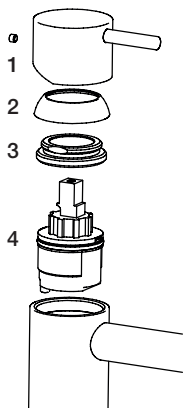

Cartridge Replacement

Before you start, turn off the water supply to the mixer.

1. Remove the handle
2. Unscrew the dome (hand tightened)
3. Unscrew the locking nut
4. Remove the cartridge

Re-assemble in reverse order

 Max tightening torque on locking nut: 10-12 Nm

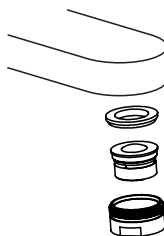

Aerator Maintenance

Remove the aerator, either with a spanner or an aerator cartridge key.

Immerse for half a day in water-vinegar solution (80-20%).

Wash, then reassemble.

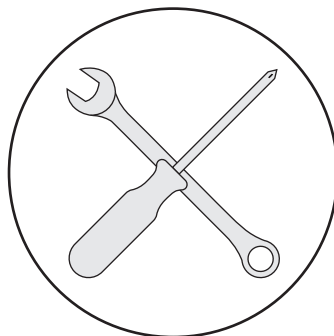

Warranty Information

For full details about our warranty visit plumbline.co.nz/warranty-information

BASIN MIXER & VESSEL BASIN MIXER | NV501C | NV504H

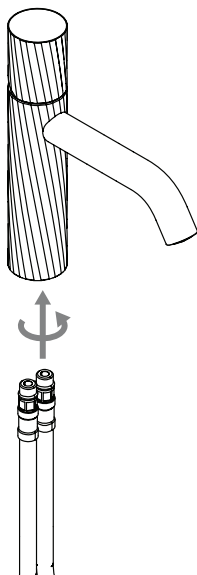

- 1 Insert the flexible hoses, ensuring to hand-tighten them only.

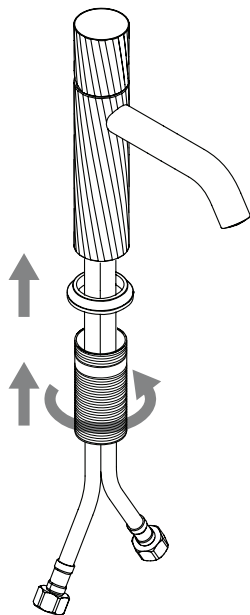

- 2 Sit the base flange in place and fasten the threaded fixing piece into the body of the mixer hand tight.

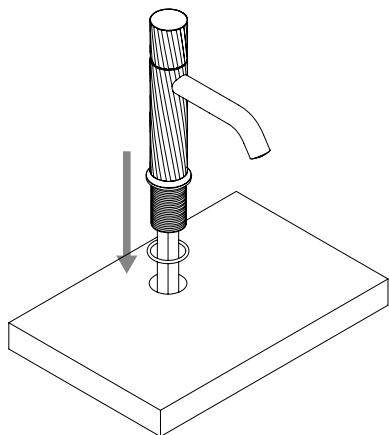

- 3 Insert the O-ring in place, then slide the flexi hoses and the fixing of the mixer down through the taphole.

- 4 Slide the rubber then metal washer up into place. Fasten the fixing nut securely into place using a wrench.

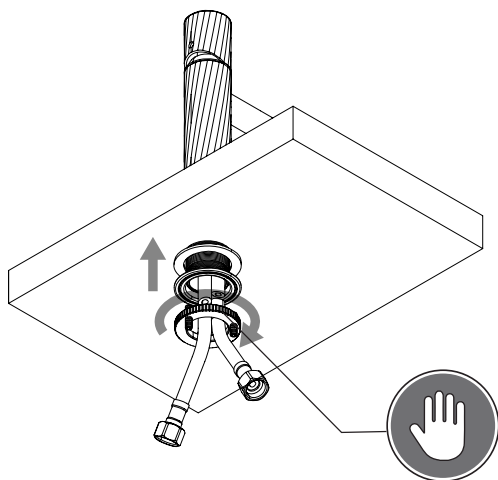

ATTENTION

Two installers are required for this step to avoid damages

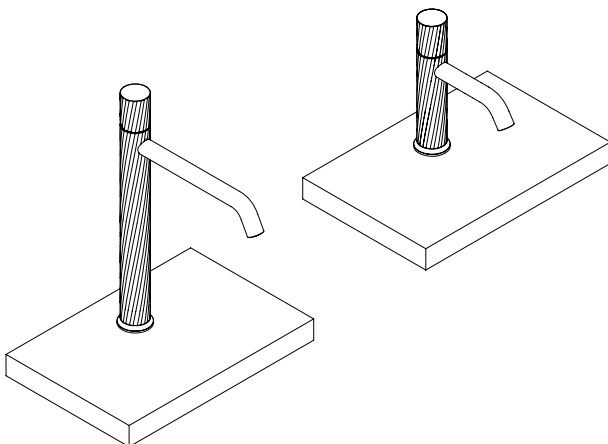
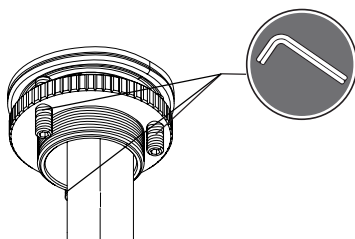

INSTALLATION INSTRUCTIONS

progettø

SHOWER MIXER | NV520

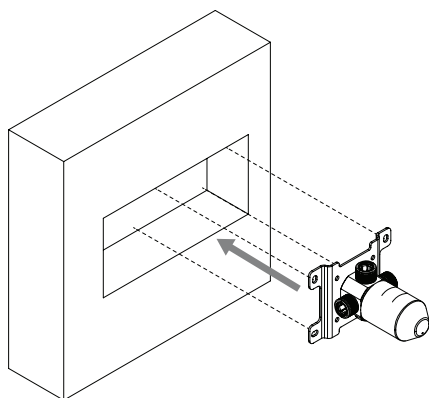

- 1 Fasten the body of the shower mixer into sufficient framing in the wall, it is important to ensure the finished wall lining will be between the min/max shown on the protective sleeve.

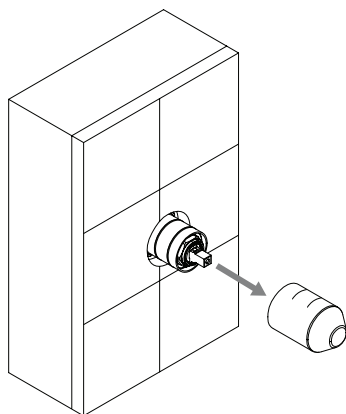

- 2 Connect up both the water inlets and outlet.
Note - Hydraulic pressure test must be carried out prior to mixer installation.

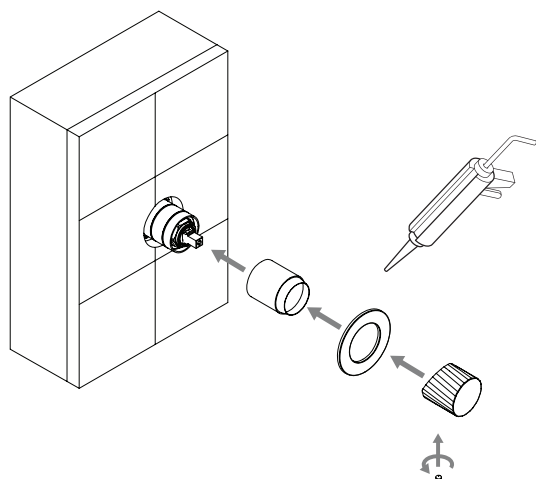

- 3 Once the wall has been lined, remove the protective sleeve from the body of the mixer.
IMPORTANT - Due to the small minimalist design of the flange, please ensure the tiler/wall lining installer is made aware of the flange diameter.

- 4 Insert the barrel cover and apply a bead of silicone behind the flange then slide the flange onto the mixer. Using an allen key, fasten the mixer handle into place.

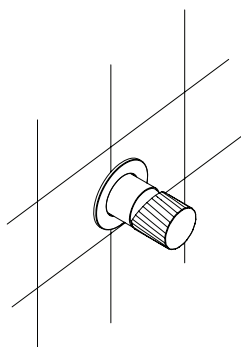

INSTALLATION INSTRUCTIONS

progetto

WALL MOUNT MIXER | NV502A

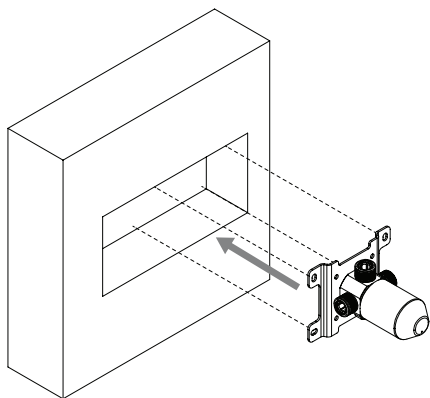

- 1 Fasten the body of the mixer into sufficient framing in the wall, it is important to ensure the finished wall lining will be between the min/max shown on the protective sleeve. Connect up the water inlets and outlet then fasten the wingback (not supplied) into sufficient framing whilst ensuring it is in the correct position.

Note - Hydraulic pressure test must be carried out prior to mixer installation.

IMPORTANT - Due to the small minimalist design of the flange, please ensure the tiler/wall lining installer is made aware of the flange diameter.

- 2 Once the wall has been lined, apply thread sealant tape to the threaded spigot and use an allen key to screw it into place.

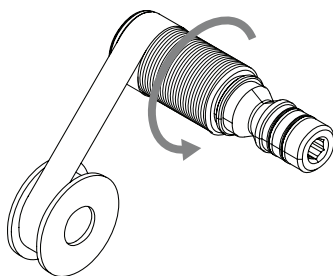
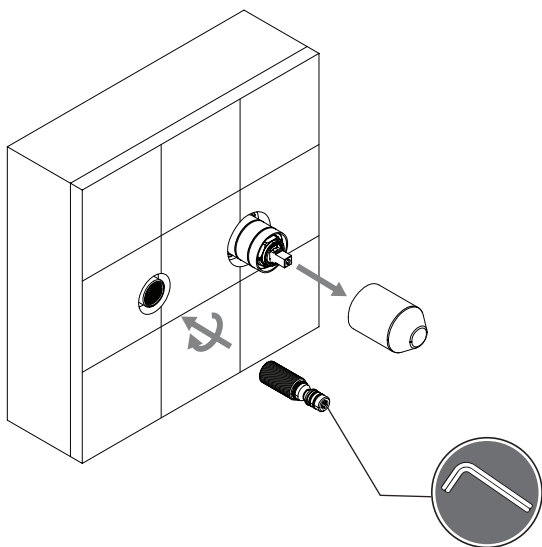

- 3 Once the protective sleeve has been removed, Install all the externals and apply a bead of silicone behind both flanges to ensure no moisture enters the wall cavity.

Note - Prior to installing the spout, remove the grub screw and push the flange along the spout. Re-insert the grub screw once the spout has been pushed back onto the spigot.

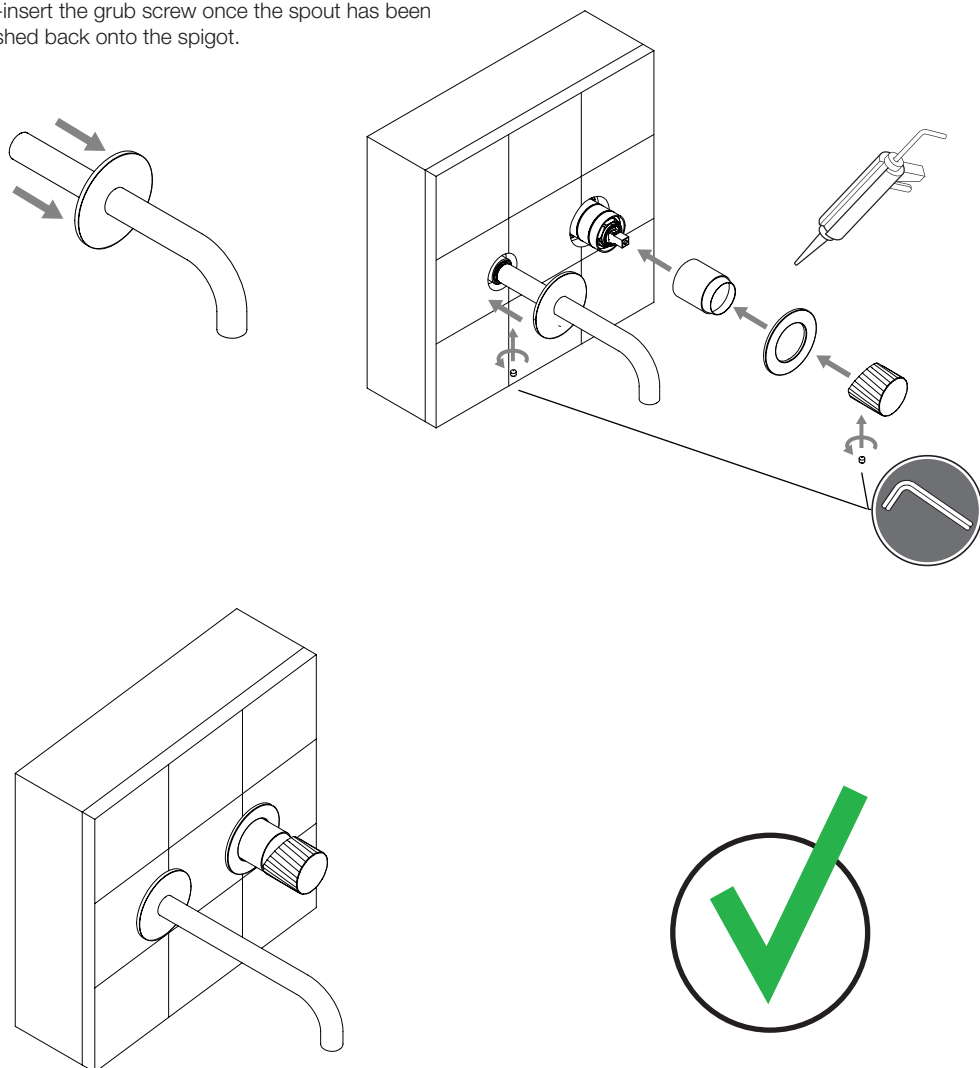

3 HOLE MIXER | NV566

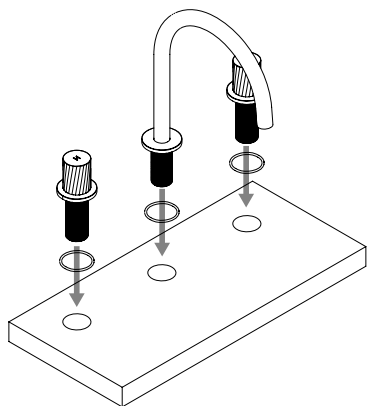

- 1 Insert the tap assembly into the three holes while ensuring the o-rings are in place.

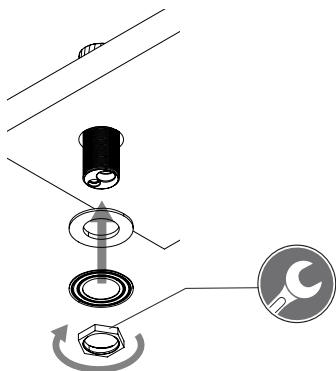

- 2 Slide the rubber then metal washer up into place. Fasten the fixing nut securely into place using a wrench. Repeat this process with the spout and the other tap.



ATTENTION

Two installers are required for this step to avoid damages

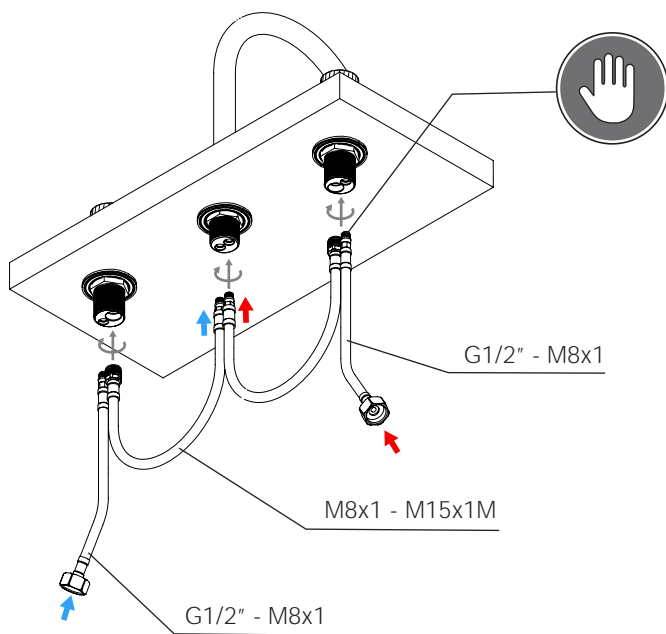

- 3 Insert the flexible hoses as shown in the drawing above.

Note:

G1/2" - M8x1 must be used to connect the water inlets to the hot/cold taps.

M8x1 - M15x1M flexible hoses must be used to connect hot/cold taps to the spout.



- 1 Prior to installation it is very important to ensure that the finished floor level will sit between the min and max on the distributor body indication sticker.

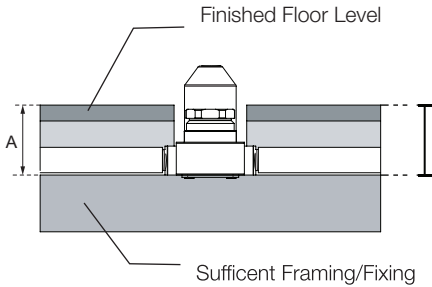

Refer website spec drawing for min/max floor level.

- 2 Fix down the 2-way distributor ensuring this is sufficiently fastened.

For wooden floors, install sufficient framing at the correct depth to fasten the distributor down to.

For concrete floors, a small slurry may be needed to achieve the correct mounting depth.

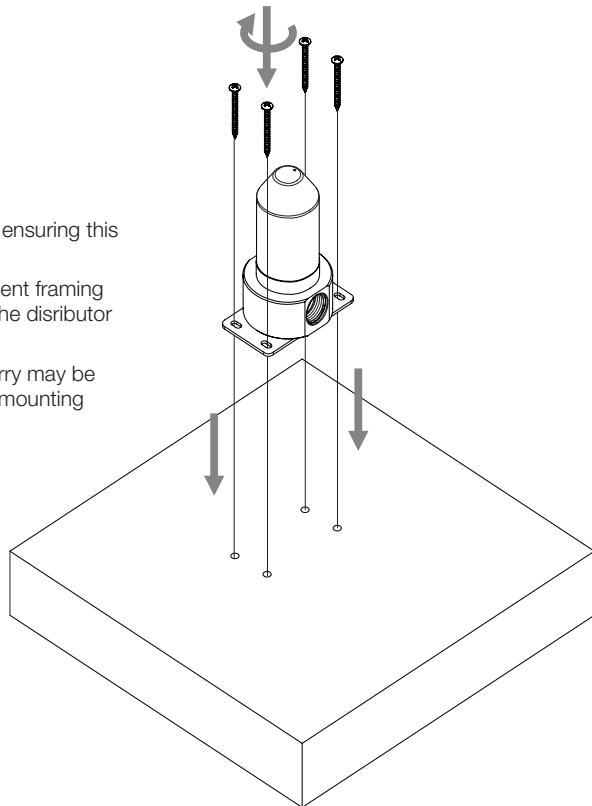

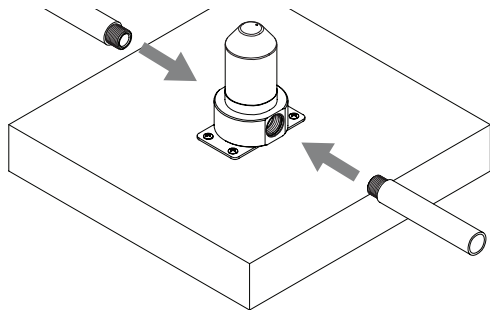

- 3** Connect the hot and cold water inlets to the distributor body. Then prior to the distributor being enclosed by the flooring, pressure test the unit to ensure there are no leaks this pressure must not exceed 1500kpa.

IMPORTANT - This test must be done with the plugs and caps (shown in step 5) inserted.

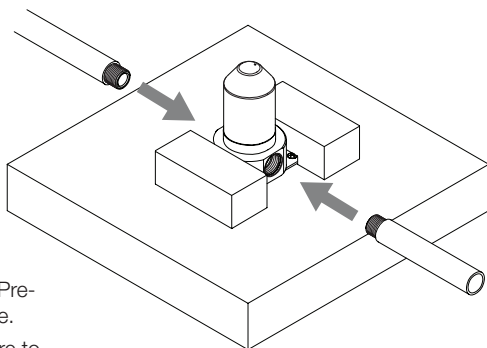

- 4** Once the finished floor level is complete Pre-drill the fixing holes for the mounting plate.

IMPORTANT! This must be done with care to ensure the water inlet piping is avoided.

IMPORTANT! These holes must be drilled into sufficient framing as this fixing plate is what will secure the bath filler in place.

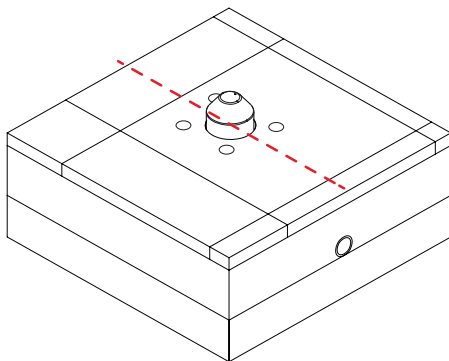
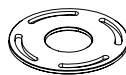
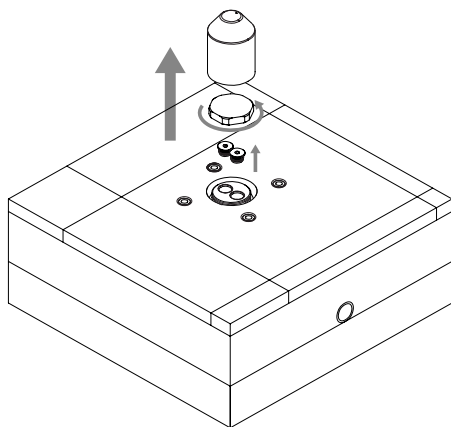

- 5** Remove the protective sleeve, the brass cap and water inlet plugs.

- 6 Connect up the water inlet assembly to the flexi hoses, then screw this assembly up into the leg of the bath filler.

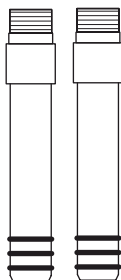
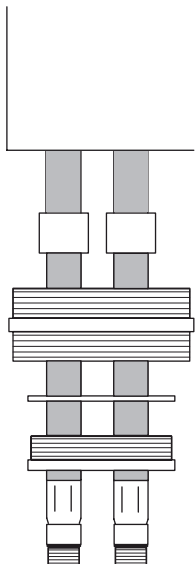

- 7 Slide the base flange up the leg of the bath filler, screw the fixing plate onto the underside of the connecting thread.

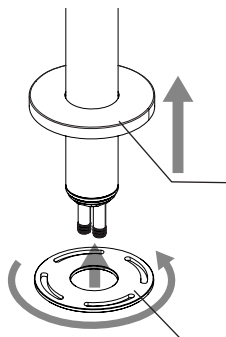

- 8 Rotate the bath filler to the desired position and fasten it down to the floor while ensuring the fixing screws are away from the water inlets.

IMPORTANT - Apply a bead of silicone around the edge of the flange to ensure the waterproofing isn't compromised.

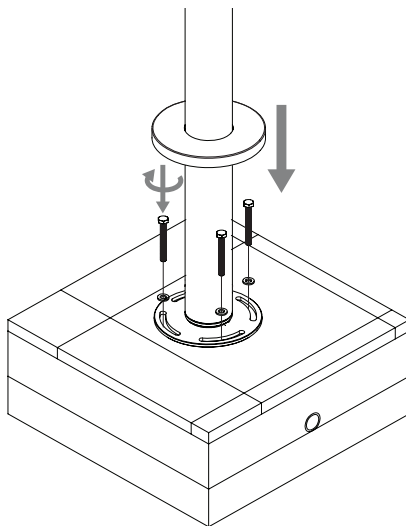

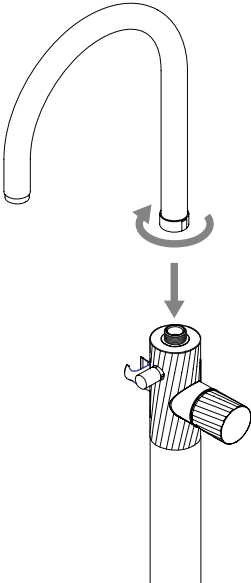

- 9 To fix the spout in place, insert this onto the body of the bath filler then tighten it with the locking nut.

- 10 Finally, connect up the hose and handpiece, then test for performance.

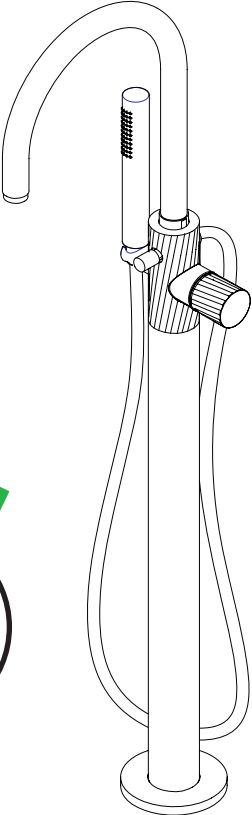
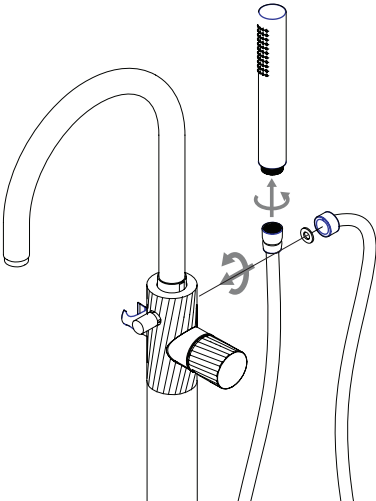

ACCESSORIES FIXING KIT

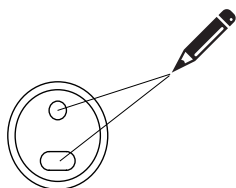

- 1 Use the fixing bracket as a template to locate the two fixing points. When fastening these through tiles, the tiles must be pre-drilled.

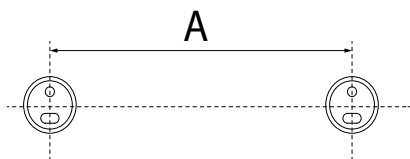

- 2 If installing a towel rail, mark out fixing centres ensuring it is level.

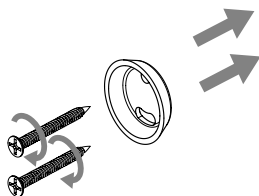

- 3 Fasten the fixing bracket to the wall, **IMPORTANT** - this must be fixed into sufficient framing.



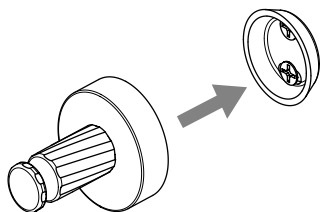

- 1 Place the robe hook/toilet roll holder onto the fixing and find the correct orientation.

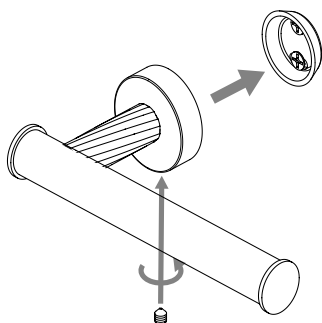

- 2 Once in the correct orientation fasten the locking screw to lock it in place.

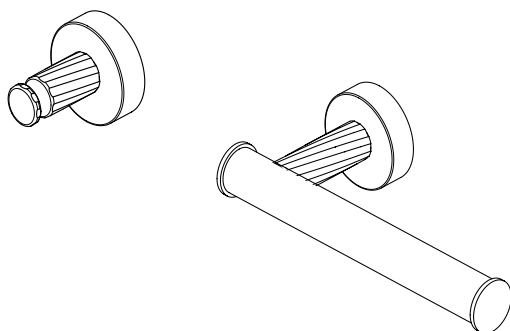

INSTALLATION INSTRUCTIONS

progettò

ROBE TOWEL RAILS | NV003 | NV004

- 1 Insert the rail between the two fixing legs.

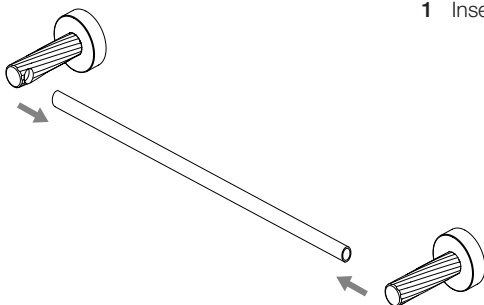

- 2 Push the rail back to the wall and fasten the two locking grub screws to lock it into place.

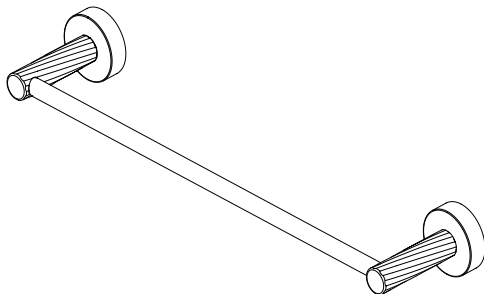
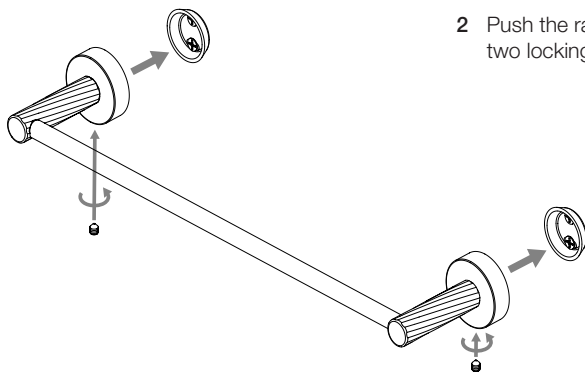

INSTALLATION INSTRUCTIONS

progettø

ROBE TOILET BRUSH | NV008

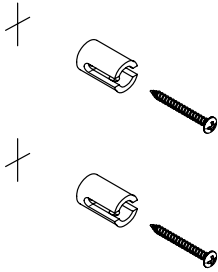

- 1 Fasten the two fixings onto the wall into sufficient framing, ensuring they are sitting plumb.

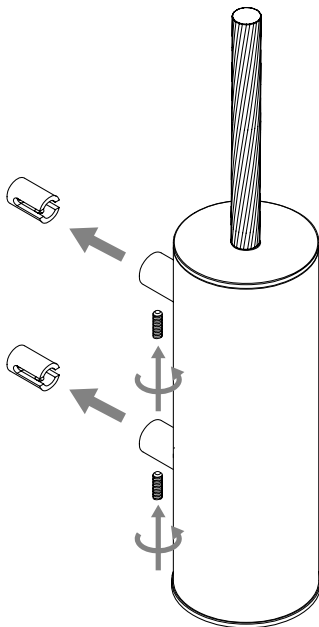

- 2 Push the toilet brush holder back onto the fixing and tighten the locking screws, this will splay out the fixing thus causing it to lock onto the wall.