

### HOW TO STOP THE SLIDER FROM FALLING DOWN THE RAIL

- 1 - Slide the slider to the bottom of the rail.
- 2 - Loosen the handle (D) off the slider.
- 3 - Tighten the brass nut (C), note - this does not need to be too tight.
- 4 - Screw the handle (D) back onto the brass nut (C).

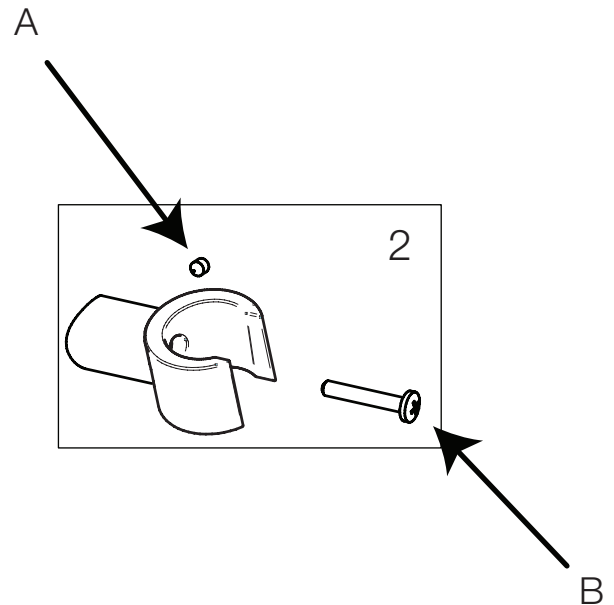

### HOW TO TIGHTEN HANDSHOWER HOLDER

- 1 - Loosen the locking grub screw (A) with an allen key.
- 2 - Tighten the centre draw bolt (B)
- 3 - Tighten the locking grub screw (A), this is to lock the draw bolt in place.

### REPLACEMENT PARTS

- A - M4X4 grub screw (Code - M4X4)
- B - Centre draw bolt (Code - M307-17)
- 1 - Plastic slider insert (Code - M307.013)
- 2 - Handepiece holder, centre draw bolt & M4X4 grub screw (Code - M307-006.xx (xx - finish))