

# INSTALLATION INSTRUCTIONS

## ACRYLIC INSET BATHS

progetto  
DESIGN COLLECTION

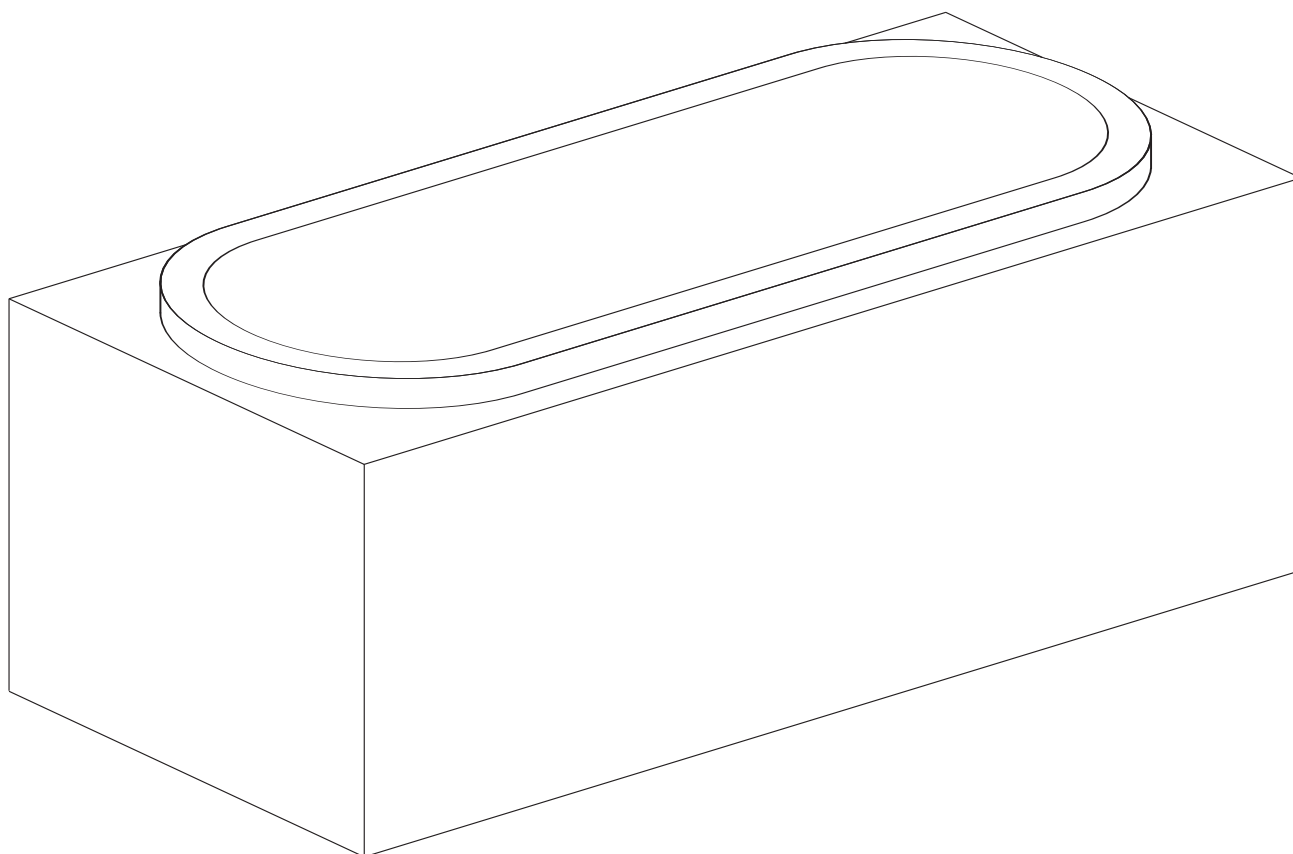

### IMPORTANT!

Please read these instructions **prior** to installation

Distributed by:

**Plumblin**e

T 04 568 9898 E [sales@plumblin.co.nz](mailto:sales@plumblin.co.nz)  
[www.plumblin.co.nz](http://www.plumblin.co.nz)

## Care & Conditions Of Use

Clean your bath with a damp cloth and a non-abrasive liquid cleaner. Stubborn stains and scratches can be removed with a light application of Brasso or a similar cutting compound. Avoid abrasive cleaners, solvents, heat and sharp objects. The use of cleaners incorporating ingredients which have been identified as harmful effects on acrylic will void the warranty.

### NOTE TO THE OWNER/USER:

This product is made from a durable & robust material that will give you years of use. However please note the following to avoid damage to your product:

- After each use thoroughly clean the surface with warm soapy water.
- Before applying cleaning products to the surface carefully read all instructions first.
- Do not use products that contain:
  - Alcohol
  - Solvents
  - Hair dye
  - Acetone
  - Bleach
  - Bath oils/salts
  - Abrasives
  - Citrus based chemicals
- Do not allow water temperature to exceed above 55°C.

---

## General Installation Instructions

### IMPORTANT

Please unwrap the bath and check it carefully to ensure it has not been damaged during handling or transport, and check that all parts have been supplied.

It is recommended that the bath is assembled (if required) on a mat to protect against damage to the bath surface. Store the bath in a safe place until you begin installation.

Installation should be carried out by a qualified, licensed tradesperson.

### WASTE AND TRAP

For ease of install we recommend the top fix waste and low profile trap shown below.

**Progetto Top Fix Pop  
Up Bath Waste 40mm**  
900075



**Silfra Low Profile Bath  
Trap**  
AS078K



1. Install waste pipe in accordance with the set out. Check the waste pipe will align accurately with bath waste. This bath must be installed with a top fix waste.
2. Create a frame for the bath to sit inside, constructed from wood, masonry or steel. this bath is not self supporting and requires a bed of sand/cement slurry to support the base of the bath.
3. Once the wall has been lined, place the bath in position and connect the top fix waste.
4. Fill the bath and then release, checking seals for leaks and that the bath drains successfully.
5. Apply flexible sealant to the exposed edges.

**IMPORTANT!**

Avoid tiling over the bath or tiling it in as this will void warranty.

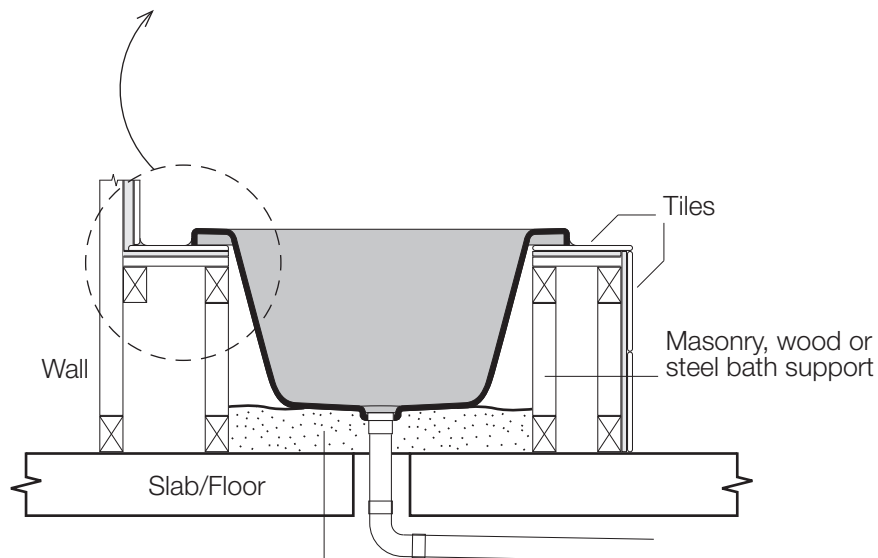
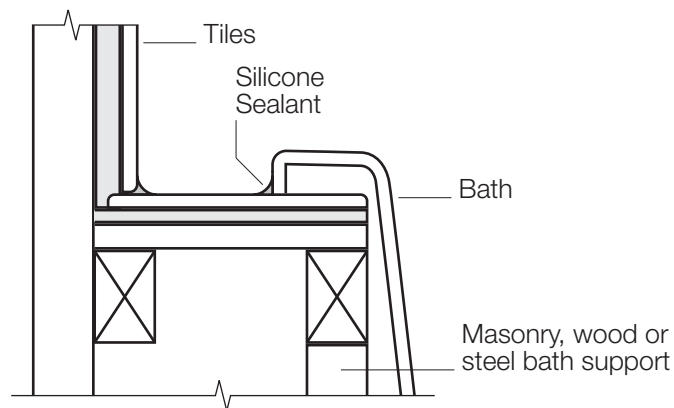

**IMPORTANT!**

This bath is not self supporting and does require a bed of sand/cement slurry.

## Warranty Information

- Acrylic Baths: TEN (10) Year warranty from date of purchase.

Plumblin will undertake to replace free of charge any faulty product due to defects in materials or manufacturer workmanship within the warranty period (Proof of purchase must be retained). Plumblin will also cover labour costs within 2 years of purchase for the replacement or repair of any Plumblin supplied product that is deemed by Plumblin technicians to be faulty or defective.

Plumblin (or their approved retailer) reserve the right to assess, repair, replace or service any warranty claims as they see fit.

The above warranties are upheld providing the products have been used for normal domestic only and exclude any defect or injury caused by or resulting from misuse, abuse or neglect, accidental damage, improper installation or other alterations or modifications which affect the reliability or performance of the item not attributed to faulty manufacture. The above warranties do not apply to the replacement of products where damage is caused by normal wear and tear, where the hot water temperature exceeds 55°C or where the warranty claim has not been notified to Plumblin (or their approved retailer) within ninety (90) days of the problem first appearing.

The above warranties do not include consequential loss or damage due to the product.

**IMPORTANT NOTE: This warranty does not cover the removal/replacement of tiles/wall liners where the bath has been tiled or fitted 'into' the wall.**