

# INSTALLATION INSTRUCTIONS

COASTAL OUTDOOR WALL MOUNT RAINHEAD | CL235.316

progetto  
DESIGN COLLECTION

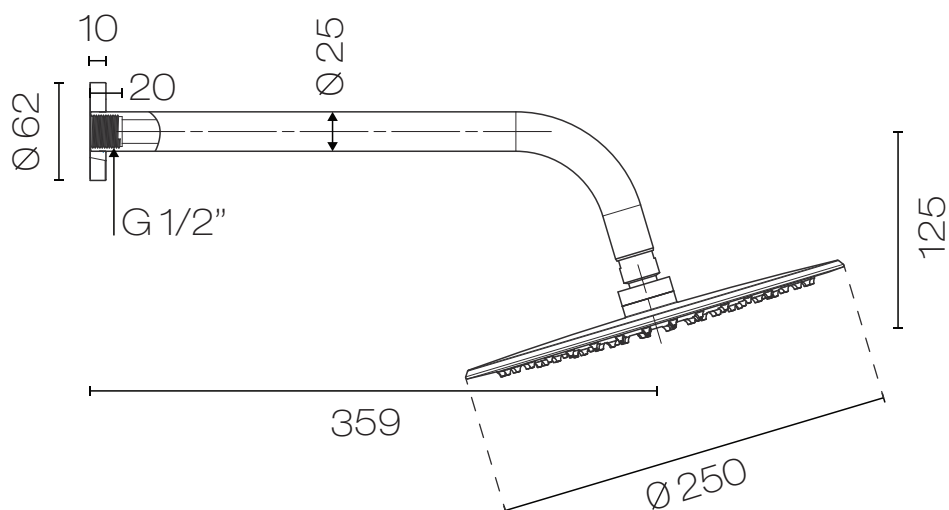

Distributed by:

**Plumblīne**

Exceptional Bathrooms.  
Exceptional Choice.

T 04 568 9898 E sales@plumblīne.co.nz [www.plumblīne.co.nz](http://www.plumblīne.co.nz)

## Before your installation

### 1. WARNING

Read all the instructions completely proceeding. Plumblinc recommends calling a professional if you are uncertain about installing this product!

This product should be installed in accordance with all local and state plumbing and building codes.

### 2. SHUT OFF WATER SUPPLY

Locate water supply inlets and shut off the water supply valves. These are usually found near the water meter. If you are replacing an existing unit, remove the old unit and clean the mounting surface thoroughly.

### 3. TOOL RECOMMENDED

- \* Screwdriver
- \* Adjustable wrench
- \* PTFE tape
- \* Hexagon wrench

Your installation will require a pipe for the spout installation as well as other additional tools.



## Installation Procedures

1. All pipework must be thoroughly flushed prior to the installation of the shower.
2. Clean the exposed thread and bind clockwise with Thread Sealing tape.
3. Fit Wall Plate to arm and screw new Shower Arm (clockwise) onto exposed inlet thread.
4. Screw 250mm Shower Head onto Shower Arm and tighten with Adjustable Spanner.

Step.1



Step.2

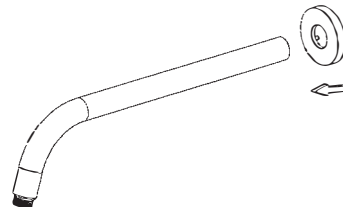

Step.3

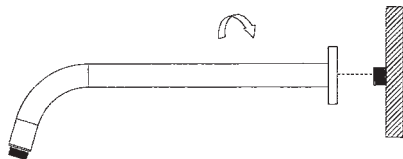

Step.4

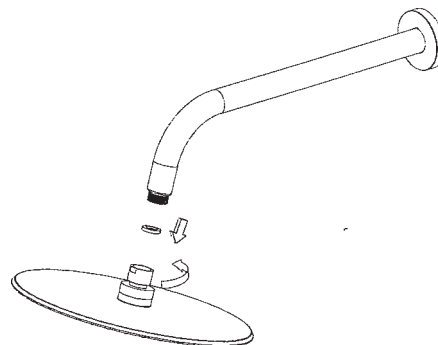

## Replacement Parts:

Keep this manual for ordering replacement parts

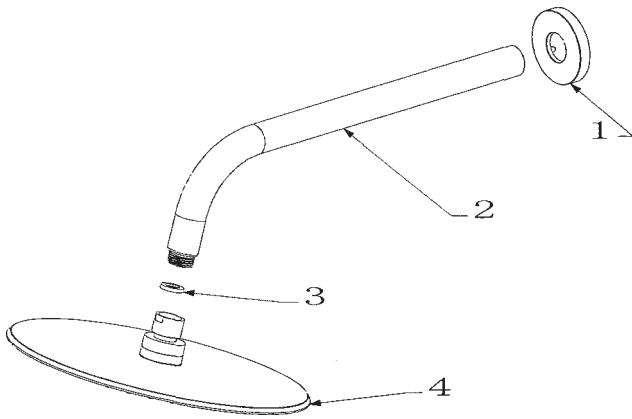

- 1.Flange cover
- 2.Rail tube
- 3.Rubber flat washer
- 4.Head shower

## Product Maintenance

1. Since this product is totally made of stainless steel so it does not have the electroplating surface treatment. To preserve the brightness of the metal brush finish, apply non-abrasive wax or oil based cleaner with clean cloth on the surface of your faucet. Any cleaners should be rinsed off immediately.
2. If the product surface scars due to impact damage, you can use soft sand paper to polish the surface in a circular way to remove the scratches. The polishing treatment will keep the original brightness and the brush finish of the metal.
3. Please wipe it with a soft clean cloth after use in order to keep the brightness and the metal.

## Warranty Information

Coastline Warranty: Two (2) Year warranty on all non-chrome finished tapware from date of purchase. Due to manufacturer's conditions, the warranty on ceramic cartridges, headworks, working parts & flexible hoses is One (1) Year from date of purchase.

Plumblinc will undertake to replace free of charge any faulty product due to defects in materials or workmanship within the warranty period (Proof of purchase must be retained). Plumblinc will also supply parts and labour costs for the replacement or repair of any faulty product within One (1) Year of installation date.

Plumblinc (or their approved retailer) reserve the right to assess, repair, replace or service any warranty claims as they see fit.

The above warranties are upheld providing the products have been used for normal domestic only and exclude any defect or injury caused by or resulting from misuse, abuse or neglect, accidental damage, improper installation or other alterations or modifications which affect the reliability or performance of the item not attributed to faulty manufacture. The above warranties do not apply to the replacement of products where damage is caused by normal wear and tear, the water pressure is outside the recommended levels, where the hot water temperature exceeds 55°C or where the warranty claim has not been notified to Plumblinc (or their approved retailer) within ninety (90) days of the problem first appearing.

The above warranties do not include consequential loss or damage due to the product.