

INSTALLATION INSTRUCTIONS

COASTAL OUTDOOR SHOWER COLUMN | CL225.316

progetto
DESIGN COLLECTION

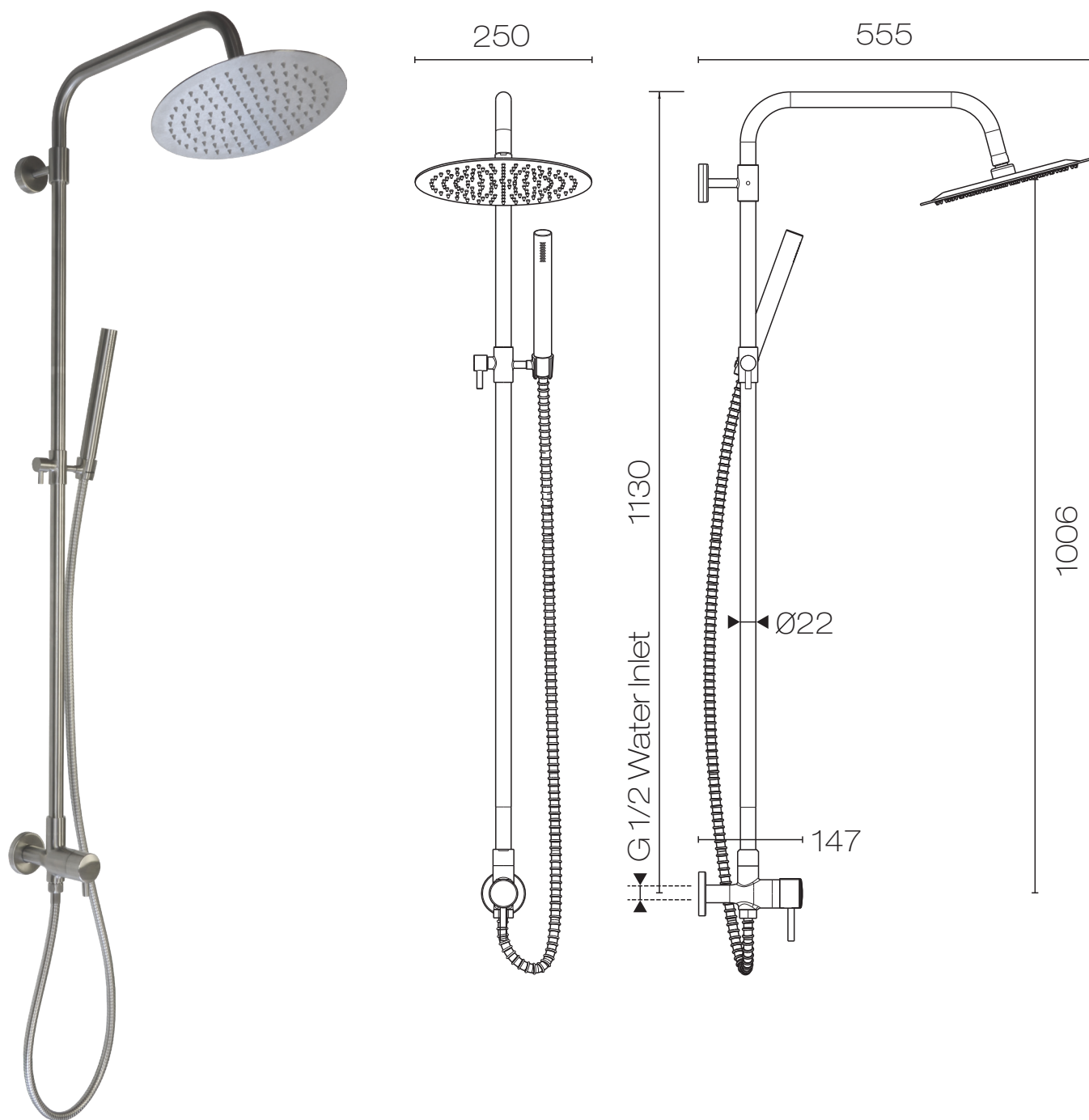

Distributed by:

Plumblīne

Exceptional Bathrooms.
Exceptional Choice.

T 04 568 9898 E sales@plumblīne.co.nz www.plumblīne.co.nz

Before your installation

1. WARNING

Read all the instructions completely proceeding. Plumline recommends calling a professional if you are uncertain about installing this product!

This product should be installed in accordance with all local and state plumbing and building codes.

2. SHUT OFF WATER SUPPLY

Locate water supply inlets and shut off the water supply valves. These are usually found near the water meter. If you are replacing an existing unit, remove the old unit and clean the mounting surface thoroughly.

3. TOOL RECOMMENDED

- * Screwdriver
- * Adjustable wrench
- * PTFE tape
- * Hexagon wrench

Your installation will require a pipe for the spout installation as well as other additional tools.



Installation Procedures

Step.1 Hot and cold pipes embedded in the wall.

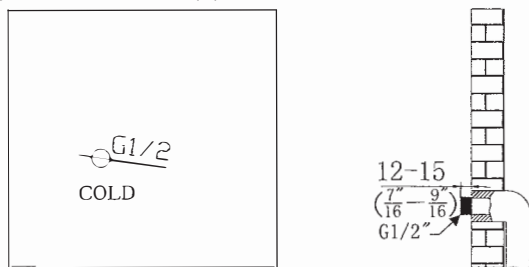

Step.2 Open the water, check the water flow is normal.

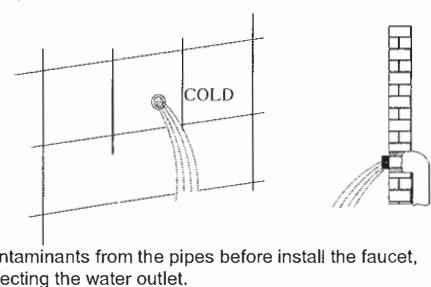

Step.3 Prepare the body of the shower.

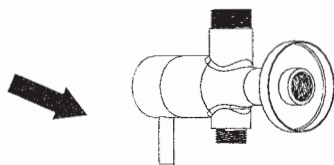

Step.4 Twining the PTFE tape on the G1/2 teeth of the in-wall tube.

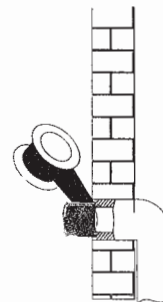

Step.5 Screw the faucet body on the in-wall tube, Be sure to have a flat gasket on the elbow.

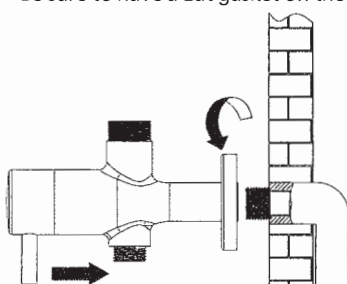

Step.6 Check the installation is normal.

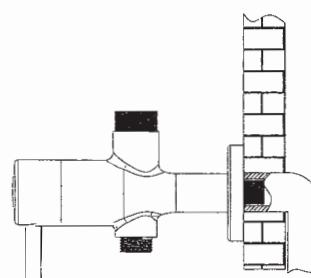

Installation Procedures

Step.7 Connect the main rod.

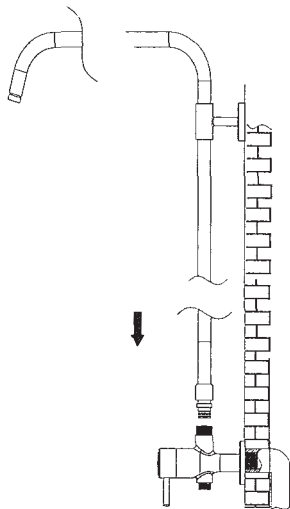

Step.8 Confirm the position punch.

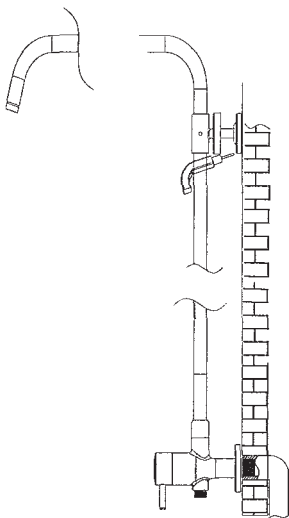

Step.9 Position punch.

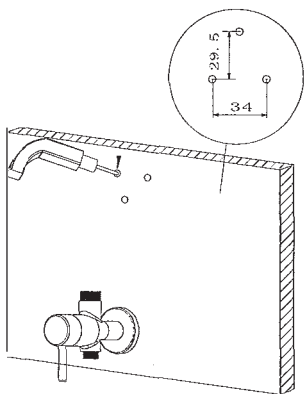

Step.10 Insert the plastic anchor.

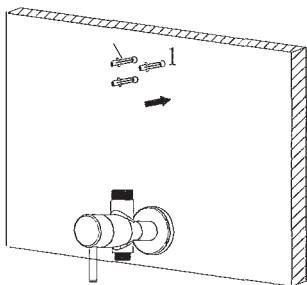

Step.11 Connect the main rod, Lock the decorative cover.

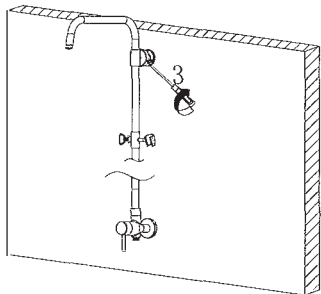

Step.12 Flow controller & rubber flat washer.

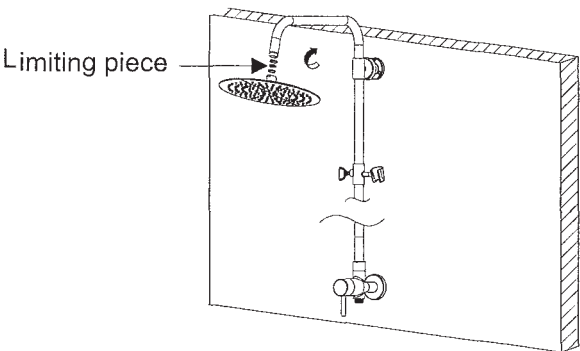

Step.13 Connect the stainless steel hose and handle shower.

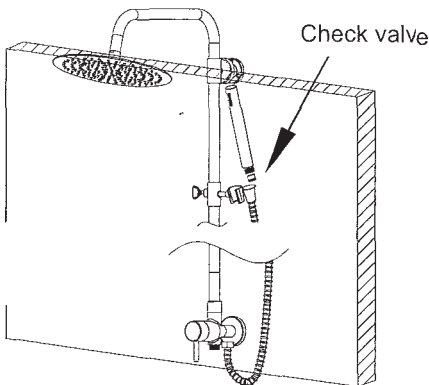

Replacement Parts:SSB-120-1

Keep this manual for ordering replacement parts

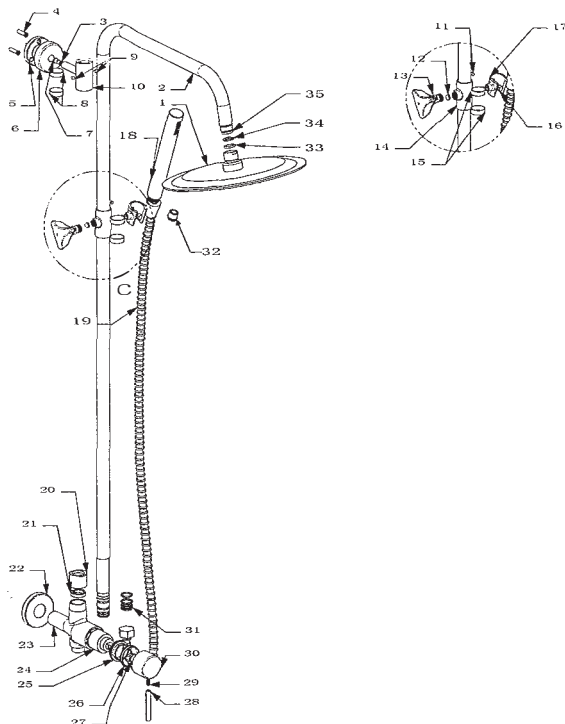

- | | | |
|---------------------------|-------------------------------|-------------------------------|
| 1.250mm showerhead | 13.Body of handle | 25.Retaining nut |
| 2.Rail tube | 14.Handle shower fixed sleeve | 26.Cover of cartridge |
| 3.Spring washers | 15.POM clip | 27.Plastic cover of cartridge |
| 4.Screw/Plastic anchor | 16.Rubber pad | 28.Body of handle |
| 5.Wall mount bracket base | 17.Socket | 29.Inner hexagon screw |
| 6.Wall mount bracket | 18.Handshower | 30.Cap of handle |
| 7.Screw | 19.Shower hose | 31.Rubber sealing ring |
| 8.POM clip | 20.Fixed sleeve | 32.Check valve |
| 9.Inner hexagon screw | 21.POM clip | 33.Rubber flat washer |
| 10.Fixed sleeve | 22.Dress ring | 34.Flow regulator |
| 11.Nut | 23.Body | 35.Rubber flat washer |
| 12.Rubber flat washer | 24.33mm cartridge | |

Inspection After Installation

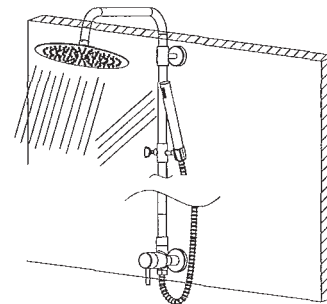

Ensure that all the connections have been tightened, the handle in the closed state, turn on the water sources, inspect and repair the leaking connectors. If the tap is leaking, please see the right side of this page for maintenance method.

In order to make sure of proper installation, you need to remove the Hose Washer Cap, Hose Washer, and the spacer, and then switch the handle back and forth for cold and warm water running. Let the water runs for about one minute to see whether there is any leaking, if there is no leaking, then install back the three parts you just removed.

Change The Valve

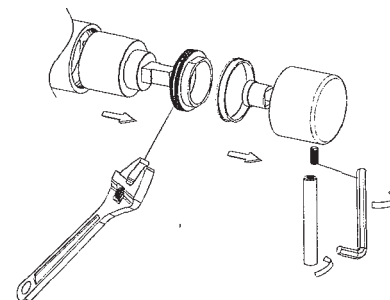

If there is any leaking from the faucet head, please shut down the main water line and change the valves according to the graph

Product Maintenance

- Since this product is totally made of stainless steel so it does not have the electroplating surface treatment. To preserve the brightness of the metal brush finish, apply non-abrasive wax or oil based cleaner with clean cloth on the surface of your faucet. Any cleaners should be rinsed off immediately.
- If the product surface scars due to impact damage, you can use soft sand paper to polish the surface in a circular way to remove the scratches. The polishing treatment will keep the original brightness and the brush finish of the metal.
- Please wipe it with a soft clean cloth after use in order to keep the brightness and the metal.

Warranty Information

Coastline Warranty: Two (2) Year warranty on all non-chrome finished tapware from date of purchase. Due to manufacturer's conditions, the warranty on ceramic cartridges, headworks, working parts & flexible hoses is One (1) Year from date of purchase.

Plumbline will undertake to replace free of charge any faulty product due to defects in materials or workmanship within the warranty period (Proof of purchase must be retained). Plumbline will also supply parts and labour costs for the replacement or repair of any faulty product within One (1) Year of installation date.

Plumbline (or their approved retailer) reserve the right to assess, repair, replace or service any warranty claims as they see fit.

The above warranties are upheld providing the products have been used for normal domestic only and exclude any defect or injury caused by or resulting from misuse, abuse or neglect, accidental damage, improper installation or other alterations or modifications which affect the reliability or performance of the item not attributed to faulty manufacture. The above warranties do not apply to the replacement of products where damage is caused by normal wear and tear, the water pressure is outside the recommended levels, where the hot water temperature exceeds 55°C or where the warranty claim has not been notified to Plumbline (or their approved retailer) within ninety (90) days of the problem first appearing.

The above warranties do not include consequential loss or damage due to the product.