

INSTALLATION INSTRUCTIONS

FLOOR MOUNT BATH FILLER & HANDSHOWER

progetto
DESIGN COLLECTION

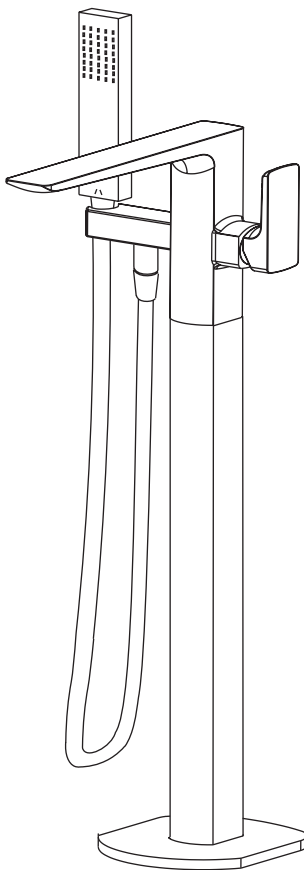

IMPORTANT!

Please read these instructions **prior** to installation

Distributed by:

Plumbline

T 04 568 9898 E sales@plumblin.co.nz
www.plumblin.co.nz

RECOMMENDATIONS FOR INSTALLATION



ATTENTION: Failure to follow these recommendations may void the warranty.
It is recommended that a qualified, licensed tradesperson install this product.

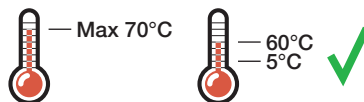
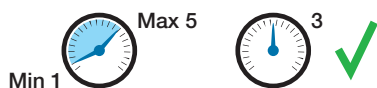

Water Pressure: 3 bar

Product performance cannot be guaranteed if pressure is less than 1 bar. Above 5 bar a pressure regulator must be installed. Failure to do so voids the product warranty.

Water Temperature: 5° - 60°C

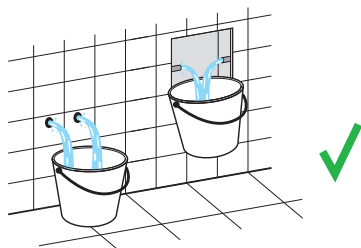

Pre-Flush

Always flush out the pipework before connecting any tapware. Failure to do so voids the product warranty.

CLEANING & MAINTENANCE

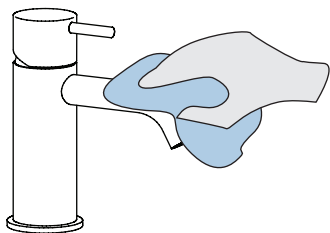

Cleaning

Clean with warm soapy water and a smooth cloth. Avoid abrasive sponges or detergents as these will damage the finish.

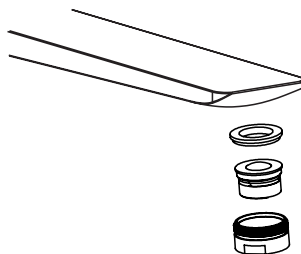

Aerator Maintenance

Remove the aerator with an aerator cartridge key. Immerse for half a day in water-vinegar solution (80-20%).

Wash, then reassemble.

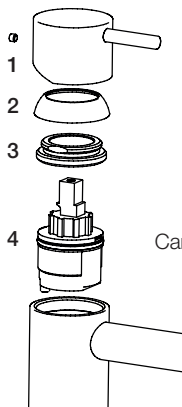

Cartridge code: 35A

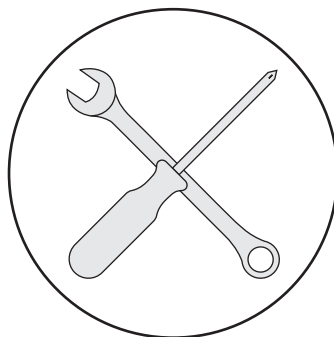

Cartridge Replacement

Before you start, turn off the water supply to the mixer.

1. Remove the handle
2. Unscrew the dome (hand tightened)
3. Unscrew the locking nut
4. Remove the cartridge

Re-assemble in reverse order

⚠ Max tightening torque on locking nut: 10-12 Nm

Warranty Information

For full details about our warranty visit plumbline.co.nz/warranty-information

No.	Name	Qty
1	Mixer Body	1
2	Flange	1
3	Mounting Plate	1
4	Underfloor Mounting Box	1
5	Inlet Elbow	2
6	Handshower	1
7	Check Valve	1
8	Flow Regulator	1
9	Shower Hose	1
10	Instruction Manual	1
11	Fixing Kit	1

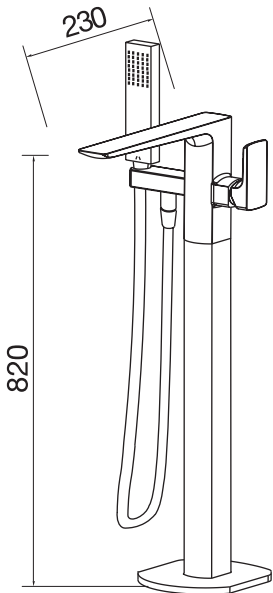
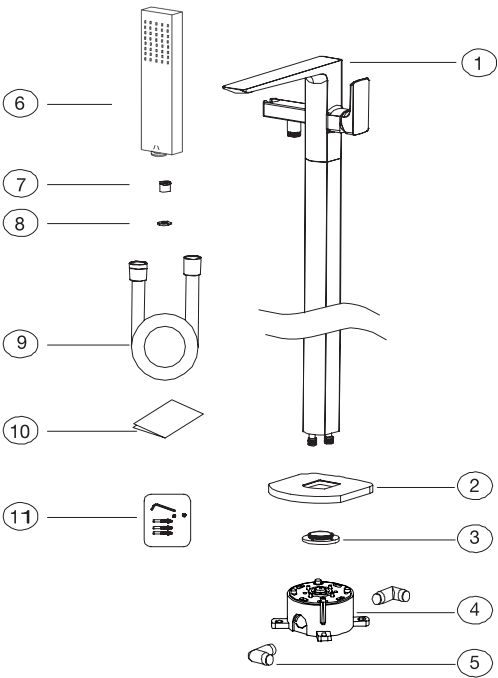

Prior to installation remove all parts from the packaging and inspect for any transport damage.

⚠ IMPORTANT!

The Underfloor Mounting Box must be recessed into the floor and levelled (using the spirit level provided) as shown.

⚠ Mounting Box must be installed atleast 5mm below the finished floor level.

Underfloor Mounting Box

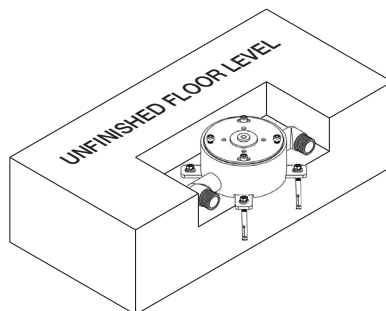
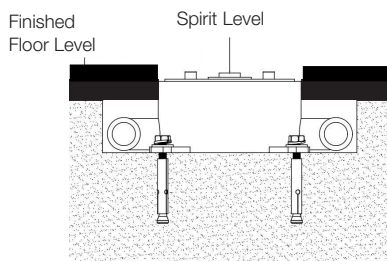

- 1 Drill the holes for mounting the Underfloor Mounting Box

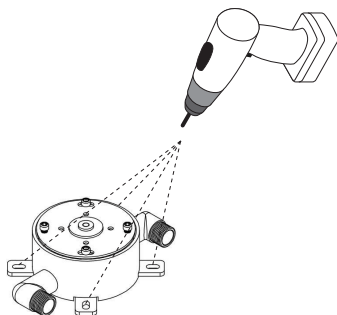

- 2 Install the inlet elbows provided and screw them into the Underfloor Mounting Box.

Set the Underfloor Mounting Box into the recess in the floor and level using the spirit level provided.

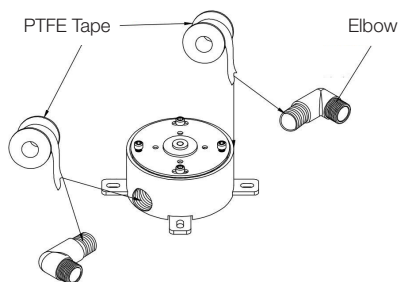

INSTALLATION INSTRUCTIONS

- 3 Fix the Underfloor Mounting Box to the floor with sleeve anchor bolts provided.



IMPORTANT!

Ensure it is fastened securely

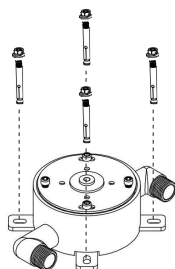

- 4 Connect the hot & cold inlet pipes to the inlet elbows.

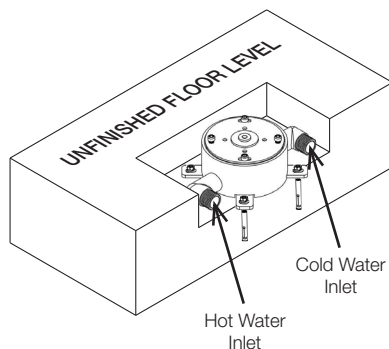

- 5 Complete the finished floor surface up to the edge of the Underfloor Mounting Box, ensuring that the Underfloor Mounting Box is at least 5mm below the finished floor level.

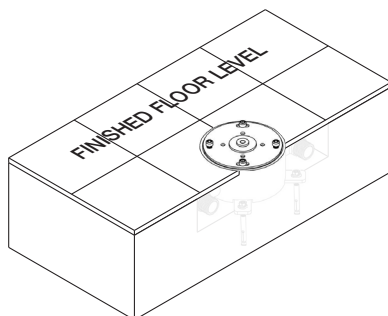

- 6 Remove the fixing plate, spirit level and blank cover caps.

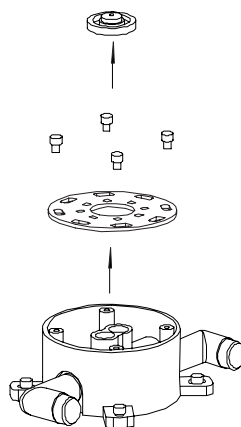

INSTALLATION INSTRUCTIONS

progetto

- 7 Slide the flange over the bottom part of the mixer body and attached the mounting plate to the underside of the mixer body.

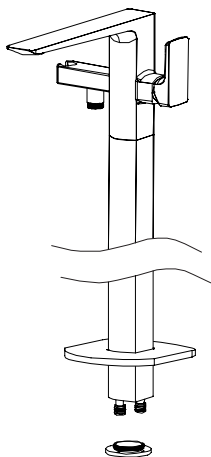

- 8 Fit the fixing plate onto the mounting plate (already attached to the Mixer Body in step 1).

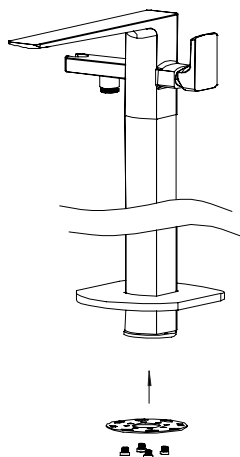

- 9 Align the copper pipes with the relevant hot & cold connector holes on the Underfloor Mounting Box. Fasten the fixing plate to the Underfloor Mounting Box.

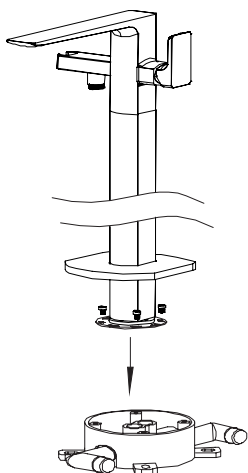

- 10 Fit the hose and handshower.

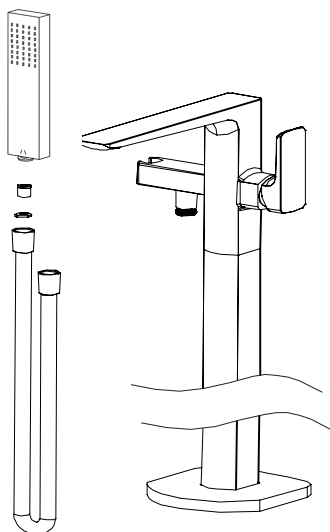

Handshower On

Pull down on the outer sleeve and turn to lock.

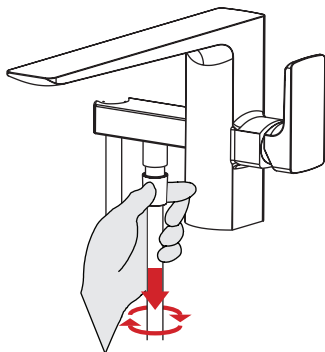

Handshower Off

Turn sleeve and release, diverter will also return to the original position when the mixer is closed.

