

Tondo 1680 Oval Inset Bath

Code: TON1680IN

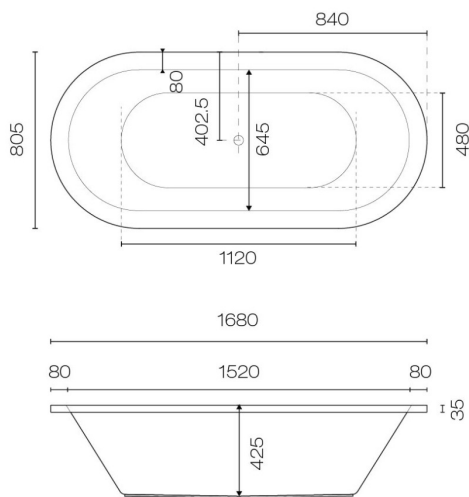

Brand	Progetto
Colour	White
Finish	Gloss
Material	Acrylic
Installation	Inset
Width (mm)	1680
Depth (mm)	800
Height (mm)	425
Warranty	10 Year
Overflow	No
Waste Size	40mm
Waste Included	No
Capacity	260L
Material	Acrylic
Notes	Made from sanitary grade acrylic
Other Information	Require waste

Note to the owner/user This product is made from a durable & robust material that will give you years of use. However please note the following to avoid damage to your product:

- After each use thoroughly clean the surface with warm soapy water.
- Before applying cleaning products to the surface carefully read all instructions first.
- Do not use products that contain alcohol, bleach, solvents, bath oils/salts, hair dye, abrasives, acetone or citrus based chemicals.
- Do not allow water temperature to exceed above 55°C.

Scan to View
Product Online



Tondo 1680 Oval Inset Bath

Code: TON1680IN

Building Product Information Requirements (BPIR)

Manufacturer	Plumblineline
Building Code Clauses	B2 (Durability) B2.3.1 (c) / G13 (Foul Water) G13.3.1
Compliance Evidence	Clauses relating to this product are aimed at the installer. Please find comprehensive installation instructions on the product information page. The product is designed to enable the installer to comply with the building code. The product complies with the clause B2 (Durability) B2.3.1.
Condition of Use	For use in residential and commercial applications. Must be installed by a registered plumber or suitably qualified tradesperson and as per the installation instructions.
Version no.	1.0
Subject to a Warning	No

Scan to View
Product Online

