

Flute Oval Vessel Basin

Code: FL50

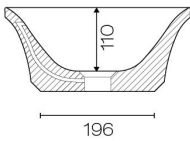
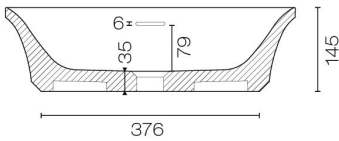
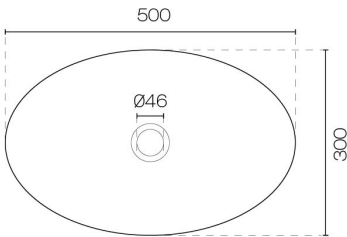

Brand	Claybrook
Material	Marbleform
Installation	Bench Mount
Width (mm)	500
Depth (mm)	320
Height (mm)	145
Warranty	10 Years
Overflow	Yes
Waste Size	32mm
Waste Included	No
Material	Marbleform
Approx Lead Time	10-12 weeks may apply for some colours. Please enquire for accurate leadtime.
Other Information	Made from Marbleform, a high performance stone compound. Manufacturing process includes 3 days of manual sanding and hand finishing. Soft touch and feel, non porous, repairable and easy to clean.

Scan to View  
Product Online



Flute Oval Vessel Basin

Code: FL50

Building Product Information Requirements (BPIR)

Manufacturer	Plumblineline
Building Code Clauses	B2 (Durability) B2.3.1 (c) / G13 (Foul Water) G13.3.1
Compliance Evidence	Clauses relating to this product are aimed at the installer. Please find comprehensive installation instructions on the product information page. The product is designed to enable the installer to comply with the building code. The product complies with the clause B2 (Durability) B2.3.1 (c).
Condition of Use	For use in residential and commercial applications. Must be installed by a registered plumber or suitably qualified tradesperson and as per the installation instructions.
Version no.	1.0
Subject to a Warning	No

Scan to View  
Product Online

