



Super-Thin Ellipse Round Undermount Basin

Code: ST3497UM

Brand	Progetto
Colour	White
Finish	Matt
Material	Solid Surface
Installation	Undermount
Height (mm)	125
Diameter (mm)	400
Warranty	10 Years
Overflow	No
Waste Size	32mm
Waste Included	No
Material	Solid Surface
Notes	Includes Super-Thin Undermount bracket kit (4x Brackets)
Other Information	Matching Solid Surface waste available (Code: 900068.73.SS)

**Cleaning and Maintenance** For every-day cleaning simply wipe down with a soft wet cloth to remove any surface dirt. For tougher marks use the supplied White Magic sponge with water, followed by a dry towel to dry the surface. To remove stubborn stains a small amount of Jif can be used, then wipe down again with the soft wet cloth and followed again by a dry towel to dry the surface. Never use Acetone, paint thinners or anything similar as these can damage the surface. Personal hygiene products will not damage the surface.

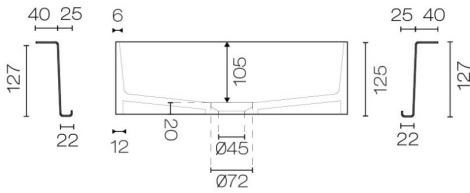
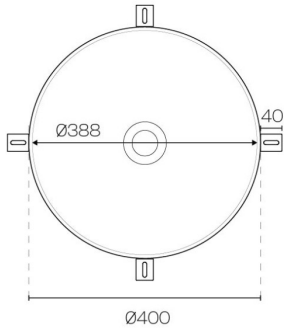

Super-Thin Ellipse Round Undermount Basin  
Code: ST3497UM

Building Product Information Requirements (BPIR)

Manufacturer	Plumblineline
Building Code Clauses	B2 (Durability) B2.3.1 (c) / G13 (Foul Water) G13.3.1
Compliance Evidence	Clauses relating to this product are aimed at the installer. Please find comprehensive installation instructions on the product information page. The product is designed to enable the installer to comply with the building code. The product complies with the clause B2 (Durability) B2.3.1 (c).
Condition of Use	For use in residential and commercial applications. Must be installed by a registered plumber or suitably qualified tradesperson and as per the installation instructions.
Version no.	1.0
Subject to a Warning	No

Scan to View  
Product Online

